

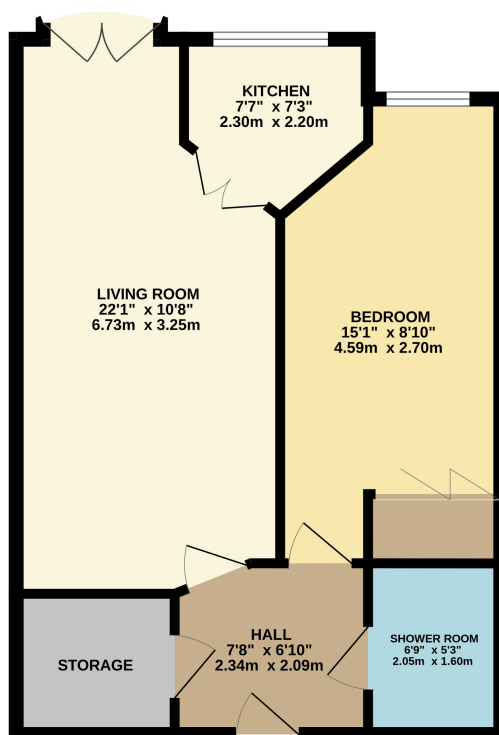

FLOOR LAYOUT

Not to Scale - For Identification Purposed Only

SECOND FLOOR
522 sq.ft. (48.5 sq.m.) approx.



TOTAL FLOOR AREA: 522 sq.ft. (48.5 sq.m.) approx.

Whilst every attempt has been made to ensure the accuracy of the floorplan contained here, measurements of doors, windows, floors and any other items are approximate and no responsibility is taken for any error, omission or mis-statement. This plan is for illustrative purposes only and should be used as such by any prospective purchaser. The services, systems and appliances shown have not been tested and no guarantee as to their operability or efficiency can be given.
Made with Metropix ©2023

www.edwardmellor.co.uk

182, London Road, SK7 4DQ
T: 0161 456 6000
E: hazelgrove@edwardmellor.co.uk



The agent has not tested apparatus, equipment, fittings or services and so cannot verify they are in working order or fit for their purpose. The buyer is advised to obtain verification from their Solicitor or Surveyor. Photographs are reproduced for general information and it must not be inferred that any item is included for sale with the property. Please note that all measurements are approximate. These particulars are issued on the understanding that any negotiations in regard to this property are carried out through Edward Mellor Ltd. This property is offered subject to not being sold or withdrawn on receipt of reply. These particulars are believed to be correct but do not form a contract for sale. None of the statements contained in these particulars as to this property are to be relied on as statements or representations of fact. The vendor does not make or give, and neither Edward Mellor Ltd. nor any person in their employment has any authority to make or give, any representation or warranty in relation to this property.



Features

- Stunning Upper Floor Retirement Apartment
- Delightful Elevated Views
- Superbly Refitted Kitchen & Shower Room
- No Onward Chain
- Living Room With Juliet Balcony

Retirement apartment living at its very finest and with stunning panoramic views. If you are looking for a "turn key" retirement apartment in the heart of Hazel Grove, look no further. This beautifully appointed upper floor flat is being offered For Sale with no onward chain and is perhaps the "exception to

the norm" given its show home condition which features a recently refitted kitchen with integrated appliances and fabulous refitted 3 piece shower room. In addition, the apartment enjoys a much favoured position within the development with its Juliet balcony in the expansive living

room taking in far reaching over the adjacent fields and beyond. There is a generous size bedroom which comes complete with its own mirrored fronted wardrobes and makes this stunning apartment simply ready to move into. Viewing essential.



Woodgrove Court is a McCarthy & Stone development which lies in the very heart of Hazel Grove and is therefore within easy access of every day amenities. Designed for the over 60's, the complex provides the perfect surroundings for independent living whilst sharing a friendly, community atmosphere among its happy residents in the communal lounge area. The accommodation on offer briefly comprises : Communal entrance with security entry system and providing access to the residents lounge and to the upper floors via stairs and lift, private entrance hall with useful built in cupboard, fabulous size living room with Juliet balcony, refitted and integrated kitchen, double size and fitted bedroom and luxurious 3 piece shower room. The complex also provides residents parking and delightful communal gardens providing the perfect space for outdoor social gatherings.

