



Price

£1,500 PCM

Fees Apply



Available 21/06/24

Campion Avenue Herne
Bay CT6

Wards

Helping you move forwards



Main Features

- Open house viewings Friday
- Open-plan kitchen/dining area with double doors to the
- A separate living room to relax in at the front of the
- Secluded main bedroom has an en-suite shower room.
- Garage and parking for two cars

Accommodation

Master bedroom 6.44 x 4.21
En-Suite 2.25 x 1.24
Bedroom 2 4.26 x 2.82
Family Bathroom 2.13 x 2.11
Bedroom 3 3.60 x 2.11
Lounge 4.18 x 3.19
Kitchen/Dining Area 4.25 x 3.39



Deposit required is £1,730.77
Canterbury District - Council Tax Band Tax Band D

Renting a property is a big commitment and we recommend that you visit the local authority website and these websites which offer helpful information and advice about letting

www.gov.uk/government/publications/how-to-rent

www.gov.uk/private-renting

www.wardsofkent.co.uk/renting/tenancy-fees-individuals/

www.gov.uk/green-deal-energy-saving-measures

Call Herne Bay 01227 361740 ■ wardsofkent.co.uk

IMPORTANT INFORMATION: Please contact our Lettings Team who will confirm the total costs involved in renting this property. For clarification, we wish to inform the prospective tenant that we have prepared these details as a general guide. The agent has not carried out a detailed survey nor tested the services, appliances, or specific fittings (unless otherwise stated), and no warranty can be given as to their condition. All room measurements are taken at floor level. We strongly recommend that all the information which we provide about the property is verified by yourself and your advisers. The contents of this publication are © Wards, 2015. Wards is a trading name of Arun Estates Limited Registered in England No. 2597969

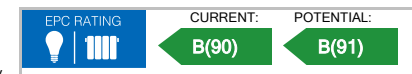

Ground Floor

Approx. 47.7 sq. metres (513.4 sq. feet)

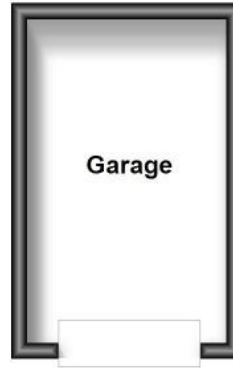
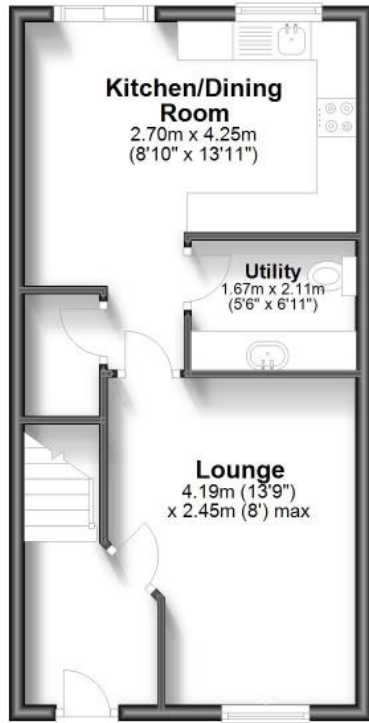

First Floor

Approx. 37.2 sq. metres (400.4 sq. feet)

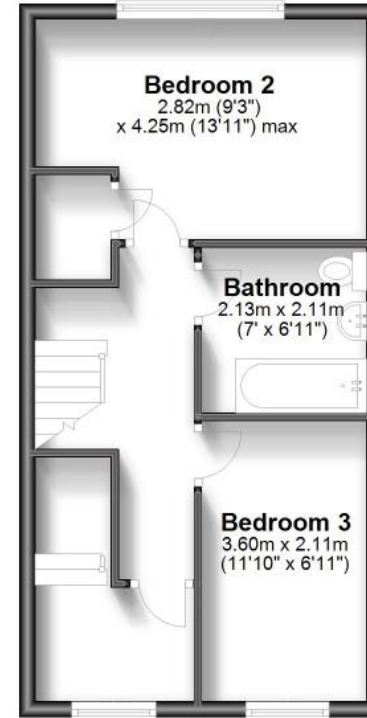

Second Floor

Approx. 26.7 sq. metres (286.9 sq. feet)



Total area: approx. 111.5 sq. metres (1200.7 sq. feet)