



Eccleston Mews, London SW1X 8AG

£3,200,000





## Eccleston Mews, London SW1X 8AG

**£3,200,000**

A charming Mews house which has been upgraded and modernised to a very high standard.

The property has a central patio area at both ground and first floor levels which gives a surprising and refreshing amount of light to all the rooms.

Eccleston Mews is a private Mews located on the North East side of Eaton square with parking permitted to the tenants of their properties. It is well positioned for all the excellent restaurants on Elizabeth street and Lower Belgrave street both of which are within easy walking distance as is Sloane square and Victoria station for the Tube trains.



## Description



## Situation



null

Council Tax Band: H

Available:

# Floor Plans

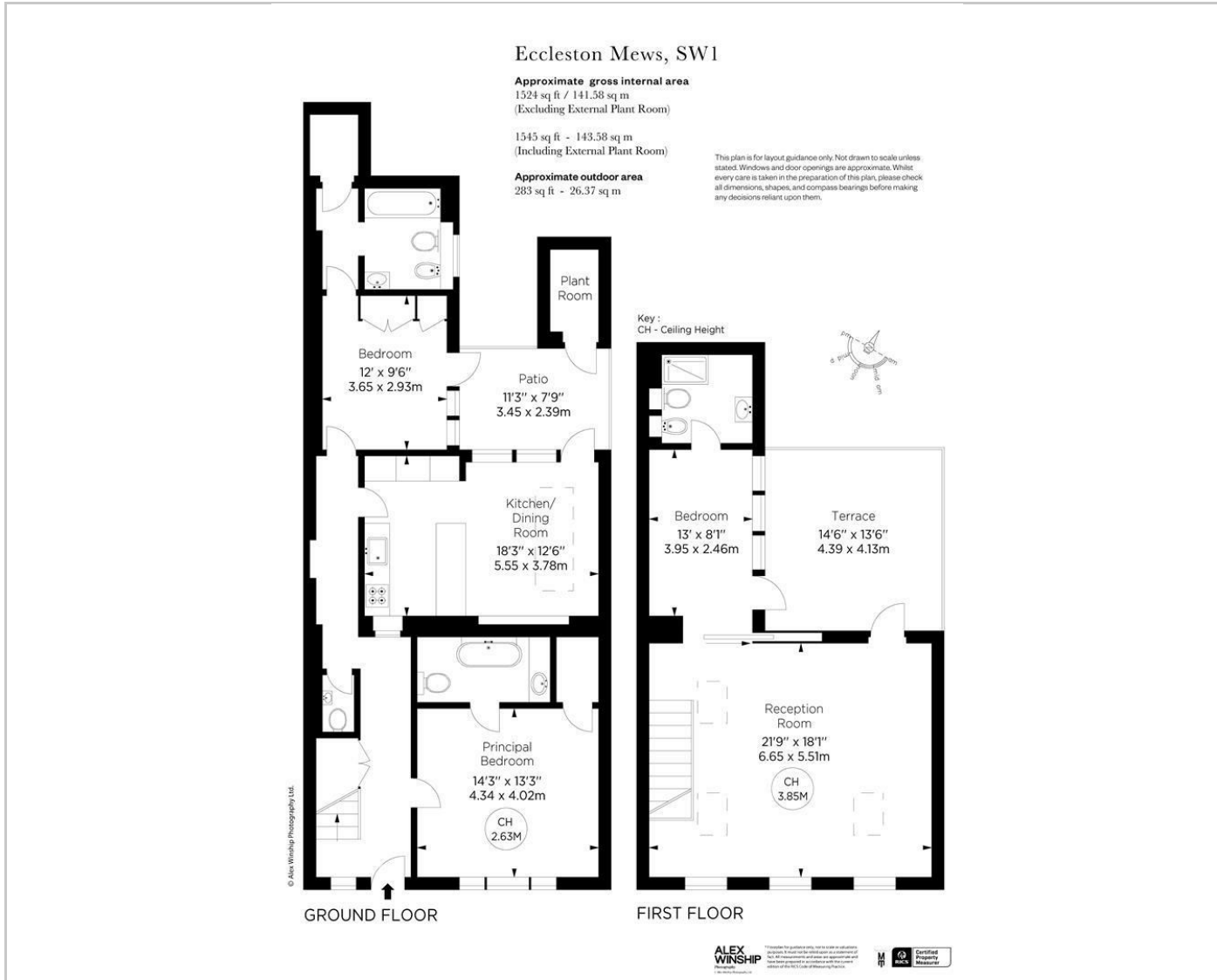

# Area Map

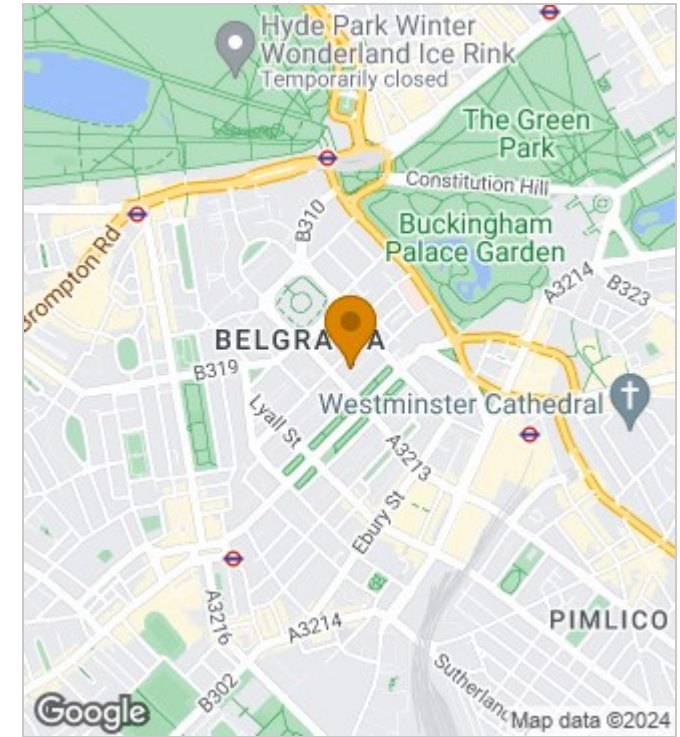

# Energy Performance Graph

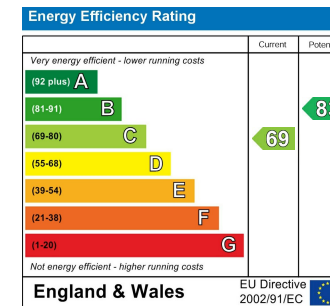

These particulars, whilst believed to be accurate are set out as a general outline only for guidance and do not constitute any part of an offer or contract. Intending purchasers should not rely on them as statements of representation of fact, but must satisfy themselves by inspection or otherwise as to their accuracy. No person in this firm's employment has the authority to make or give any representation or warranty in respect of the property.