



Coach Road Estate, NE37 2ET
3 Bed - House - Terraced
£109,995

ROBINSONS
SALES • LETTINGS • AUCTIONS • SURVEYS

Offered to the market is this very well presented home which should appeal to a wide variety of potential purchasers.

The floorplan comprises of: entrance hallway, attractive kitchen, a spacious lounge, and a useful utility room. On the first floor there are three bedrooms and a family bathroom.

Externally there are fenced gardens to the front and rear, the rear also providing car parking which is accessed via gates.

The property has good access to local schooling and major motoring links. Early viewing is A MUST on what should prove to be an exceptionally popular home.

this information, along with any further details concerning Material Information parts A, B & C, should be sought from a legal representative or appropriate authorities. Robinsons cannot accept liability for any information provided.

GROUND FLOOR

Hallway

Lounge

14'9" x 12'9" max (4.5 x 3.9 max)

Utility

10'2" x 5'2" max (3.1 x 1.6 max)

Kitchen

11'5" x 11'1" (3.5 x 3.4)

FIRST FLOOR

Landing

Bedroom

11'5" x 9'10" (3.5 x 3)

Bedroom

10'9" x 9'6" (3.3 x 2.9)

Bedroom

8'6" x 7'10" (2.6 x 2.4)

Bathroom

8'2" x 5'6" (2.5 x 1.7)

Agent's Notes

Electricity Supply: Mains

Water Supply: Mains

Sewerage: Mains

Heating: Gas Central Heating

Broadband: Basic 11 Mbps, Superfast 60 Mbps, Ultrafast 1,000 Mbps

Mobile Signal/Coverage: Good

Tenure: Freehold

Council Tax: Sunderland Council, Band A - Approx. £1,331 p.a

Energy Rating: D

Disclaimer: The preceding details have been sourced from the seller and OnTheMarket.com. Verification and clarification of



OUR SERVICES

Mortgage Advice

Conveyancing

Surveys and EPCs

Property Auctions

Lettings and Management

Strategic Marketing Plan

Dedicated Property Manager

Coach Road Estate

Approximate Gross Internal Area
883 sq ft - 82 sq m

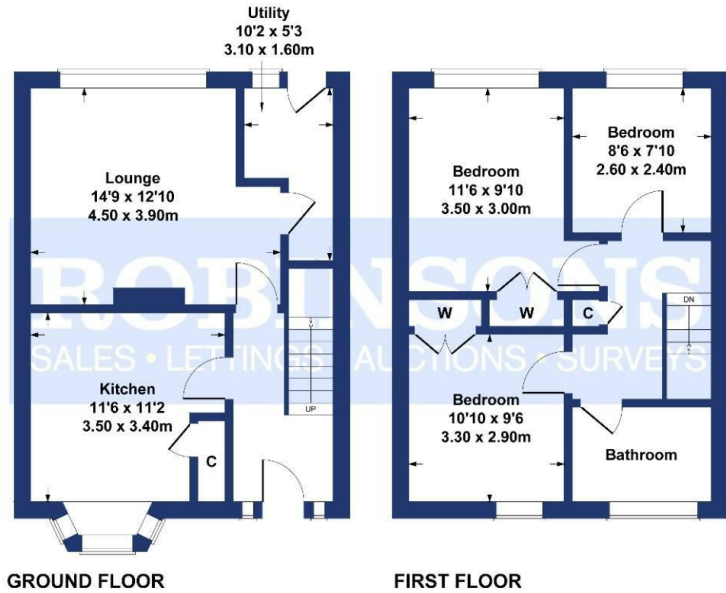

GROUND FLOOR

FIRST FLOOR

SKETCH PLAN FOR ILLUSTRATIVE PURPOSES ONLY

All measurements walls, doors, windows, fittings and appliances, their sizes and locations, are approximate only. They cannot be regarded as being a representation by the seller, nor their agent.

Produced by Potterplans Ltd. 2024

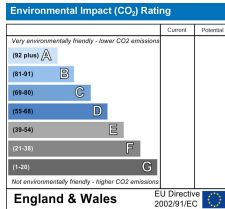
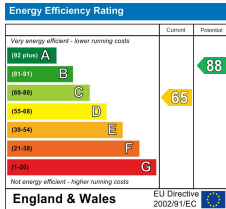

DURHAM

1-3 Old Elvet
DH1 3HL

T: 0191 386 2777 (Sales)

T: 0191 383 9994 (option1) (Lettings)

E: info@robinsonsdurham.co.uk

DURHAM REGIONAL HEAD OFFICE

19A old Elvet
DH1 3HL

T: 0191 383 0777

E: info@robinsonsdurham.co.uk

CHESTER-LE-STREET

45 Front Street
DH3 3BH

T: 0191 387 3000

E: info@robinsonscs.co.uk

BISHOP AUCKLAND

120 Newgate Street
DL14 7EH

T: 01388 458111

E: info@robinsonsbishop.co.uk

CROOK

Royal Corner
DL15 9UA

T: 01388 763477

E: info@robinsonscrook.co.uk

SPENNYMOOR

11 Cheapside
DH16 6QE

T: 01388 420444

E: info@robinsonsspennymoor.co.uk

SEDGEFIELD

3 High Street
TS21 2AU

T: 01740 621777

E: info@robinsonssedgefield.co.uk

Every care has been taken with the preparation of these particulars, but they are for general guidance only and complete accuracy cannot be guaranteed. If there is any point, which is of particular importance please ask or professional verification should be sought. All dimensions are approximate. The mention of fixtures, fittings &/or appliances does not imply they are in full efficient working order. Photographs are provided for general information and it cannot be inferred that any item shown is included in the sale. These particulars do not constitute a contract or part of a contract.

Robinsons can recommend financial services, surveying and conveyancing services to sellers and buyers. Robinsons staff may benefit from referral incentives relating to these services.



ROBINSONS

SALES • LETTINGS • AUCTIONS • SURVEYS

45 Front Street, Chester Le Street, DH3 3BH | Tel: 0191 387 3000 | info@robinsonscs.co.uk

www.robinsonsestateagents.co.uk