



This spacious three-bedroom detached bungalow, located in the sought-after Haughton & Springfield area of Darlington, offers a perfect blend of modern living and tranquility. Situated at the end of a quiet cul-de-sac, the property benefits from a high level of privacy, with no overlooking properties to the rear. Inside, the home features a contemporary fitted kitchen, ideal for family living and entertaining. The well-stocked gardens enhance the property's charm, providing a peaceful outdoor space. Off-street parking is available for more than one vehicle, with the added convenience of a garage. The bungalow is equipped with solar panels, contributing to energy efficiency and sustainability. With vacant possession, this property offers immediate availability, making it an excellent opportunity for those seeking a move-in ready home in a quiet, yet convenient location.

Council tax Band:
EPC Rating:

Colorado Grove, Darlington, DL1 2YW
3 Bedroom - Bungalow - Detached
£200,000
EPC Rating: B
Tenure: Freehold
Council Tax Band: C



**SMITH &
FRIENDS**
ESTATE AGENTS

Colorado Grove, Darlington, DL1 2YW

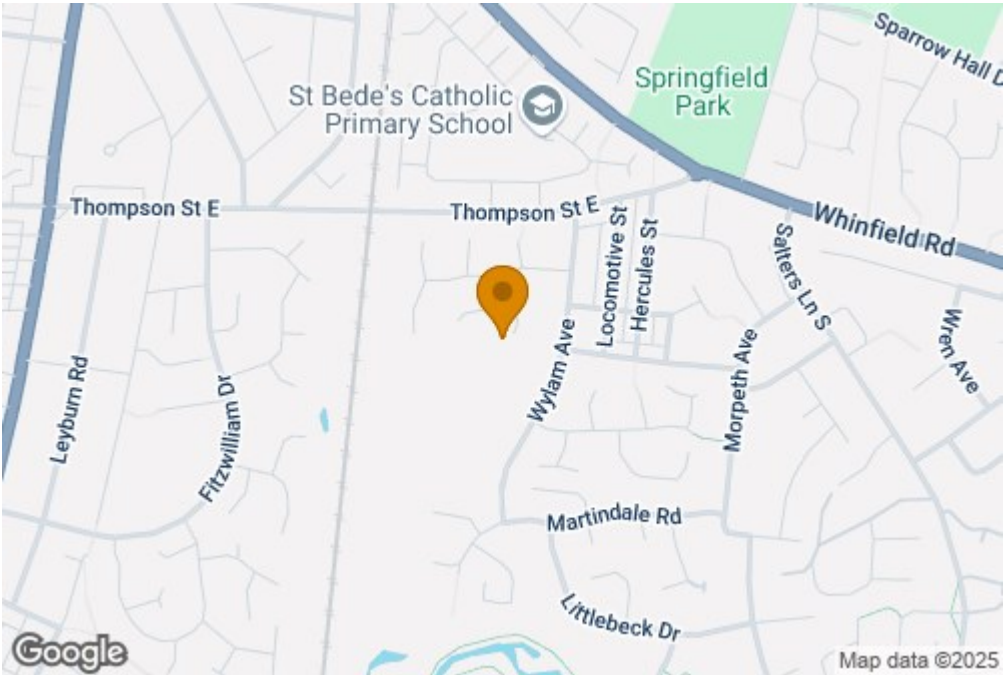
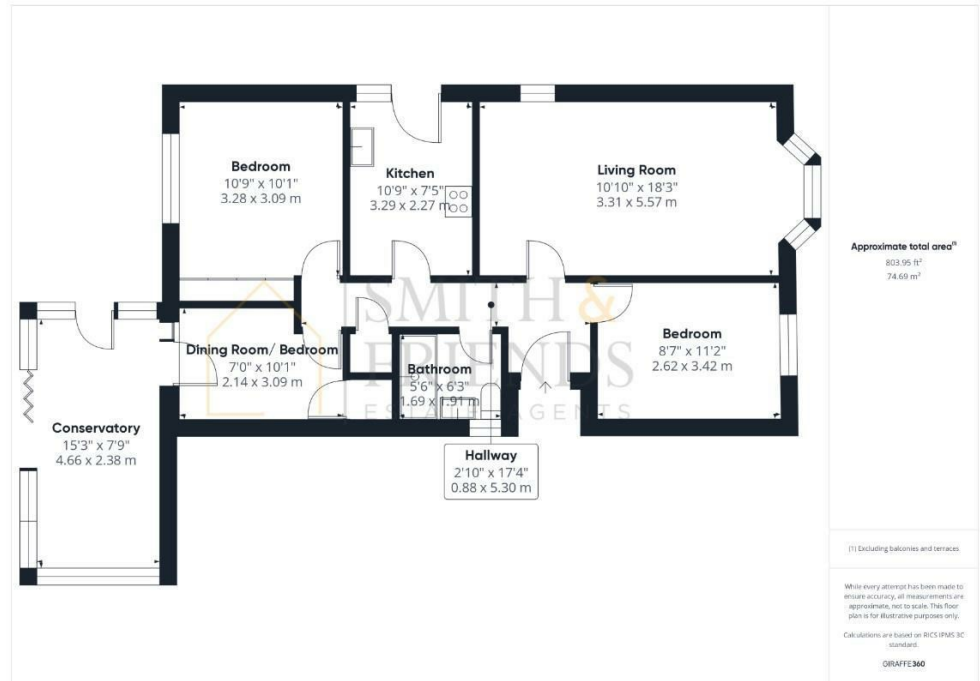

For clarification we wish to inform prospective purchasers that we have prepared these sales particulars as a general guide. We have not carried out a detailed survey, nor tested the services, appliances and specific fittings. Room sizes should not be relied upon for carpets and furnishings, if there are important matters which are likely to affect your decision to buy, please contact us before viewing the property. Smith & Friends can recommend financial services, surveying and conveyancing services to sellers and buyers. Smith & Friends staff may benefit from referral incentives relating to these services.

Energy Efficiency Rating		
	Current	Potential
Very energy efficient - lower running costs		
(92 plus) A	81	82
(81-91) B		
(69-80) C		
(55-68) D		
(39-54) E		
(21-38) F		
(1-20) G		
Not energy efficient - higher running costs		
England & Wales		EU Directive 2002/91/EC 