



Whinney Hill, Durham City, DH1 3BG
4 Bed - House - Semi-Detached
£450,000

ROBINSONS
SALES • LETTINGS • AUCTIONS • SURVEYS

STUDENT INVESTMENT OPPORTUNITY WITH FURTHER GROWTH ** JULY 2025/JUNE 2026 - £34,320pa excluding bills
 ** WELL PRESENTED & MAINTAINED ** CITY CENTRE LOCATION ** GOOD AMENITIES & TRANSPORT LINKS ** WALKING DISTANCE TO CITY CENTRE **

The floor plan comprises of entrance hallway, lounge/diner, bedroom, kitchen. To the first floor there are three bedrooms and shower room/wc. Externally there are enclosed front and rear gardens.

Whinney Hill is within walking distance to the city centre which has a wide range of shops, recreational facilities, bars, restaurant, theatre and cinema. There are also good motoring links nearby including the A1(M) highway providing access to major towns and cities in the North and South.

EPC rating D
 Council Tax Band C

GROUND FLOOR

Entrance Hall

Lounge/Diner

13'09 x 12'0 (4.19m x 3.66m)

Kitchen

10'01 x 10'10 (3.07m x 3.30m)

Bedroom

10'10 x 9'08 (3.30m x 2.95m)

FIRST FLOOR

Bedroom

11'06 x 12'03 (3.51m x 3.73m)

Bedroom

10'07 x 10'11 (3.23m x 3.33m)

Bedroom

8'09 x 7'11 (2.67m x 2.41m)

Shower Room/WC

8'10 x 7'05 (2.69m x 2.26m)

Agent Notes

Electricity Supply: Mains

Water Supply: Mains

Sewerage: Mains

Heating: Gas Central Heating

Broadband: Basic 14Mbps, Superfast 80Mbps, Ultrafast 10000Mbps

Mobile Signal/Coverage: Good to Average

Tenure: Freehold

Council Tax: Durham County Council, Band C - Approx. £2268p.a

Energy Rating: D

Disclaimer: The preceding details have been sourced from the seller and OnTheMarket.com. Verification and clarification of this information, along with any further details concerning Material Information parts A, B & C, should be sought from a legal representative or appropriate authorities. Robinsons cannot accept liability for any information provided.



OUR SERVICES

Mortgage Advice

Conveyancing

Surveys and EPCs

Property Auctions

Lettings and Management

Strategic Marketing Plan

Dedicated Property Manager

Whinney Hill

Approximate Gross Internal Area
945 sq ft - 88 sq m

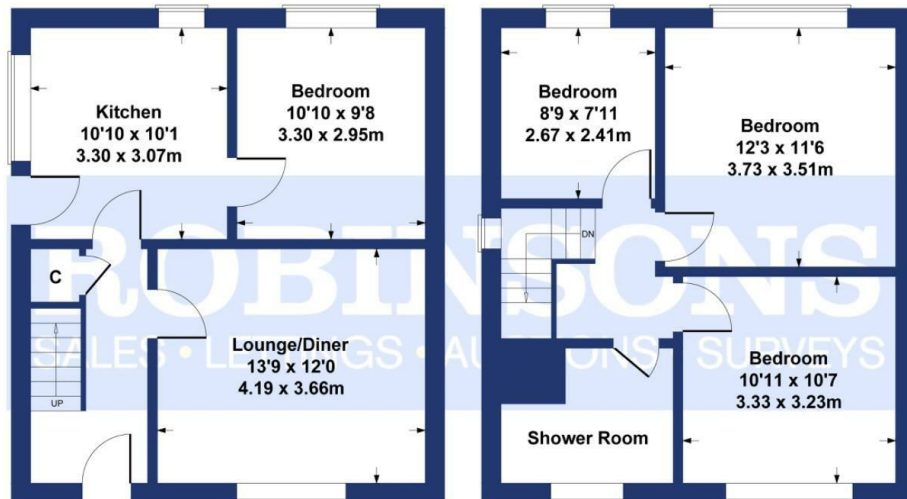

GROUND FLOOR

FIRST FLOOR

SKETCH PLAN FOR ILLUSTRATIVE PURPOSES ONLY

All measurements walls, doors, windows, fittings and appliances, their sizes and locations, are approximate only. They cannot be regarded as being a representation by the seller, nor their agent.

Produced by Potterplans Ltd. 2022

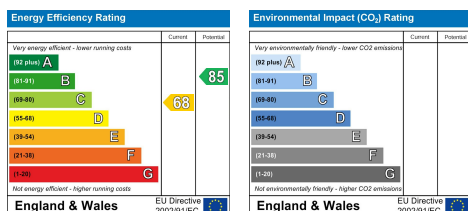

DURHAM

1-3 Old Elvet
DH1 3HL

T: 0191 386 2777 (Sales)

T: 0191 383 9994 (option1) (Lettings)

E: info@robinsonsdurham.co.uk

DURHAM REGIONAL HEAD OFFICE

19A old Elvet
DH1 3HL

T: 0191 383 0777

E: info@robinsonsdurham.co.uk

CHESTER-LE-STREET

45 Front Street
DH3 3BH

T: 0191 387 3000

E: info@robinsonscsls.co.uk

BISHOP AUCKLAND

120 Newgate Street
DL14 7EH

T: 01388 458111

E: info@robinsonsbishop.co.uk

CROOK

Royal Corner
DL15 9UA

T: 01388 763477

E: info@robinsonscrook.co.uk

SPENNYMOOR

11 Cheapside
DH16 6QE

T: 01388 420444

E: info@robinsonsspenny Moor.co.uk

SEDFIELD

3 High Street
TS21 2AU

T: 01740 621777

E: info@robinsonssedgefield.co.uk

WYNYARD

The Wynd
TS22 5QQ

T: 0174 064 5444

E: info@wynyardfineandcountry.co.uk

Every care has been taken with the preparation of these particulars, but they are for general guidance only and complete accuracy cannot be guaranteed. If there is any point, which is of particular importance please ask or professional verification should be sought. All dimensions are approximate. The mention of fixtures, fittings &/or appliances does not imply they are in full efficient working order. Photographs are provided for general information and it cannot be inferred that any item shown is included in the sale. These particulars do not constitute a contract or part of a contract.

Robinsons can recommend financial services, surveying and conveyancing services to sellers and buyers. Robinsons staff may benefit from referral incentives relating to these services.



ROBINSONS

SALES • LETTINGS • AUCTIONS

1 Old Elvet, Durham City, Durham, DH1 3HL | Tel: 0191 386 2777 | info@robinsonsdurham.co.uk

www.robinsonsestateagents.co.uk