



Grint Close, Coxhoe, DH6 4BW
3 Bed - House - Detached
O.I.R.O £215,000

ROBINSONS
SALES • LETTINGS • AUCTIONS • SURVEYS

Grint Close Coxhoe, DH6 4BW

Stunning Family or First Home ** Pleasant Tucked Away Position ** Popular Village Location ** Good Local Amenities & Road Links ** Rear Enclosed Garden ** Garage & Driveway ** Two Bathrooms ** Early Viewing Advised **

This detached, double-fronted home offers generous living space and occupies a pleasant position. Dual-aspect windows in several rooms make the property bright throughout. The welcoming hallway leads to a spacious living room with a bay window and under-stairs storage. The modern fitted kitchen features a selection of integrated appliances, space for a dining table, and French doors opening to the rear garden. There is also a convenient cloak/WC.

Upstairs, the main bedroom is a large double with an en-suite shower room and built-in storage. The second bedroom has dual-aspect windows, while the third is a good-sized single. The main bathroom includes a WC, hand basin, and bath. Outside, there is a garage, driveway, and ample visitor parking. The rear garden is enclosed with patio area.

Occupying a pleasant position, Grint Close lies on the outskirts of Coxhoe village, and offers a harmonious blend of rural charm and modern comforts, just 5 miles south of Durham city centre. Its serene landscapes and tight-knit community attract those seeking a slower pace of life without sacrificing urban amenities. Despite its rustic feel, Coxhoe boasts excellent road connectivity via the A177 and A688, making commuting easy. Despite its size, the village provides essential amenities, enhancing residents' quality of life. In essence, Coxhoe offers an enchanting lifestyle, blending tranquillity with convenience, appealing to a diverse range of prospective residents.











GROUND FLOOR

Hallway

WC

Lounge

14'7 x 12'11 (4.45m x 3.94m)

Kitchen Diner

14'6 x 10'2 (4.42m x 3.10m)

FIRST FLOOR

Bedroom

10'6 x 9'0 (3.20m x 2.74m)

En-Suite

8'3 x 4'6 (2.51m x 1.37m)

Bedroom

11'4 x 7'10 (3.45m x 2.39m)

Bedroom

8'1 x 5'9 (2.46m x 1.75m)

Bathroom/WC

7'3 x 5'0 (2.21m x 1.52m)

Agent Notes

Electricity Supply: Mains

Water Supply: Mains

Sewerage: Mains

Heating: Gas Central Heating

Broadband: Basic 16Mbps, Superfast 80Mbps, Ultrafast 9000Mbps

Mobile Signal/Coverage: Good to Average

Tenure: Freehold

Council Tax: Durham County Council, Band D - Approx. £2431 p.a

Energy Rating: B

Estate Management Charge: Approx £125pa

Disclaimer: The preceding details have been sourced from the seller and OnTheMarket.com. Verification and clarification of this information, along with any further details concerning Material Information parts A, B & C, should be sought from a legal representative or appropriate authorities. Robinsons cannot accept liability for any information provided.

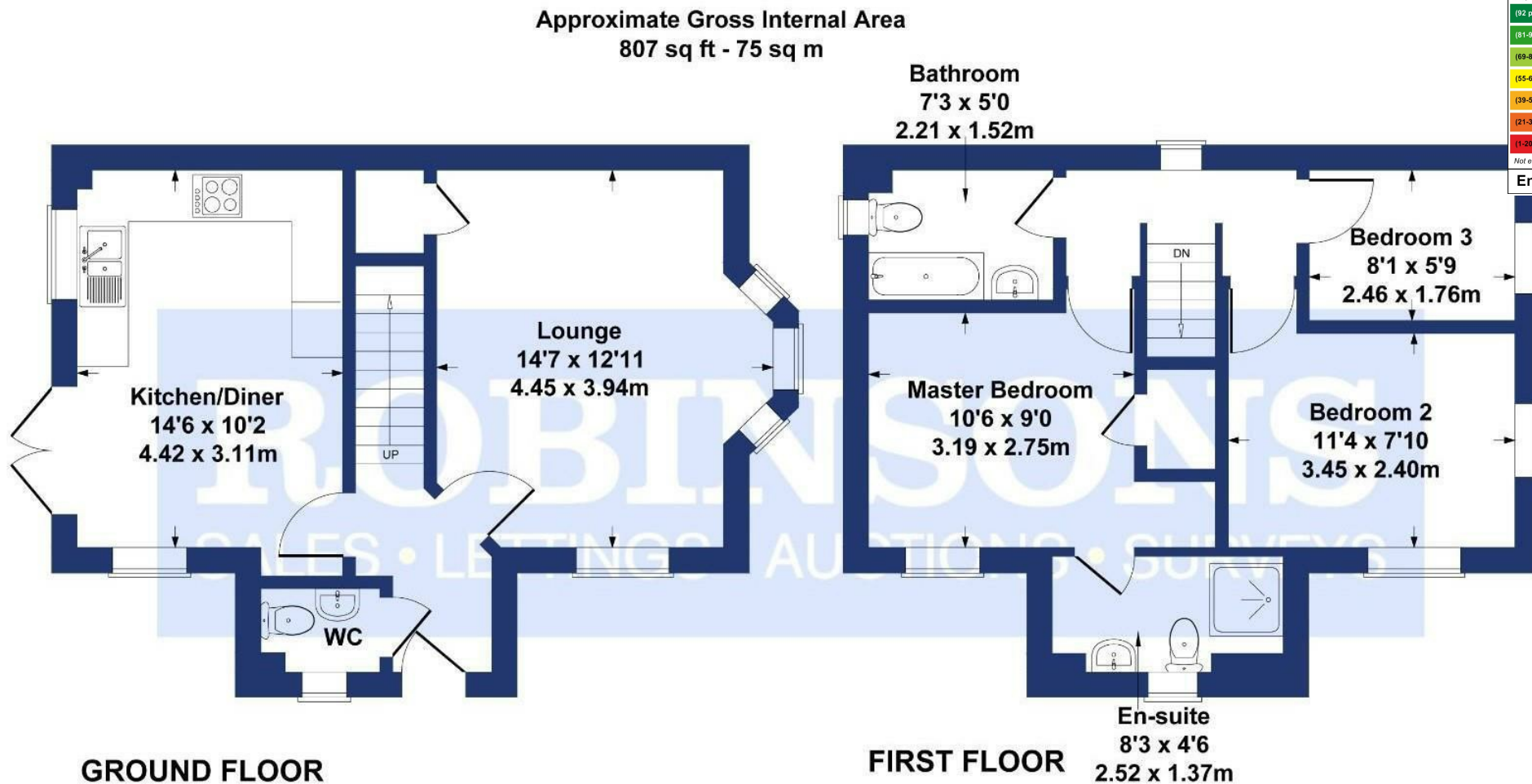

Energy Efficiency Rating		
	Current	Potential
Very energy efficient - lower running costs		
(92 plus) A		94
(81-91) B	82	
(69-80) C		
(55-68) D		
(39-54) E		
(21-38) F		
(1-20) G		
Not energy efficient - higher running costs		
England & Wales		EU Directive 2002/91/EC

SKETCH PLAN FOR ILLUSTRATIVE PURPOSES ONLY

All measurements walls, doors, windows, fittings and appliances, their sizes and locations, are approximate only. They cannot be regarded as being a representation by the seller, nor their agent.

Produced by Potterplans Ltd. 2024

For clarification we wish to inform prospective purchasers that we have prepared these sales particulars as a general guide. We have not carried out a detailed survey, nor tested the services, appliances and specific fittings. Room sizes should not be relied upon for carpets and furnishings, if there are important matters which are likely to affect your decision to buy, please contact us before viewing the property. Robinsons can recommend financial services, surveying and conveyancing services to sellers and buyers. Robinsons staff may benefit from referral incentives relating to these services.



1 Old Elvet, Durham City, Durham, DH1 3HL
Tel: 0191 386 2777
info@robinsonsdurham.co.uk
www.robinsonsestateagents.co.uk

