

**Salvin Terrace, Fishburn, TS21 4AG**  
**3 Bed - House - Mid Terrace**  
**£69,950**

**ROBINSONS**  
SALES • LETTINGS • AUCTIONS • SURVEYS

We are thrilled to offer to the market with no onward chain this deceptively spacious three bedroom terraced house situated on Salvin Terrace within the popular residential area of Fishburn. This is the ideal opportunity for the young family/first time buyers or buy-to-let investors to acquire this well proportioned home which benefits from gas central heating & double glazing throughout. Having easy access to all of the local amenities within the immediate area, the property is within a short drive to the neighbouring village of Sedgefield & has excellent links to all major road links leading to Durham City, Darlington & Teesside. The property itself briefly comprises: Welcoming entrance lobby with stairs to the first floor, spacious lounge with window to front elevation, kitchen/dining area with a range of fitted wall & base units & access into a useful lobby/utility area with further access to rear. The first floor landing boasts three sized bedrooms (two of which are double) & a family bathroom with three piece suite. Externally, there is a good sized garden to the front, whilst a maintainable enclosed yard lies to the rear with decking. Thorough internal inspection is essential in order to fully appreciate the style, layout & size of this well proportioned property for sale.

FREEHOLD  
EPC Rating: TBC  
Council Tax Band: A

#### **ENTRANCE HALLWAY**

**LOUNGE**  
14'11 x 13'4 (4.55m x 4.06m)

**KITCHEN/DINING AREA**  
15'3 x 8'6 (4.65m x 2.59m)

**UTILITY ROOM**  
5'8 x 4'11 (1.73m x 1.50m)

#### **FIRST FLOOR LANDING**

**MASTER BEDROOM**  
13'7 x 10'0 (4.14m x 3.05m)

**BEDROOM TWO**  
10'0 x 10'0 (3.05m x 3.05m)

**BEDROOM THREE**  
9'10 x 6'11 (3.00m x 2.11m)

**BATHROOM**  
6'10 x 5'11 (2.08m x 1.80m)

#### **EXTERNALLY**



# OUR SERVICES

Mortgage Advice

Conveyancing

Surveys and EPCs

Property Auctions

Lettings and Management

Strategic Marketing Plan

Dedicated Property Manager

## Salvin Terrace, Fishburn

Approximate Gross Internal Area  
786 sq ft - 73 sq m

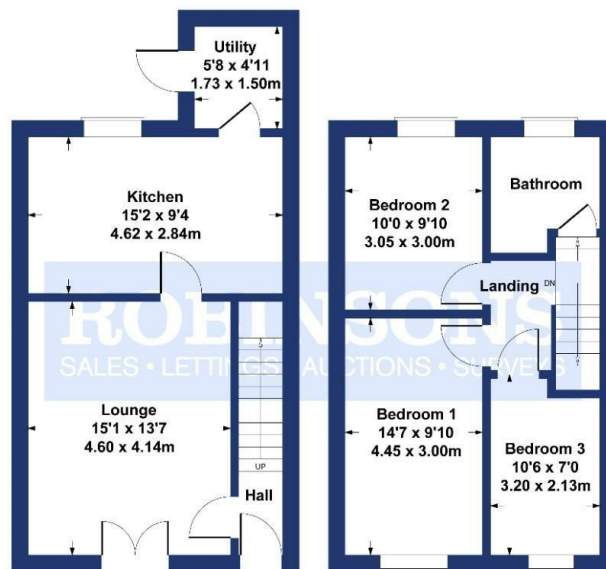

GROUND FLOOR

FIRST FLOOR

### SKETCH PLAN FOR ILLUSTRATIVE PURPOSES ONLY

All measurements walls, doors, windows, fittings and appliances, their sizes and locations, are approximate only. They cannot be regarded as being a representation by the seller, nor their agent.

Produced by Potterplans Ltd. 2025

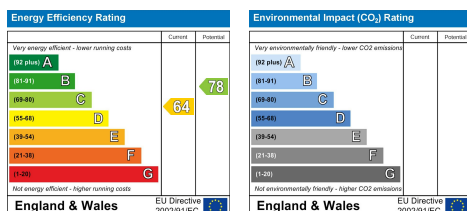

### DURHAM

1-3 Old Elvet  
DH1 3HL

T: 0191 386 2777 (Sales)

T: 0191 383 9994 (option1) (Lettings)

E: info@robinsonsdurham.co.uk

### DURHAM REGIONAL HEAD OFFICE

19A old Elvet  
DH1 3HL

T: 0191 383 0777

E: info@robinsonsdurham.co.uk

### CHESTER-LE-STREET

45 Front Street  
DH3 3BH

T: 0191 387 3000

E: info@robinsonscs.co.uk

### BISHOP AUCKLAND

120 Newgate Street  
DL14 7EH

T: 01388 458111

E: info@robinsonsbishop.co.uk

### CROOK

Royal Corner  
DL15 9UA

T: 01388 763477

E: info@robinsonscrook.co.uk

### SPENNYMOOR

11 Cheapside  
DH16 6QE

T: 01388 420444

E: info@robinsonsspenny Moor.co.uk

### SEDFIELD

3 High Street  
TS21 2AU

T: 01740 621777

E: info@robinsonssedgefield.co.uk

### WYNYARD

The Wynd  
TS22 5QQ

T: 0174 064 5444

E: info@wynyardfineandcountry.co.uk

Every care has been taken with the preparation of these particulars, but they are for general guidance only and complete accuracy cannot be guaranteed. If there is any point, which is of particular importance please ask or professional verification should be sought. All dimensions are approximate. The mention of fixtures, fittings &/or appliances does not imply they are in full efficient working order. Photographs are provided for general information and it cannot be inferred that any item shown is included in the sale. These particulars do not constitute a contract or part of a contract.

Robinsons can recommend financial services, surveying and conveyancing services to sellers and buyers. Robinsons staff may benefit from referral incentives relating to these services.



# ROBINSONS

SALES • LETTINGS • AUCTIONS

3 High Street, Sedgefield, TS21 2AU | Tel: 01740 621777 | info@robinsonssedgefield.co.uk

www.robinsonsestateagents.co.uk