



## 1 Mount Pleasant Middletown Welshpool Powys SY21 8DH **Monthly Rental Of £895.00**

**A spacious 3-bedroom semi-detached house in a pleasant village setting in an elevated position with glorious views towards Long Mountain. Accommodation provides Entrance Hall, Sitting Room, Dining Room, Kitchen, Walk-in Pantry, Rear Hall, Cloakroom/WC, Utility, 3 Good Bedrooms, Bathroom, OCH, DG, Double Width Drive, Garden, ZJ&B TENANT INFORMATION: Tenancies granted subject to contract following satisfactory credit, referencing and right to rent checks. 1 weeks holding fee applicable to successful applicants. Deposit: 5 weeks rent and first month's rent payable in advance. Rent EXCLUDES utilities and council tax. Tenancies granted on a 12 month Assured Shorthold Tenancy unless otherwise agreed. Smoking is prohibited in the Property and Pets are not considered unless otherwise stated.**



1 Mount Pleasant, Middletown, Welshpool, Powys, SY21 8DH



Entrance Hall  
Living Room 10' 3" x 14' 6" (3.12m x 4.42m)  
Sitting Room 10' 3" x 11' 2" (3.12m x 3.40m)  
Kitchen 6' 0" x 11' 6" (1.83m x 3.50m)  
Rear Hall  
Downstairs WC  
Utility Room 6' 0" x 7' 11" (1.83m x 2.41m)  
First Floor Landing  
Bedroom 1 26' 3" x 14' 8" (7.99m x 4.47m)  
Bedroom 2 9' 0" x 11' 2" (2.74m x 3.40m)  
Bedroom 3 7' 2" x 7' 8" (2.18m x 2.34m)  
Bathroom 6' 0" x 8' 8" (1.83m x 2.64m)  
Driveway  
Gardens

Council Tax Band C  
  
Monthly Rental Of £895.00  
per calendar month  
  
Deposit - £1,032.00  
5 weeks rent  
  
Minimum Term of 12 months

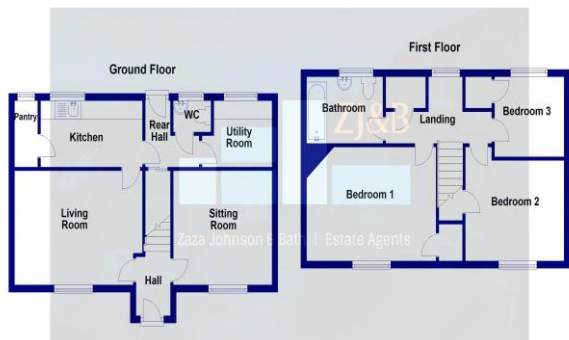

1 Mount Pleasant, Middletown

FLOOR PLANS FOR GUIDANCE ONLY