



## 27 Prestbury Green Harlescott Shrewsbury Shropshire

### Monthly Rental Of £950

**AVAILABLE MID AUGUST.** Well presented and generous 3 bedroom home. Property comprises; Hall, lounge, kitchen, dining room, wc, 3 good size bedrooms, garden , GCH, DG. **ZJ&B TENANT INFORMATION:** Tenancies granted subject to contract following satisfactory credit, referencing and right to rent checks. 1 weeks holding fee applicable to successful applicants. Deposit: 5 weeks rent and first month's rent payable in advance. Rent **EXCLUDES** utilities and council tax. Tenancies granted on a 12 month Assured Shorthold Tenancy unless otherwise agreed. Smoking is prohibited in the Property and Pets are not considered unless otherwise stated.



27 Prestbury Green, Harlescott, Shrewsbury, Shropshire, SY1 3JY



Entrance Hall  
Living Room 12' 3" x 14' 3" (3.73m x 4.34m)  
Kitchen 8' 9" x 9' 3" (2.66m x 2.82m)  
Dining Room 8' 3" x 9' 3" (2.51m x 2.82m)  
Utility Room 5' 11" x 9' 1" (1.80m x 2.77m)  
Bedroom 1 10' 5" x 11' 1" (3.17m x 3.38m)  
Bedroom 2 9' 0" x 9' 5" (2.74m x 2.87m)  
Bedroom 3 8' 0" x 7' 10" (2.44m x 2.39m)  
Bathroom

Council Tax Band A  
  
Monthly Rental Of £950  
per calendar month  
  
Deposit - £1,096.00  
5 weeks rent  
  
Minimum Term of 12 months

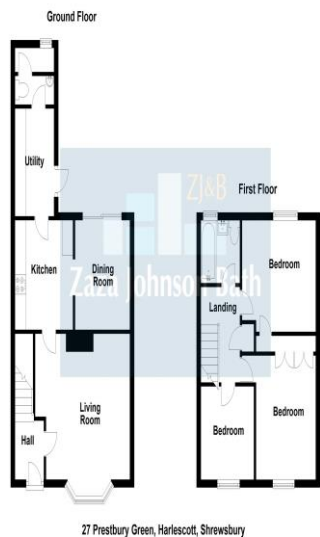

FLOOR PLANS FOR GUIDANCE ONLY

196112021

Energy performance certificate (EPC) - Find an energy certificate - GOV.UK

Energy performance certificate (EPC)

27, Prestbury Green  
Shrewsbury  
SY1 3JY

Energy rating

D

Valid until 6 August 2025

Certificate number  
6472-3533-6781-6005-6415

Property type  
Mid-terrace house

Total floor area  
63 square metres

Rules on letting this property

Properties can be rented if they have an energy rating from A to E.  
If the property is rated F or G, it cannot be let, unless an exemption has been registered. You can read [guidance for landlords on the minimum EPC rating rules and how to register an exemption](#) on the Energy Performance Certificate website.

Energy efficiency rating for this property  
This property's current energy rating is D. It has the potential to be B.  
[See how to improve this property's energy performance.](#)

<https://www.energy-certificates.digital.communities.gov.uk/energy-certificates/6472-3533-6781-6005-6415>

1/6