



**5 Rothley Drive
Bicton Heath Shrewsbury Shropshire SY3 5BB**

£525 per calendar month

Available from early January this well maintained 1 bedroom terrace with garden, and allocated parking,, property offers living room, kitchen bedroom, shower room, gas heating system, double glazing, sorry no pets, no smokers.

ZJ&B TENANT INFORMATION: Tenancies granted subject to contract following satisfactory credit and referencing checks. 1 weeks holding fee applicable to successful applicants. Deposit: 5 weeks rent and first month's rent payable in advance. Rent EXCLUDES utilities and council tax. Tenancies granted on a 12 month assured shorthold tenancy unless otherwise agreed.



5 Rothley Drive, Bicton Heath, Shrewsbury, Shropshire, SY3 5BB

Living Room 11' 11" x 11' 7" (3.63m x 3.54m)
Kitchen/Dining Room 11' 11" x 8' 6" (3.63m x 2.60m)
Bedroom 11' 11" x 15' 7" (3.63m x 4.76m)
Shower Room

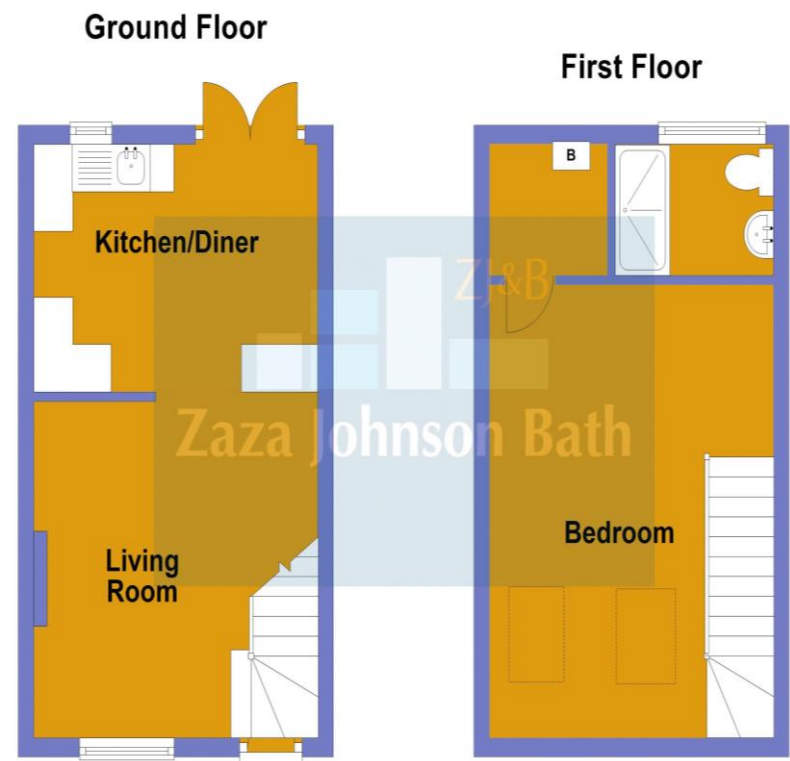

11/12/2020 Energy performance of buildings register

Energy performance certificate (EPC)

5, Rothley Drive
Bicton Heath
Shrewsbury
SY3 5BB

Energy rating
D

Valid until 12 September 2024

Certificate number
8754-7821-2790-3772-0995

Property type
Mid-terrace house

Total floor area
42 square metres

Rules on letting this property
Properties can be rented if they have an energy rating from A to E.
If the property is rated F or G, it cannot be let, unless an exemption has been registered. You can read [guidance for landlords on the regulations and exemptions](#) (<https://www.gov.uk/guidance/landlords-exemptions-to-the-energy-efficiency-regulations>).

Energy efficiency rating for this property
This property's current energy rating is D. It has the potential to be B.
[See how to improve this property's energy performance.](#)

<https://cid.energy-certificates.digital.communities.gov.uk/energy-certificates/8754-7821-2790-3772-0995>

1/7

5 Rothley Drive, Shrewsbury

FLOOR PLANS FOR GUIDANCE ONLY

