



91a High Street Wem Shrewsbury Shropshire

Monthly Rental Of £750

An impressive 2 bedroom apartment close to the heart of the town. The stylish, spacious accommodation which includes Entrance Hall, Generous Living Room, with walk in bay and spiral staircase to newly fitted Kitchen/Breakfast Room, 2 Bedrooms, Bathroom, Central Heating, Allocated Parking Space. ZJ&B TENANT INFORMATION: Tenancies granted subject to contract following satisfactory credit, referencing and right to rent checks. 1 weeks holding fee applicable to successful applicants. Deposit: 5 weeks rent and first month's rent payable in advance. Rent EXCLUDES utilities and council tax. Tenancies granted on a 12 month Assured Shorthold Tenancy unless otherwise agreed. Smoking is prohibited in the Property and Pets are not considered unless otherwise stated.



91a High Street, Wem, Shrewsbury, Shropshire, SY4 5DR



Accommodation includes:
Accommodation comprises
Entrance Hall
Impressive Living Room 16' 10" x 15' 0" (5.13m x 4.57m) excluding bay
Bedroom 2 12' 5" x 9' 5" (3.78m x 2.87m)
Bedroom 2 8' 10" x 8' 1" (2.69m x 2.46m)
Bathroom
Kitchen Breakfast Room 14' 7" x 12' 4" (4.44m x 3.76m)
Outside

Council Tax Band A

Monthly Rental Of £750 per calendar month

Deposit - £865.00
5 weeks rent

Minimum Term of 12 months

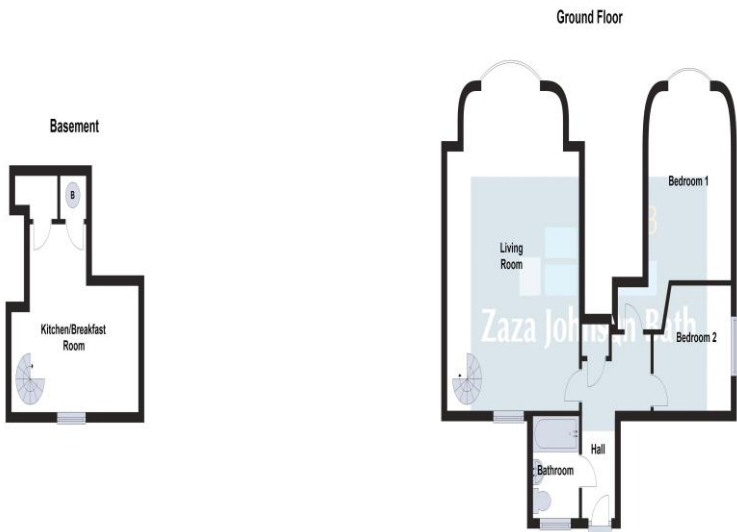

1/10/2021 - 10:42

Energy performance certificate (EPC) - Find an energy certificate - GOV.UK

Energy performance certificate (EPC)

| | | |
|--|---------------------------|----------------------------------|
| 91a, High Street Wem Shropshire SY4 5DR | Energy rating E | Valid until 10 September 2027 |
| Certificate number 0005-2510-6110-6003-1081 | | |

Property type
Basement flat

Total floor area
101 square metres

Rules on letting this property
Properties can be rented if they have an energy rating from A to E.
If the property is rated F or G, it cannot be let, unless an exemption has been registered. You can read [guidance for landlords on the exemption and exemption rules](#) here: [https://www.gov.uk/government/uploads/system/uploads/attachment_data/file/624666/landlord-exemption-rules.pdf](#)

Energy efficiency rating for this property
This property's current energy rating is E. It has the potential to be D.
[See how to improve this property's energy performance.](#)

How this energy certificate digital certificate.gov.uk/energy-certificates/0005-2510-6110-6003-1081

1/8

FLOOR PLANS FOR GUIDANCE ONLY

