



15 Compton Mews Ford Shrewsbury Shropshire

Monthly Rental Of £650

AVAILABLE END OF AUGUST. Located in the village of Ford to the west of Shrewsbury well maintained 1 bedroom house. Accommodation provides: Living Room, Modern Kitchen, Extremely Spacious Bedroom, Refitted Bathroom, Electric Heating, Double Glazing, Driveway and Garden.

ZJ&B TENANT INFORMATION: Tenancies granted subject to contract following satisfactory credit, referencing and right to rent checks. 1 weeks holding fee applicable to successful applicants. Deposit: 5 weeks rent and first month's rent payable in advance.

Rent **EXCLUDES** utilities and council tax. Tenancies granted on a 12 month Assured Shorthold Tenancy unless otherwise agreed.

Smoking is prohibited in the Property and Pets are not considered unless otherwise stated.



15 Compton Mews, Ford, Shrewsbury, Shropshire, SY5 9NX



Accommodation includes:
 Living Room 10' 8" x 13' 0" (3.25m x 3.96m)
 Kitchen 6' 6" x 13' 0" (1.98m x 3.96m)
 First Floor Landing 7' 1" x 6' 10" (2.16m x 2.08m)
 Bedroom 10' 3" x 10' 0" (3.12m x 3.05m)
 Bathroom 6' 10" x 5' 5" (2.08m x 1.65m)
 Front Garden and Parking Space
 Small Rear Garden

Council Tax Band A

Monthly Rental Of £650
 per calendar month

Deposit - £750.00
 5 weeks rent

Minimum Term of 12 months

Ground Floor



First Floor

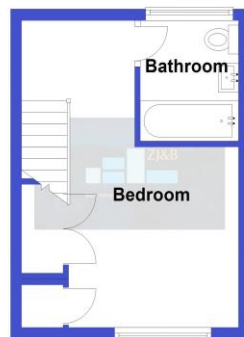

We accept no responsibility for any mistake or inaccuracy contained within the floorplan. The floorplan is provided as a guide only and should be taken as an illustration only. The measurements, contents and positioning are approximations only and provided as a guidance tool and not an exact replication of the property. Plan produced using PlanUp.
 Plan produced using PlanUp.

Energy performance certificate (EPC)

15 COMPTON MEWS FORD SHREWSBURY SY5 9NX	Energy rating C	Valid until 9 April 2031 Certificate number 6130-3831-9640-2190-8731
--	---------------------------	---

Property type
Mid-terrace house

Total floor area
42 Square metres

Rules on letting this property
 Properties can be let if they have an energy rating from A to E.
 You can read guidance for landlords on the regulations and exemptions [here](https://www.gov.uk/guidance/energy-ratings-for-landlords).

Energy efficiency rating for this property
 This property's current energy rating is C. It has the potential to be A.
[See how to improve this property's energy performance.](https://www.gov.uk/guidance/energy-ratings)

FLOOR PLANS FOR GUIDANCE ONLY