



45 Copthorne Park Copthorne Shrewsbury Shropshire

Monthly Rental Of £1,400

AVAILABLE NOW. Fully refurbished 3 bedroom semi detached in popular and convenient location offering stylish accommodation throughout including Entrance Hall, WC (Under Construction), Living Room, Kitchen/Dining Room with bi-fold doors, 3 Bedrooms, Bathroom, Separate WC, Garden, Driveway Parking.

ZJ&B TENANT INFORMATION: Tenancies granted subject to contract following satisfactory credit, referencing and right to rent checks. 1 weeks holding fee applicable to successful applicants. Deposit: 5 weeks rent and first month's rent payable in advance.

Rent EXCLUDES utilities and council tax. Tenancies granted on a 12 month Assured Shorthold Tenancy unless otherwise agreed.

Smoking is prohibited in the Property; Pets are not considered unless otherwise stated.



45 Copthorne Park, Copthorne, Shrewsbury, Shropshire, SY3 8TJ



Accommodation includes:

- Entrance Porch
- Entrance Hall
- Living Room 13' 0" x 11' 6" (3.96m x 3.50m)
- Dining Room 12' 0" x 10' 10" (3.65m x 3.30m)
- Kitchen
- First Floor Landing
- Bedroom 1 13' 0" x 11' 8" (3.96m x 3.55m)
- Bedroom 2 12' 0" x 10' 10" (3.65m x 3.30m)
- Bedroom 3 8' 10" x 8' 10" (2.69m x 2.69m)
- Bathroom
- Separate WC
- Driveway
- Rear Garden

Council Tax Band C

Monthly Rental Of £1,400 per calendar month

Deposit - £1,615.00
5 weeks rent

Minimum Term of 12 months

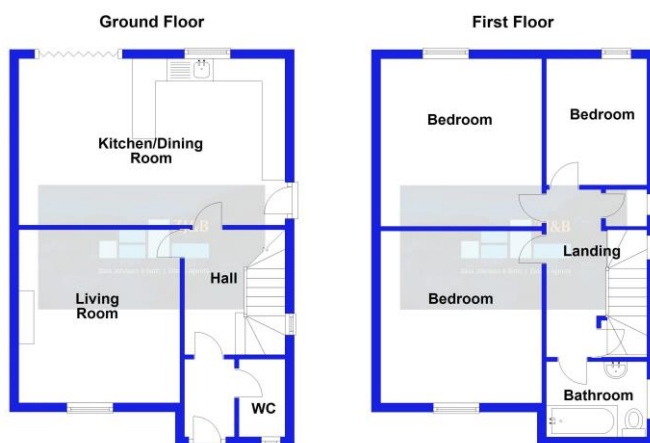

We accept no responsibility for any mistake or inaccuracy contained within the floorplan. The floorplan is provided as a guide only and should be taken as an illustration only. The measurements, contents and positioning are approximations only and provided as a guidance tool and not an exact replication of the property. Plan produced using PlanUp.
Plan produced using PlanUp.

Energy performance certificate (EPC)

45 Copthorne Park Copthorne Shropshire SY3 8TJ	Energy rating C	Valid until 19 January 2032 Certificate number 2037-4328-7160-8031-4332
---	---------------------------	---

Property type
Semi-detached house

Total floor area
93 Square metres

Rules on letting this property

Properties can be let if they have an energy rating from A to E.

You can read guidance for landlords on the regulations and exemptions [here](https://www.gov.uk/government/consultations/energy-efficiency-guidance-for-landlords).

Energy efficiency rating for this property

This property's current energy rating is C. It has the potential to be B.

[See how to improve this property's energy performance.](https://www.gov.uk/government/consultations/energy-efficiency-guidance-for-landlords)

FLOOR PLANS FOR GUIDANCE ONLY