

16, Tower Street,
Treforest,
CF37 1NR

3 Bed House - Terraced

£995 PCM



A very well presented three bedroom terrace property in the heart of Treforest. Recently decorated throughout. Offering good accommodation close to South Wales University including living room, large kitchen diner, utility area and bathroom to ground floor with three good sized bedrooms to the first floor. Enclosed rear garden. On road parking. Unfurnished with kitchen appliances. Gas central heating. Pontypridd within 2km / Train station very nearby. Council Tax band B. EPC rating C. Available December 2025 for minimum twelve month term.



3



1



1



C

£995 PCM

CONTACT

EMAIL

lettings@thomashwood.com

TELEPHONE

02920 626252

WEBSITE

Energy Efficiency Rating		
	Current	Potential
Very energy efficient - lower running costs		
(92 plus) A		87
(81-91) B		
(69-80) C		
(55-68) D		
(39-54) E		
(21-38) F		69
(1-20) G		
Not energy efficient - higher running costs		
England & Wales		
EU Directive 2002/91/EC		

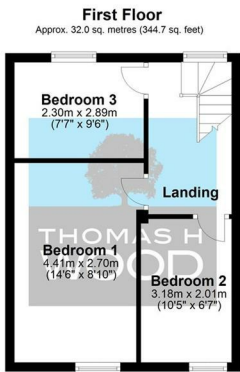
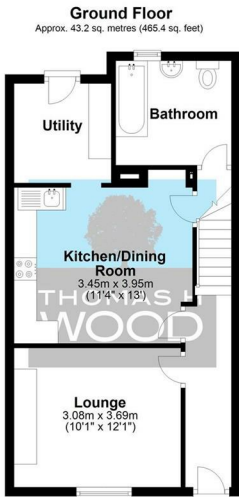

Total area: approx. 75.3 sq. metres (810.1 sq. feet)