



THOMAS H
WOOD

35, Goetre Fawr,
Radyr,
Cardiff,
CF15 8ET

2 Bed Flat - First Floor

£925 PCM



This is a super first floor apartment with two bedrooms and a fabulous open plan kitchen/living room on a modern development only 400m from Radyr village and train station. Tastefully appointed throughout and with ample off road parking, This stylish property is conveniently located for M4 access at Junction 32 and the Taff Trail. Gas central heating. Furnished. Available October 2024 for initial twelve month term.



£925 PCM

CONTACT

EMAIL

lettings@thomashwood.com

TELEPHONE

02920 626252

WEBSITE

Energy Efficiency Rating		
	Current	Potential
Very energy efficient - lower running costs		
(92 plus) A		
(81-91) B		
(69-80) C		
(55-68) D		
(39-54) E		
(21-38) F		
(1-20) G		
Not energy efficient - higher running costs		
England & Wales	EU Directive 2002/91/EC	

GROUND FLOOR
53.5 sq.m. (575 sq.ft.) approx.

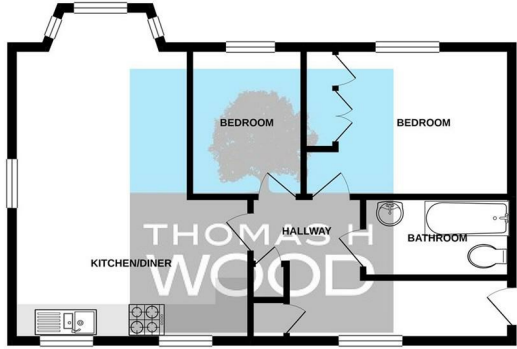

TOTAL FLOOR AREA: 53.5 sq.m. (575 sq.ft.) approx.
 *Energy efficiency class and running costs are approximate and do not represent an estimate of the actual energy consumption of the property. The energy efficiency class and running costs are based on the information provided in the Energy Performance Certificate (EPC) and are subject to change. The energy efficiency class and running costs are based on the information provided in the EPC and are subject to change. The energy efficiency class and running costs are based on the information provided in the EPC and are subject to change.