



## Room 1, 27 Chester Street, Chesterfield, S40 1DW

£550 Per Month

- House Share
- Shared Accommodation
- Fitted Kitchen
- Fully FURNISHED
- Popular Location
- X3 Bedrooms
- Bathroom
- Very Well Presented
- x2 with En Suite
- Rear Garden

# 27 Chester Street, Chesterfield S40 1DW

\*\*\*HOUSE SHARE\*\*\*Available NOW is this Well Presented 4 Bedroom Property, Perfect for sharing.

This Property is situated on the popular Brampton Area, Well Placed for Walking Distance of the Town Centre, Bus Routes and Local Amenities on the doorstep.

All Rooms are Part Furnished, ideal for single occupancy, also with a Shared Kitchen Diner with Appliances and Lounge, along with Patio to the Rear.

Viewing is Strongly Advised.

All Bills Inclusive and rent is from £500 to £530 pcm per room!

Sorry NO Pets or Smokers.

Working Applicants Preferred or Guarantor Required.



Council Tax Band: A



### **Lounge**

14'7" x 12'5"

### **Kitchen**

10'4" x 8'5"

### **Room 1**

14'9" x 13'9"

### **En Suite**

4'11" x 6'3"

### **Landing**

### **Room 2**

14'8" x 10'10"

### **En Suite**

### **Room 3**

11'1" x 10'1"

### **Room 4**

10'5" x 8'4"







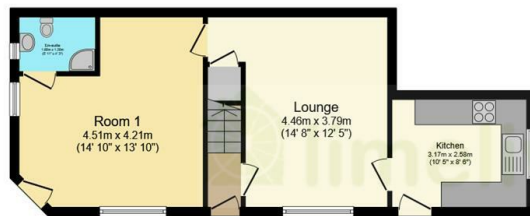

**Ground Floor**  
Floor area 47.7 sq.m. (514 sq.ft.)



**First Floor**  
Floor area 48.0 sq.m. (517 sq.ft.)

**Total floor area: 95.8 sq.m. (1,031 sq.ft.)**

This floor plan is for illustrative purposes only. It is not drawn to scale. Any measurements, floor areas (including any total floor area), openings and orientations are approximate. No details are guaranteed, they cannot be relied upon for any purpose and do not form any part of any agreement. No liability is taken for any error, omission or misstatement. A party must rely upon its own inspection(s). Powered by www.Propertybox.io

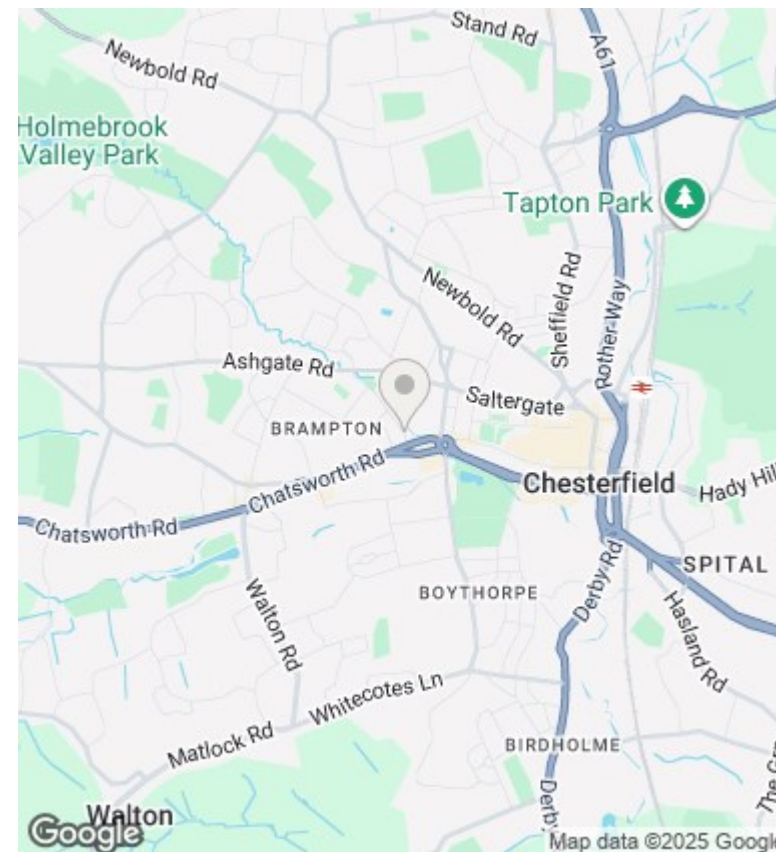

## Directions

## Viewings

Viewings by arrangement only. Call 01246 275 559 to make an appointment.

## Council Tax Band

A

Energy Efficiency Rating		Current	Potential
Very energy efficient - lower running costs			
(92 plus) <b>A</b>			<b>86</b>
(81-91) <b>B</b>			
(69-80) <b>C</b>			
(55-68) <b>D</b>		<b>58</b>	
(39-54) <b>E</b>			
(21-38) <b>F</b>			
(1-20) <b>G</b>			
Not energy efficient - higher running costs			
England & Wales		EU Directive 2002/91/EC	