



## 24 Grove Gardens, Chesterfield, S43 1QS

Offers Around £415,000

- Detached Family House
- Two Recep Rooms, Conservatory
- FOUR Bedrooms, x1 En Suite
- IDEAL Family Sized Home!
- Pleasant Cul De Sac Location
- Modern Fitted Kitchen, with Int Apps
- Family Bathroom
- Popular Residential Area
- Downstairs WC Room
- Corner Plot Gardens, x2 Garages



**Ground Floor**

Floor area 97.1 sq.m. (1,045 sq.ft.)

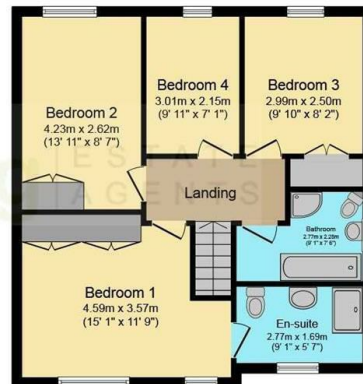

**First Floor**

Floor area 58.1 sq.m. (626 sq.ft.)

**TOTAL: 155.2 sq.m. (1,670 sq.ft.)**

This floor plan is for illustrative purposes only. It is not drawn to scale. Any measurements, floor areas (including any total floor area), openings and orientations are approximate. No details are guaranteed, they cannot be relied upon for any purpose and do not form any part of any agreement. No liability is taken for any error, omission or misstatement. A party must rely upon its own inspection(s). Powered by [www.Propertybox.io](http://www.Propertybox.io)



## Directions

## Viewings

Viewings by arrangement only. Call 01246 275 559 to make an appointment.

## Council Tax Band

D

## EPC Rating:

C

Energy Efficiency Rating		
	Current	Potential
Very energy efficient - lower running costs		
(92 plus) <b>A</b>		
(81-91) <b>B</b>		<b>81</b>
(69-80) <b>C</b>	<b>69</b>	
(55-68) <b>D</b>		
(39-54) <b>E</b>		
(21-38) <b>F</b>		
(1-20) <b>G</b>		
Not energy efficient - higher running costs		
<b>England &amp; Wales</b>	EU Directive 2002/91/EC	