

4 Whitting Mews, Holland Road, Chesterfield, Derbyshire, S41

£725 Per Month

- Town House
- Lounge
- Bathroom
- UNFURNISHED
- Popular Location
- Fitted Kitchen
- Enclosed Rear Garden
- Well Presented Throughout
- TWO Bedrooms
- Drive way

GROUND FLOOR
244 sq.ft. (22.6 sq.m.) approx.

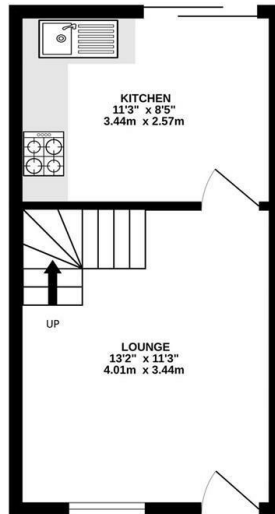

1ST FLOOR
244 sq.ft. (22.6 sq.m.) approx.

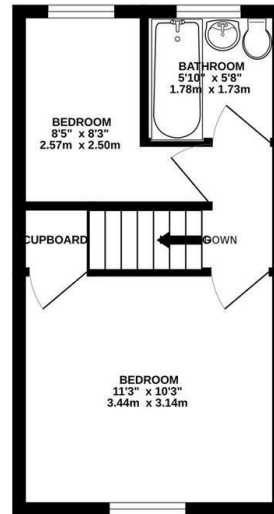

TOTAL FLOOR AREA: 487 sq.ft. (45.3 sq.m.) approx.

Whilst every attempt has been made to ensure the accuracy of the floorplan contained here, measurements of doors, windows, rooms and any other items are approximate and no responsibility is taken for any error, omission or mis-statement. This plan is for illustrative purposes only and should be used as such for any prospective purchase. The services, systems and appliances shown have not been tested and no guarantee as to their operability or efficiency can be given.
Made with Metropix ©2025

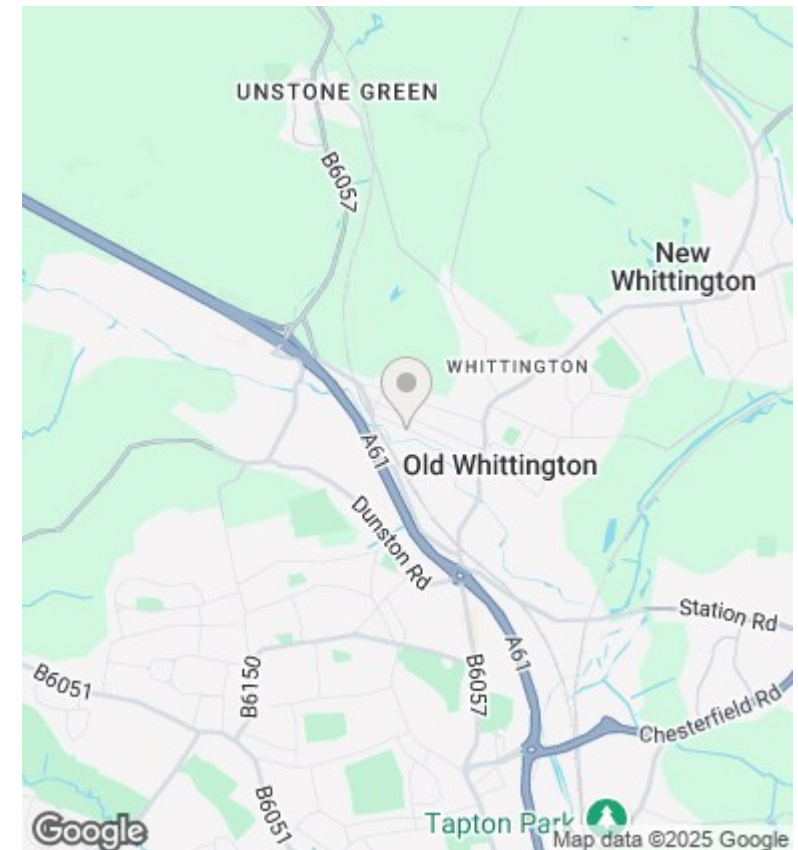

Directions

Viewings

Viewings by arrangement only. Call 01246 275 559 to make an appointment.

Council Tax Band

EPC Rating:

D

Energy Efficiency Rating		
	Current	Potential
Very energy efficient - lower running costs		
(92 plus) A		88
(81-91) B		
(69-80) C		66
(55-68) D		
(39-54) E		
(21-38) F		
(1-20) G		
Not energy efficient - higher running costs		
England & Wales		EU Directive 2002/91/EC