

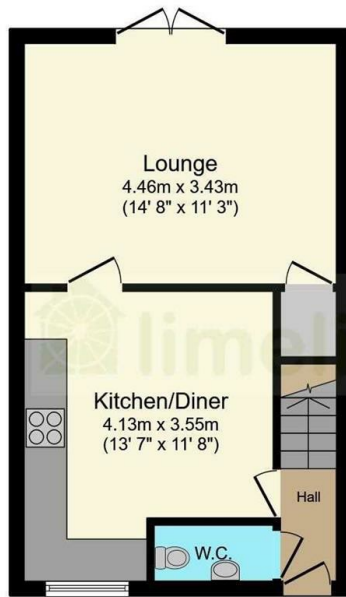

## 5 Chestnut Drive, Chesterfield, S43 2LZ

Asking Price £177,500

- Modern Town House
- Lounge
- THREE Bedrooms
- 50% Shared Ownership Option AVAILABLE - Rent £250.32 p/m (enquire for details)
- Popular Location
- Modern Kitchen Diner
- Bathroom
- Well Presented Throughout
- Downstairs WC Room
- Enclosed Rear garden + Allocated Parking



**Ground Floor**

Floor area 34.1 m<sup>2</sup> (367 sq.ft.)

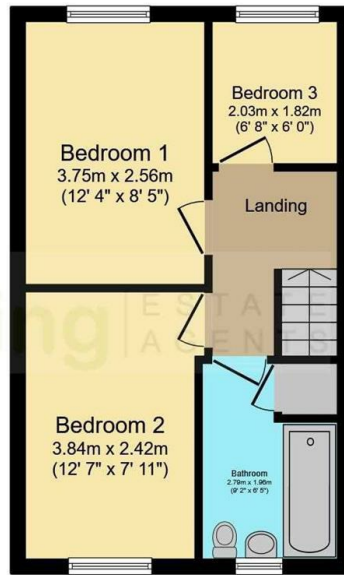

**First Floor**

Floor area 34.1 m<sup>2</sup> (367 sq.ft.)

**TOTAL: 68.2 m<sup>2</sup> (734 sq.ft.)**

This floor plan is for illustrative purposes only. It is not drawn to scale. Any measurements, floor areas (including any total floor area), openings and orientations are approximate. No details are guaranteed, they cannot be relied upon for any purpose and do not form any part of any agreement. No liability is taken for any error, omission or misstatement. A party must rely upon its own inspection(s). Powered by www.Propertybox.io

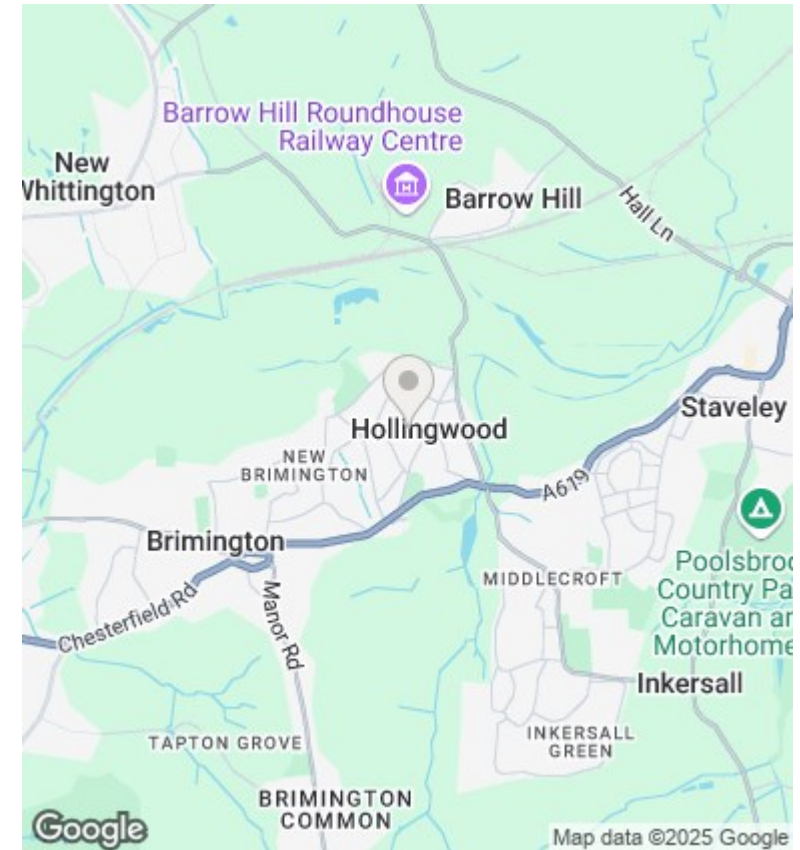

## Directions

## Viewings

Viewings by arrangement only. Call 01246 275 559 to make an appointment.

## Council Tax Band

B

## EPC Rating:

C

Energy Efficiency Rating		
	Current	Potential
Very energy efficient - lower running costs		
(92 plus) <b>A</b>		<b>91</b>
(81-91) <b>B</b>	<b>76</b>	
(69-80) <b>C</b>		
(55-68) <b>D</b>		
(39-54) <b>E</b>		
(21-38) <b>F</b>		
(1-20) <b>G</b>		
Not energy efficient - higher running costs		
<b>England &amp; Wales</b>	EU Directive 2002/91/EC	