



Mill Hill Road | Norwich | NR2 3DS

**** NO ONWARD CHAIN**** Located in the sought-after Golden Triangle area of Norwich, this Studio apartment can be found within a delightful period building. There is secure entry into the main building and accommodation comprises entrance hall, kitchen, bathroom, living room/bedroom with French doors leading onto a private balcony. The property is an ideal first time buy or buy to let investment. Early viewing is highly recommended.

Guide Price £99,000

- NO ONWARD CHAIN
- IDEAL FTB OR INVESTMENT
- GOLDEN TRIANGLE LOCATION
- CLOSE TO CITY CENTRE
- EPC RATING C

www.arnoldskeys.com | 01603 620551

Property Description

COMMUNAL ENTRANCE

Stairs to first floor.

ENTRANCE HALL

Doors to all rooms.

LOUNGE/BEDROOM

11' 11" x 10' 14" (3.63m x 3.4m) French doors leading onto balcony, storage cupboard and airing cupboard.

KITCHEN

7' 11" x 7' (2.41m x 2.13m) Window to the rear aspect, range of matching wall and base units, plumbing and space for washing machine, space for oven with gas hob, boiler and storage cupboard.

BATHROOM

8' 03" x 4' 11max" (2.51m x 1.5m) Window to the rear aspect, WC, wash hand basin and bath.

OUTSIDE

To the front there is a small communal lawn area and shingled parking to the rear.

VIEWING

Strictly by appointment with Arnolds Keys Norwich on 01603 620551

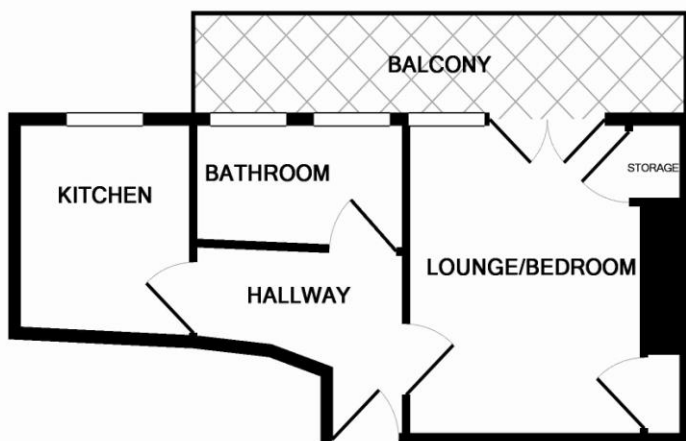

Whilst every attempt has been made to ensure the accuracy of the floor plan contained here, measurements of doors, windows, rooms and any other items are approximate and no responsibility is taken for any error, omission, or mis-statement. This plan is for illustrative purposes only and should be used as such by any prospective purchaser. The services, systems and appliances shown have not been tested and no guarantee as to their operability or efficiency can be given
Made with Metropix ©2016

norwich@arnoldskeys.com
01603 620551

Aylsham 01263 738444
Cromer 01263 512026
Eaton 01603 506697
Holt 01263 713966

North Walsham 01692 402357
Norwich 01603 620551
Sheringham 01263 822373
Wroxham 01603 782053

Agents Note: Whilst every care has been taken to prepare these sales particulars, they are for guidance purposes only. All measurements are approximate and for general guidance purposes only and whilst every care has been taken to ensure their accuracy, they should not be relied upon and potential buyers are advised to recheck the measurements