

# Jukes & Co

## Estate Agents



## South Norwood Hill

, London, SE25 6BY

Offers Over £800,000



This beautifully presented and tastefully decorated four double bedroom detached house offers over 1,400 square feet of stylish and spacious living.

On the ground floor, you'll find a sleek, modern bathroom, a generous lounge area, and a luxurious open-plan kitchen and dining room—perfect for entertaining guests or enjoying family time. The first floor features two further double bedrooms and a large family bathroom, while the top floor boasts two additional double bedrooms, one of which leads onto a private balcony with stunning views over London.

Located in the highly desirable area of South Norwood, this vibrant community offers a range of local amenities. The High Street is just a short walk away, with excellent transport links including a 12-minute train ride to London Bridge. You'll also find a yoga studio, popular bars, and fantastic restaurants nearby.

Enjoy relaxing weekends at the scenic Norwood Lakes or explore the trendy Crystal Palace area just up the road—ideal for socialising and enjoying everything the neighbourhood has to offer. Excellent local schools and a leisure centre are also within easy walking distance.

This exceptional home is offered chain-free and move-in ready, with no work required. A rare opportunity to secure a truly special property in one of South London's most vibrant locations.



Area Map

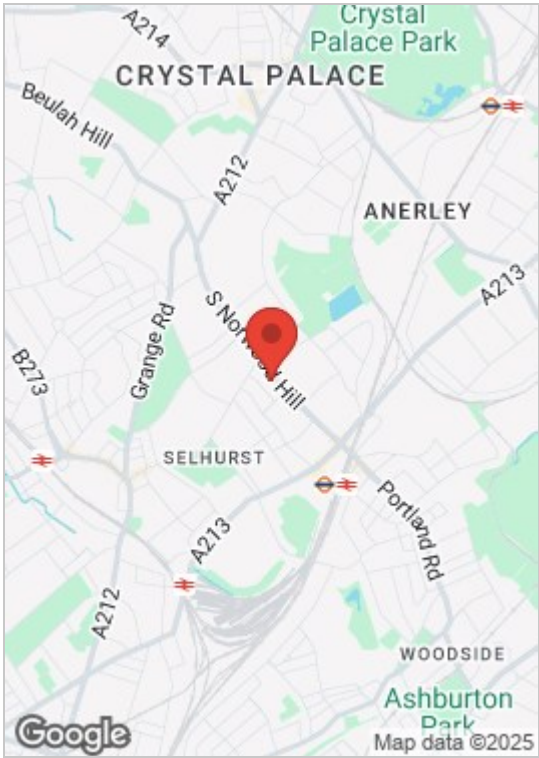

Floor Plan

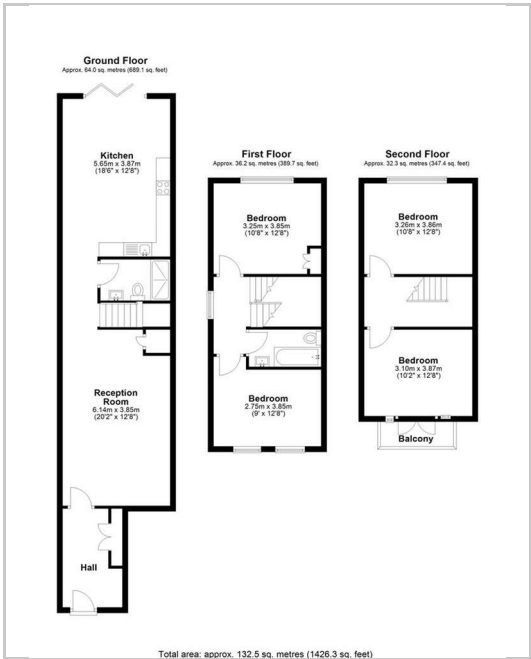

Energy Efficiency Graph

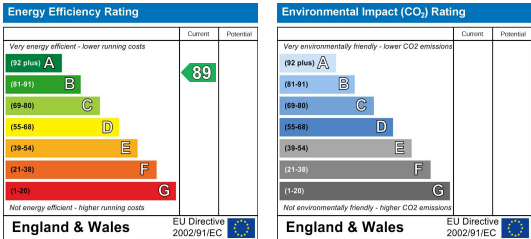

These particulars, whilst believed to be accurate are set out as a general outline only for guidance and do not constitute any part of an offer or contract. Intending purchasers should not rely on them as statements of representation of fact, but must satisfy themselves by inspection or otherwise as to their accuracy. No person in this firms employment has the authority to make or give any representation or warranty in respect of the property.