

Jukes & Co

Estate Agents



Manor Road

, London, SE25 4TA

£1,750 Per Month



Welcome to this spacious and modern 2-bedroom flat located in the sought-after Mansion Court. Offering a bright and airy open-plan kitchen and dining area, this home is perfect for both relaxed living and entertaining guests. The sleek, contemporary kitchen is fully equipped with modern appliances and ample storage, seamlessly flowing into the dining space, ideal for hosting or enjoying family meals.

The property features two generously sized double bedrooms, both offering plenty of natural light and ample storage space. The master bedroom benefits from a stylish ensuite bathroom, while the second bedroom is serviced by a well-appointed main bathroom, ensuring both convenience and privacy for all residents.

Situated in a friendly and welcoming neighbourhood, this flat is ideally positioned just a short walk from local shops, parks, and green spaces. Excellent transport links are easily accessible, with Norwood Junction Station nearby, providing fast connections to London Bridge, London Victoria, and East Croydon, making this the perfect home for commuters and families alike.



Area Map

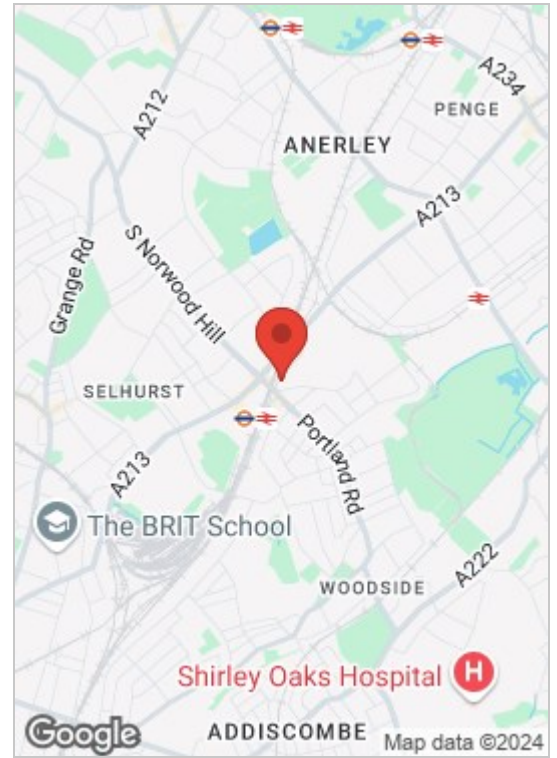

Floor Plan

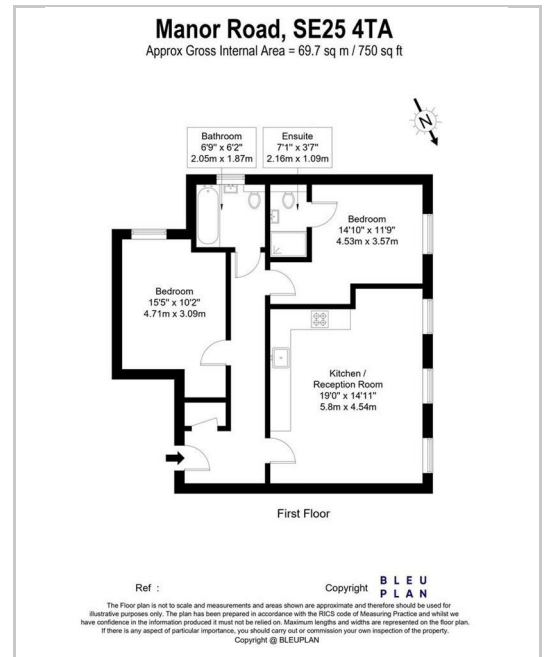

Energy Efficiency Graph

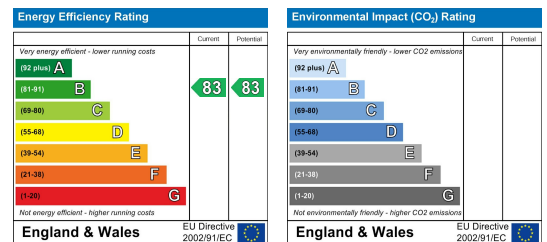

These particulars, whilst believed to be accurate are set out as a general outline only for guidance and do not constitute any part of an offer or contract. Intending purchasers should not rely on them as statements of representation of fact, but must satisfy themselves by inspection or otherwise as to their accuracy. No person in this firm's employment has the authority to make or give any representation or warranty in respect of the property.

Sales and Lettings

76 High Street, South Norwood, London SE25 6EB

T: 020 8653 9393 · F: 020 8771 5551 · E: sales@jukesestateagents.com · E: lettings@jukesestateagents.com

W: jukesestateagents.com