

Jukes & Co

Estate Agents



Watcombe Road

, London, SE25 4XA

£1,700 Per Month



Two Bedroom House | Large Dining/ Living Area | Separate Kitchen | Private Garden | Close to Norwood Junction Station.

Jukes & Co are pleased to present this spacious two bedroom terraced house in the heart of South Norwood. The property consist of a separate kitchen and a large walk through dining/ living area, offering convenient and spacious living.

The property has a good sized double bedroom and a single room, as well as a large three piece bathroom. which will be perfect for a professional couple or small family looking for their next home. You have access to a small conservatory which leads out into the private garden.

Conveniently located, Watcombe Road is only a short walk to Norwood Junction station which can get you to London Bridge within 15minutes and Canada Water within 30 minutes via the London Overground.

Council Tax: C
EPC: D



Area Map

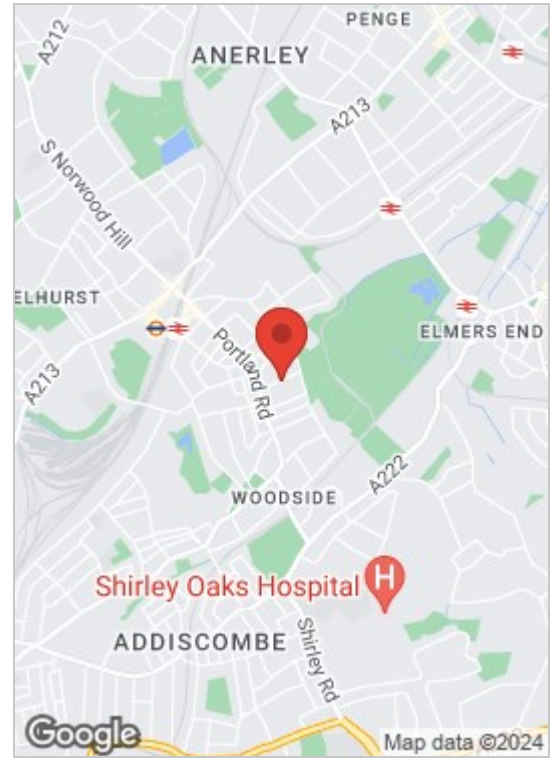

Floor Plan

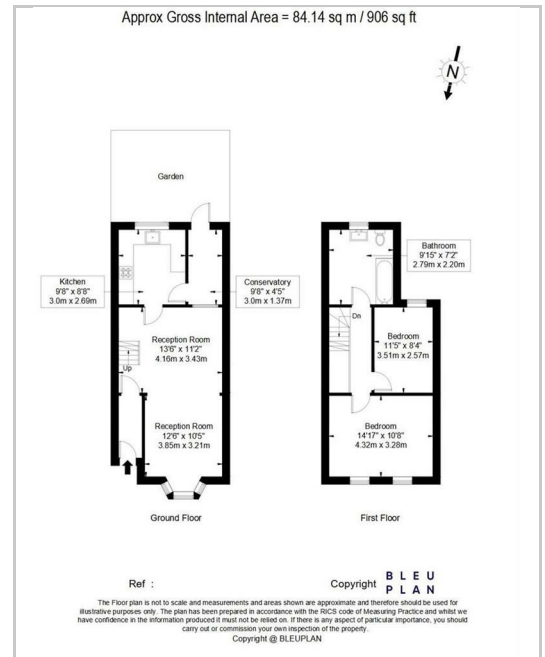

Energy Efficiency Graph

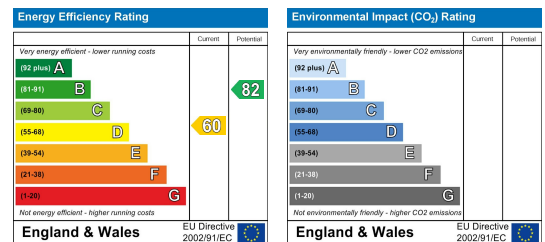

These particulars, whilst believed to be accurate are set out as a general outline only for guidance and do not constitute any part of an offer or contract. Intending purchasers should not rely on them as statements of representation of fact, but must satisfy themselves by inspection or otherwise as to their accuracy. No person in this firm's employment has the authority to make or give any representation or warranty in respect of the property.