

## 11 Clarendon Road, Southsea, PO5 2ED

### £825

GD3 Property are offering this spacious garden apartment on Clarendon Road close to local amenities.

The apartment is located at the rear of the property and has a small garden area. There is a spacious open-plan lounge and kitchen area with a free-standing oven and washing machine. Double bedroom with walk-in wardrobe, office area with a freestanding fridge/freezer and a bathroom with a white three-piece suite.

Please call the office on to arrange a viewing.

Council Tax Band: A

EPC Rating: D

Contract Length: 12 Month

Rent: £825.00 Per calendar Month

Security Deposit £951.00

Broadband/Mobile Supply Check: Please use the Ofcom website

**11 Clarendon Road, Southsea, PO5 2ED**

## Ground Floor

Approx. 45.3 sq. metres (487.1 sq. feet)

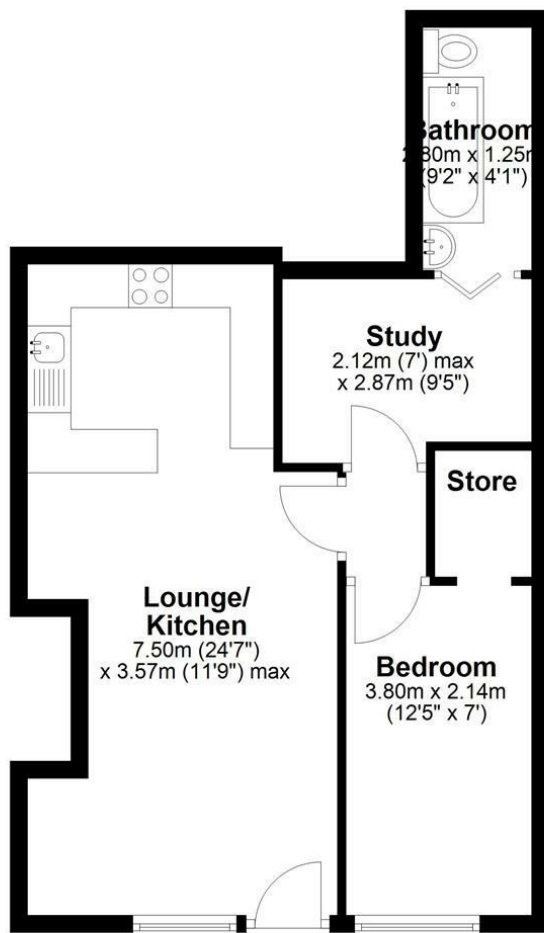

Total area: approx. 45.3 sq. metres (487.1 sq. feet)

