



**Q**Quinn & Co  
ESTATE AND LETTING AGENTS

**Stewart Road, Bournemouth**

- Extended semi-detached house
- Three double bedrooms
- Two storey rear extension
- Additional single storey extension

**£390,000**

EPC Rating 'D'







## Property Description

A spacious and extended three double bedroom semi-detached home, ideally positioned in the popular area of Charminster, Bournemouth. This versatile property has been thoughtfully enhanced with a two-storey rear and single storey side extension, creating generous and flexible living spaces perfect for modern family life.

The ground floor features an impressive 8m lounge, ideal for entertaining or relaxing, along with a 6m kitchen/diner offering ample room for family meals and social gatherings. Additional ground-floor benefits include a useful family room, a practical utility room, and a convenient downstairs cloakroom.

Upstairs, the extension provides a notably larger bedroom alongside two further double bedrooms, all served by a spacious family bathroom.





Externally, the property boasts off-road parking to the front and side, while the low-maintenance rear garden includes a substantial workshop, perfect for hobbies, storage, or potential studio use.

Offered to the market with no forward chain, this well-proportioned home presents an excellent opportunity to move into a highly desirable location close to local amenities, schools, and transport links.









GROUND FLOOR  
807 sq.ft. (74.9 sq.m.) approx.

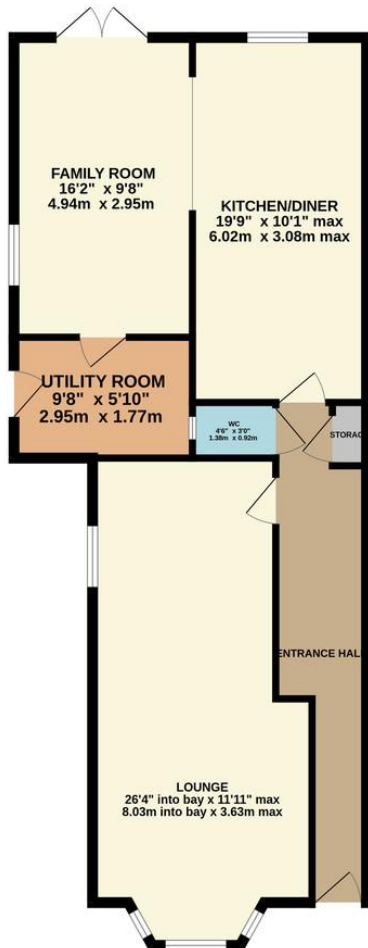

1ST FLOOR  
584 sq.ft. (54.3 sq.m.) approx.

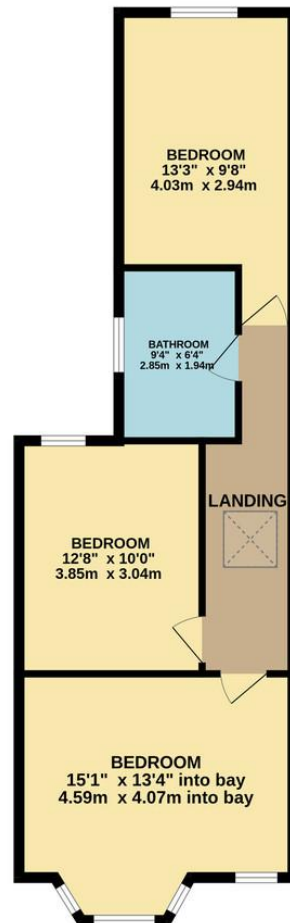

TOTAL FLOOR AREA: 1391 sq.ft. (129.2 sq.m.) approx.  
Whilst every attempt has been made to ensure the accuracy of the floorplan contained here, measurements

413-415 Charminster  
Road  
Bournemouth  
Dorset  
BH8 9QT

[www.quinnandco.co.uk](http://www.quinnandco.co.uk)  
[sales@quinnandco.co.uk](mailto:sales@quinnandco.co.uk)  
01202 512299

Consumer Protection from Unfair Trading Regulations 2008.

The Agent has not tested any apparatus, equipment, fixtures and fittings or services and so cannot verify that they are in working order or fit for the purpose. A Buyer is advised to obtain verification from their Solicitor or Surveyor. References to the Tenure of a Property are based on information supplied by the Seller. The Agent has not had sight of the title documents. A Buyer is advised to obtain verification from their Solicitor. Items shown in photographs are NOT included unless specifically mentioned within the sales particulars. They may however be available by separate negotiation. Buyers must check the availability of any property and make an appointment to view before embarking on any journey to see a property.