



Stoneacre
Properties



Skyline

St Peters Square Leeds, LS9 8BN

£295,000



Skyline

St Peters Square Leeds, LS9 8BN

£295,000



Lease

26 Skyline - We are advised by the vendor that the property is leasehold with an original term of 125 years from 2009. The current service charge is approximately £546.72 per quarter and the ground rent is £250 per annum. A buyer is advised to obtain verification from their solicitor or legal advisor.

52 Skyline - We are advised by the vendor that the property is leasehold with an original term of 125 years from 2009. The current service charge is approximately £546.72 per quarter and the ground rent is £250 per annum. A buyer is advised to obtain verification from their solicitor or legal advisor.



Road Map



Hybrid Map



Terrain Map

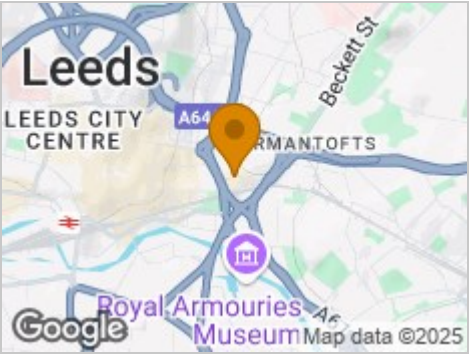

Floor Plan

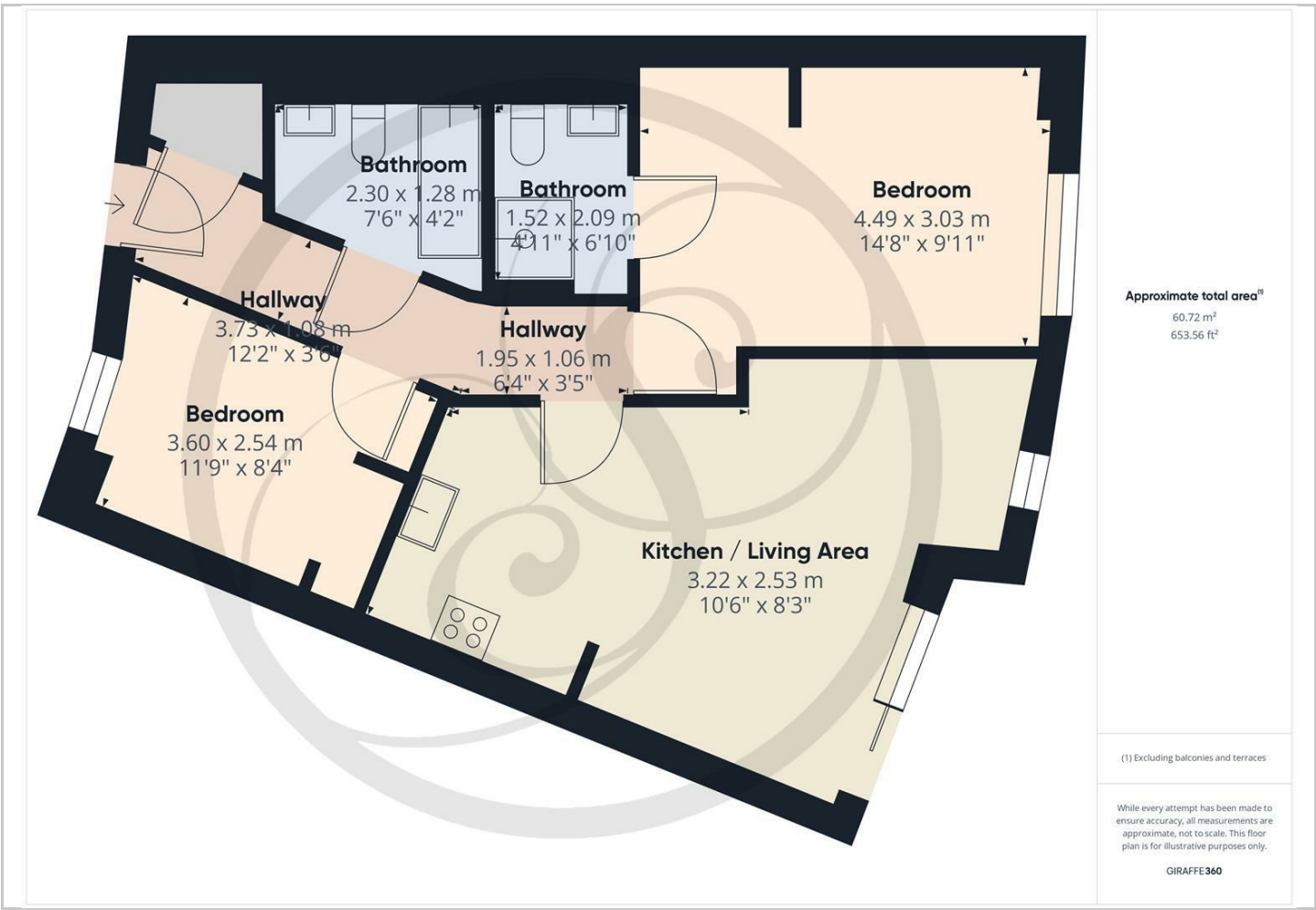

Viewing

Please contact our Chapel Allerton Sales Office on 0113 237 0999 if you wish to arrange a viewing appointment for this property or require further information.

Energy Efficiency Graph

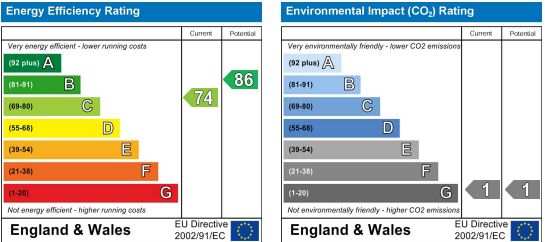

These particulars, whilst believed to be accurate are set out as a general outline only for guidance and do not constitute any part of an offer or contract. Intending purchasers should not rely on them as statements of representation of fact, but must satisfy themselves by inspection or otherwise as to their accuracy. No person in this firm's employment has the authority to make or give any representation or warranty in respect of the property.