



Stoneacre
Properties



King Charles Street, Leeds, LS1 6LZ

£110,000

*** CASH BUYERS ONLY *** Welcome to this charming flat located on King Charles Street in the heart of Leeds City Centre. This property boasts a cosy reception room, perfect for relaxing or entertaining guests. With one bedroom and one bathroom, this flat offers a comfortable living space ideal for individuals or couples looking to reside in a vibrant urban setting.

This flat presents an excellent investment opportunity as it is being sold with a sitting tenant, ensuring a steady rental income from day one. The presence of a concierge adds a touch of luxury and convenience to your daily life, providing assistance and security within the building.

Situated in a prime location, this wonderful apartment offers easy access to all the amenities and attractions that Leeds City Centre has to offer.

Please note that this property is suitable for cash buyers only, making it an ideal opportunity for those looking to make a savvy investment in the bustling city of Leeds. Don't miss out on the chance to own a piece of this vibrant urban landscape - book a viewing today and envision the endless possibilities this flat has to offer.

Lease: We are advised by the vendor that the property is leasehold with 231 years remaining. The current service charge is approximately £452 per quarter and the ground rent is £250 per annum. A buyer is advised to obtain verification from their solicitor or legal advisor.

Floor Plan

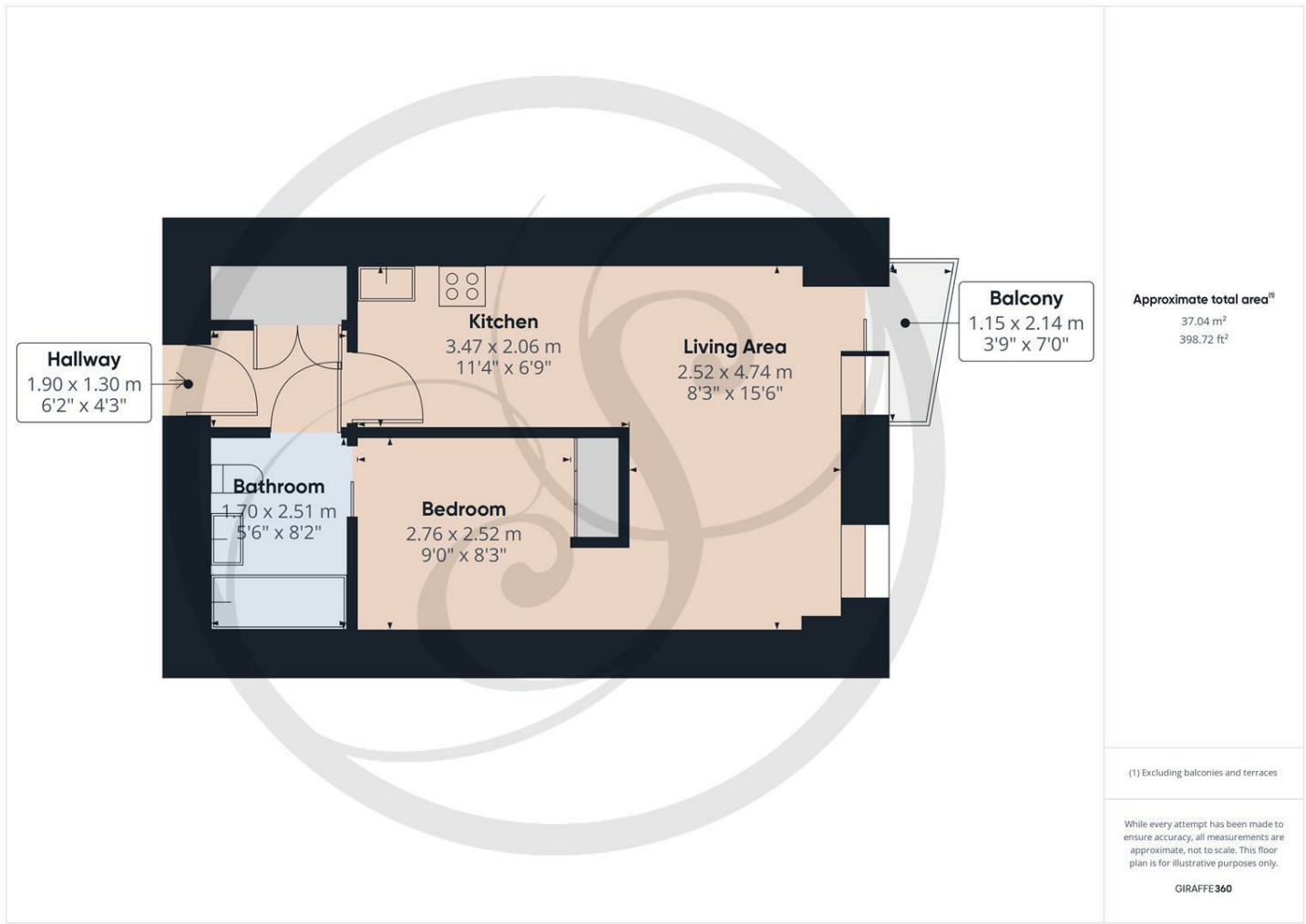

Area Map

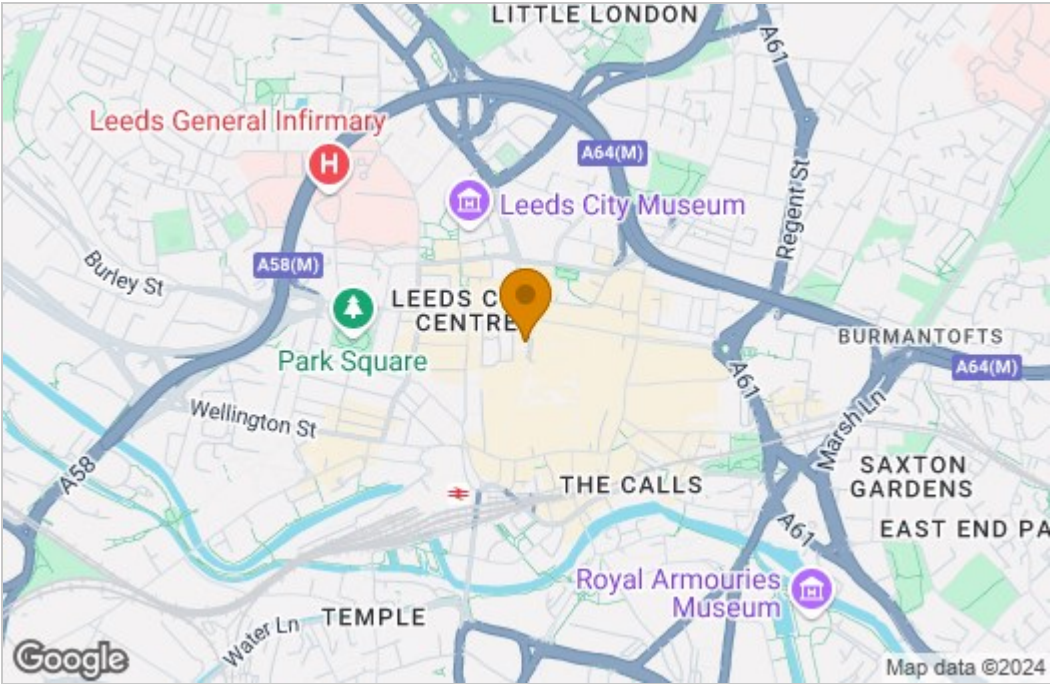

Energy Efficiency Graph

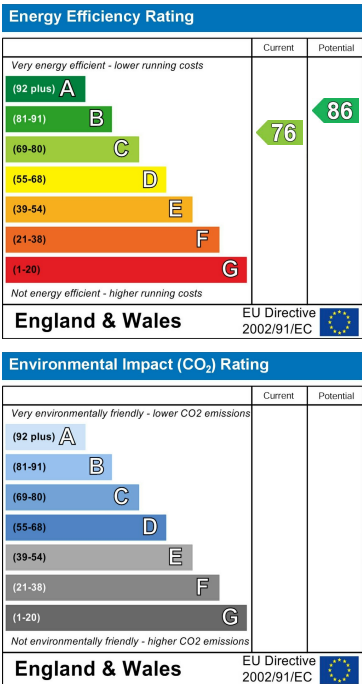

These particulars, whilst believed to be accurate are set out as a general outline only for guidance and do not constitute any part of an offer or contract. Intending purchasers should not rely on them as statements of representation of fact, but must satisfy themselves by inspection or otherwise as to their accuracy. No person in this firm's employment has the authority to make or give any representation or warranty in respect of the property.

