



HUBERT GROVE, SW9 9PD

Asking Price £575,000

A well-presented two double bedroom ground floor flat offered to the market with a private garden and no onward chain. The accommodation comprises two bedrooms, a bathroom, kitchen, reception room and a rear garden. Hubert Grove is ideally located for the amenities of Clapham High Street and Clapham Old Town, where there are many local shops, bars and restaurants. The area is well connected with brilliant transport links. Clapham North underground station is approximately 0.3 miles away and Stockwell underground station is approximately 0.7 miles away. In addition, there are many bus routes which provide quick and easy access into both The City and The West End.

Share of Freehold. EPC rating: C. Council tax band C. Please see the virtual tour provided:

<https://my.matterport.com/show/?m=mRG891r2pBp>.



www.maalems.co.uk

Earlsfield & Wandsworth Office

344 Garratt Lane

Earlsfield, London SW18 4EL

T: 020 8875 9200

earlsfield@maalems.co.uk

Registered in England & Wales No. 5585458



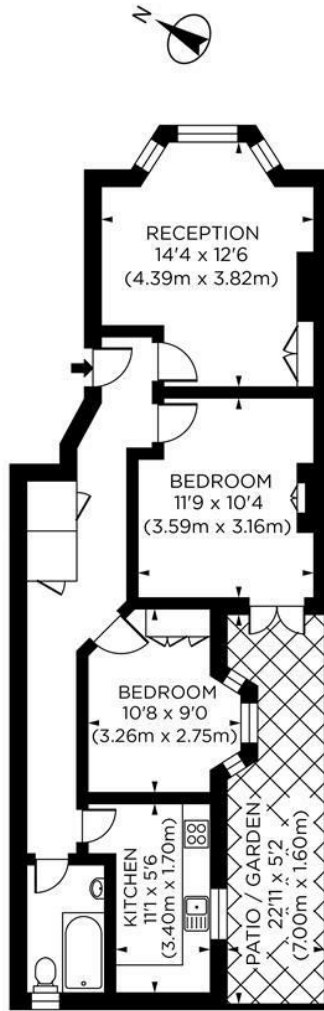

GROUND FLOOR

Hubert Grove, SW9
Gross Internal Area 614 sq ft/57 sq metres
©photosandfloorplans.com

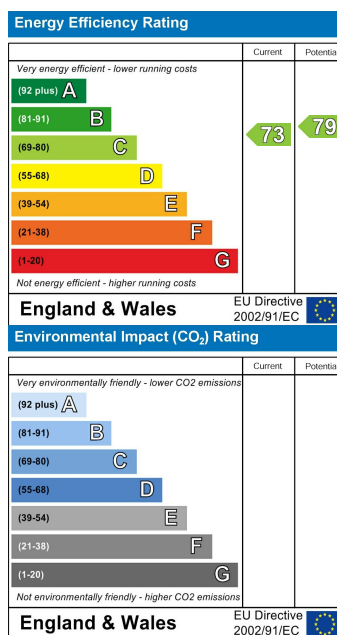
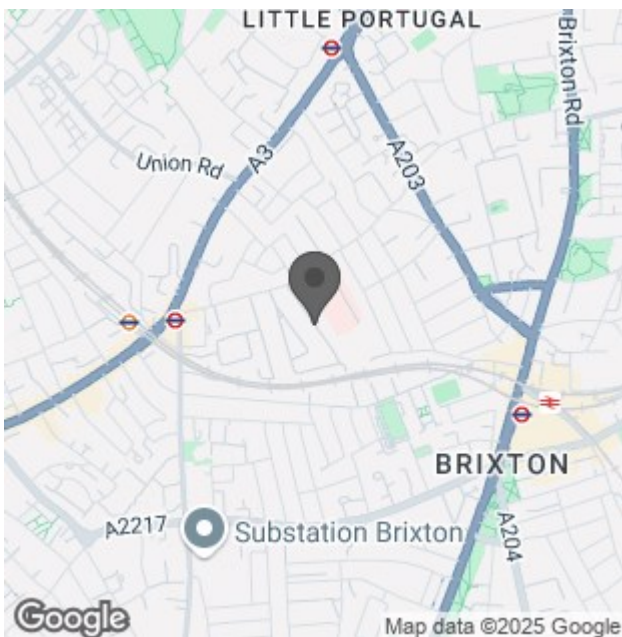

For an instant or face to face valuation, please scan the QR code:



www.maalems.co.uk
Earlsfield & Wandsworth Office
344 Garratt Lane
Earlsfield, London SW18 4EL
T: 020 8875 9200
earlsfield@maalems.co.uk

Registered in England & Wales No. 5585458

