

URBAN lettings



9 Windmill Drive, London, SW4 9DE

£4,350 Per Month

- Exceptional Family Home
- Modern Bathroom
- Dining Room & Utility Room
- Professional Couple or Family Only
- Immaculately Presented
- Three Bathrooms
- Patio Garden & Balcony
- Approx 2,400 sq ft
- Two receptions
- Unique Location on Clapham Common

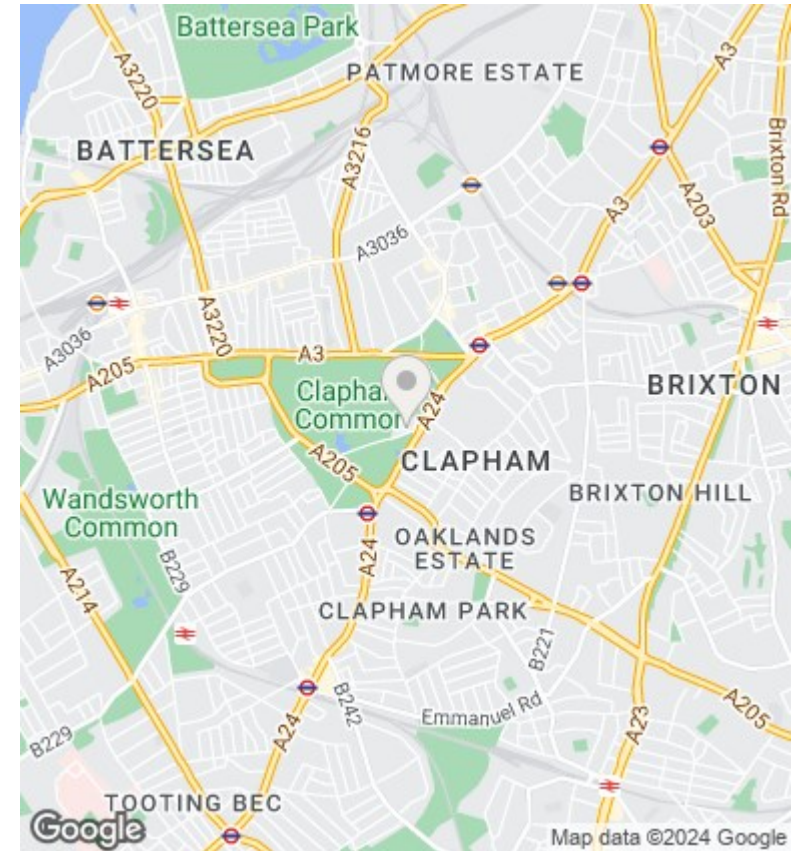
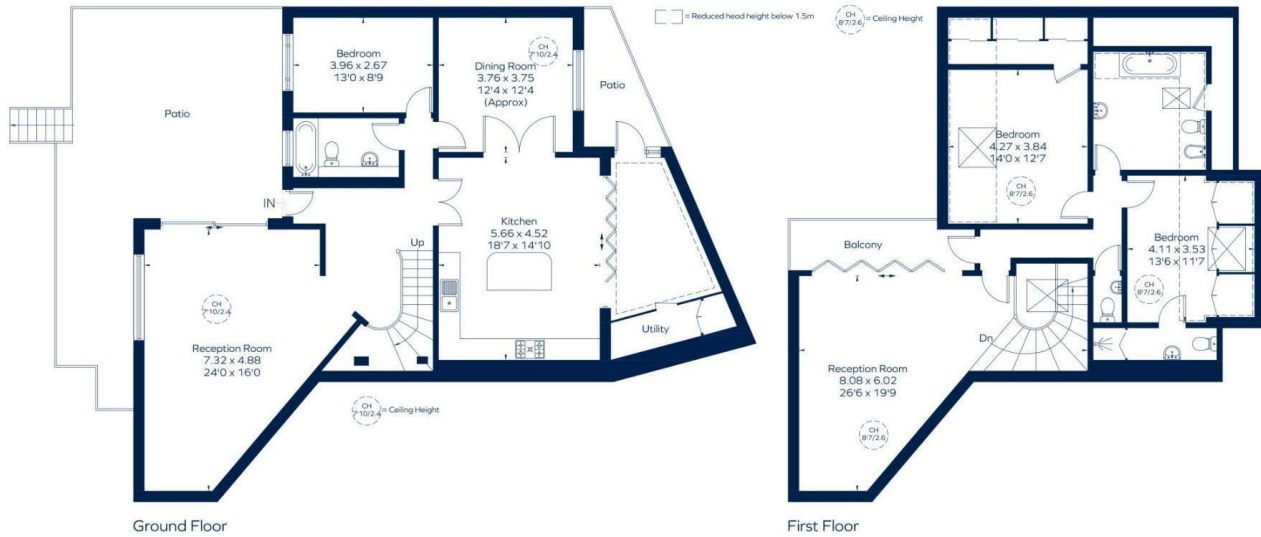

Directions

Viewings

Viewings by arrangement only. Call 020 7585 2761 to make an appointment.

Council Tax Band

E

EPC Rating:

C

Energy Efficiency Rating		Current	Potential
<i>Very energy efficient - lower running costs</i>			
(92 plus) A			
(81-91) B		76	76
(69-80) C			
(55-68) D			
(39-54) E			
(21-38) F			
(1-20) G			
<i>Not energy efficient - higher running costs</i>			
England & Wales		EU Directive 2002/91/EC	