

URBAN lettings



10A Windmill Drive, London, SW4 9DE

£4,350 Per Month

- Exceptional Family Home
- Modern Bathroom
- Dining Room & Utility Room
- Professional Couple or Family Only
- Approx 2,400 sq ft
- Three Bathrooms
- Patio Garden & Balcony
- Immaculately Presented
- Two receptions
- Unique Location on Clapham Common

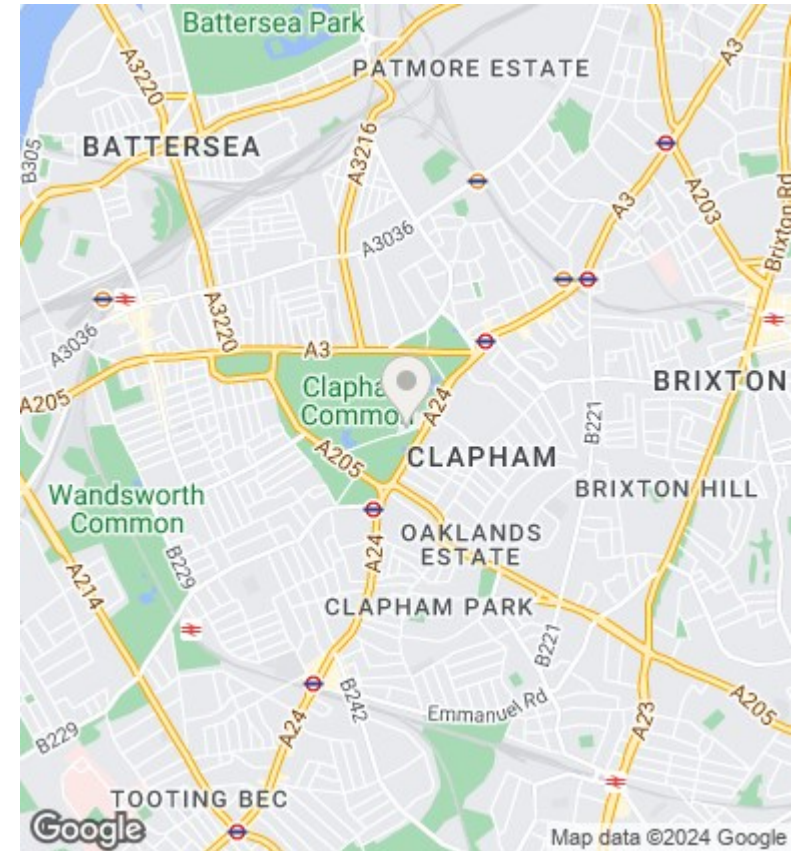
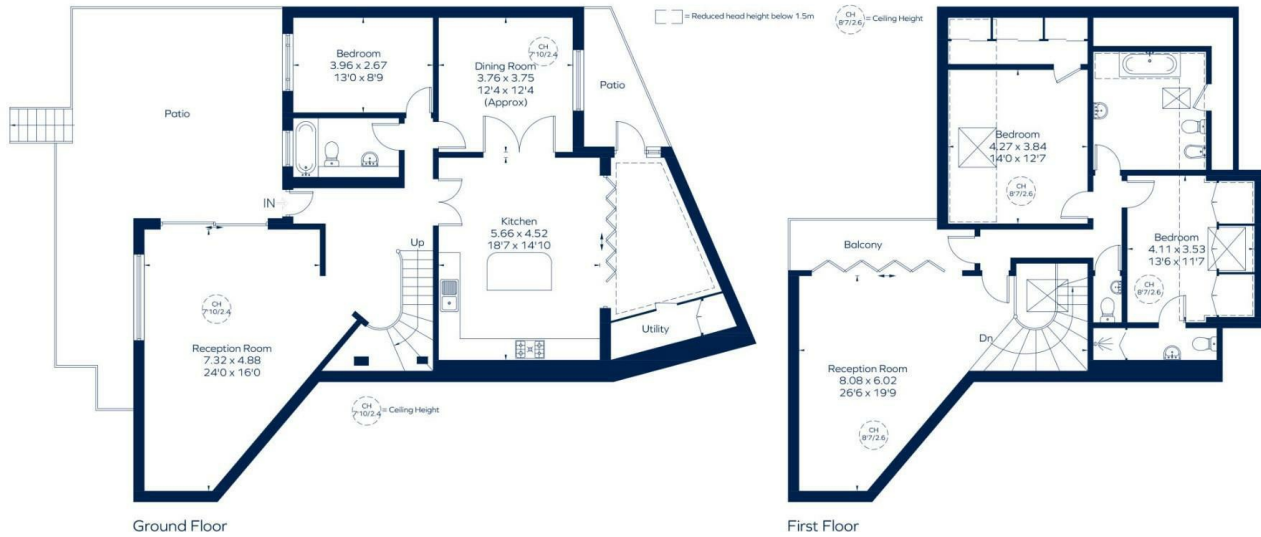

Directions

Viewings

Viewings by arrangement only. Call 020 7585 2761 to make an appointment.

Council Tax Band

E

EPC Rating:

C

Energy Efficiency Rating		Current	Potential
<i>Very energy efficient - lower running costs</i>			
(92 plus)	A		
(81-91)	B	76	76
(69-80)	C		
(55-68)	D		
(39-54)	E		
(21-38)	F		
(1-20)	G		
<i>Not energy efficient - higher running costs</i>			
England & Wales		EU Directive 2002/91/EC	