

HARWOOD

THE ESTATE AGENT

44-46 market street, wellington, telford. shropshire. TF1 1DT

36 Champion Drive, Donnington Wood, Telford, Shropshire, TF2 7RH



**Offers in
Excess of
£215,000**

A Two Double Bedroom Detached Bungalow with garage, conservatory and enclosed garden

Providing approximately 75.4 sq meters (811.8 sq Feet) of wonderful living space.

Situated within a very popular and much sought after residential area with excellent access to the local road network A4640, access to the A5 and M54 link. Local schools and within close proximity to local shops and amenities including the Asda super market store. Comprising: Through hallway, lounge/dining room, kitchen, two double bedrooms, shower room and conservatory. Gas central heating and double glazing. Outside area: Driveway, garage and rear enclosed garden with lawn and patio area. No Upward Chain

Sales
01952 641111

email: harwood@harwoodestates.com
www.telfordestateagent.co.uk

Lettings
01952 505505

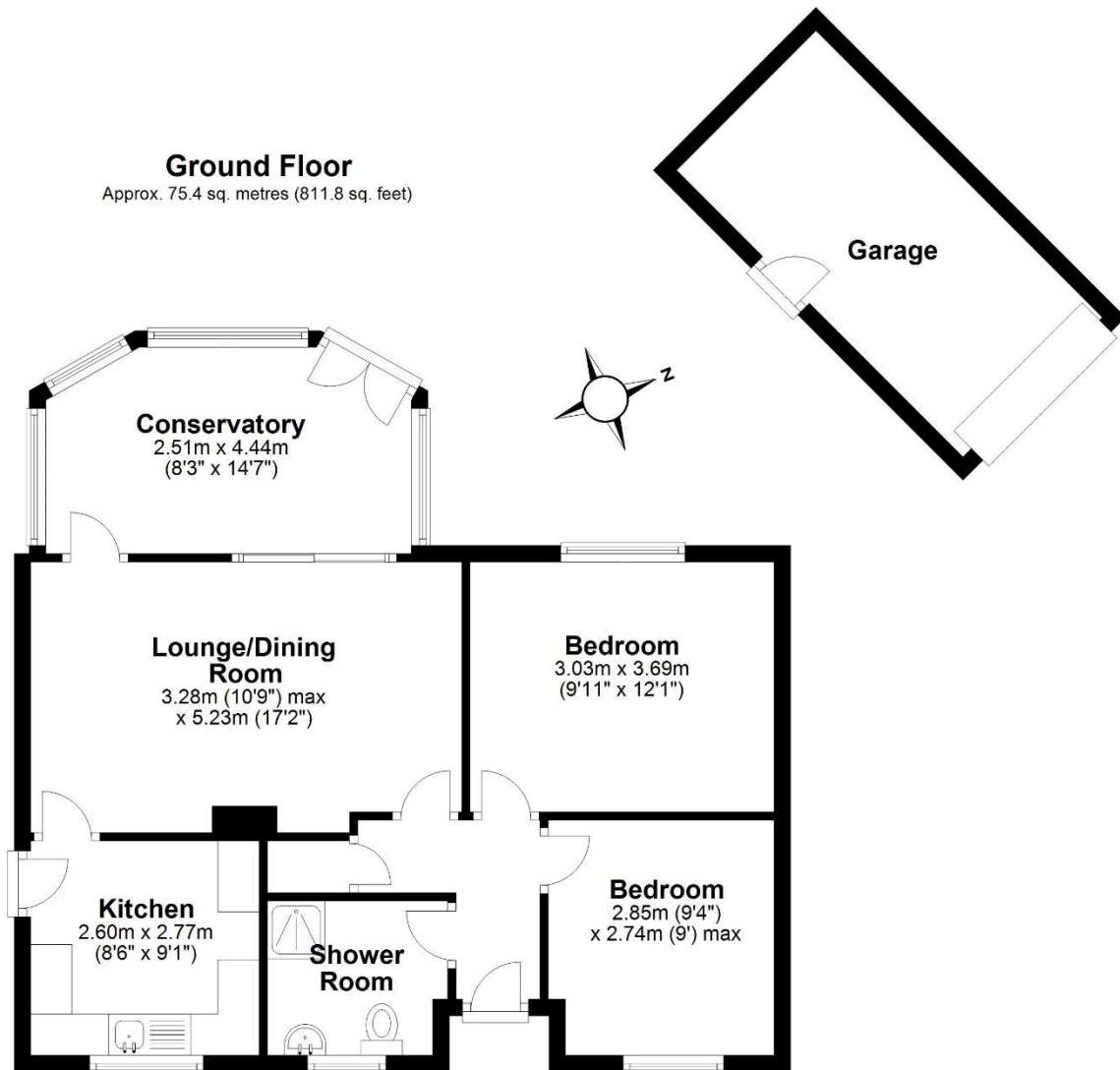

Total area: approx. 75.4 sq. metres (811.8 sq. feet)

Tenure	We are advised by the vendor that the property is Freehold
Council Tax	Band C
Fixtures & Fittings	Where specifically mentioned in these sales particulars are included in the sale price.
N.B	Please note, that any of the services, heating systems or any appliances at this property, have not been tested, therefore no warranty can be given or implied as to their working order.
Viewing Arrangements	by appointment 24 HOURS A DAY 7 DAYS A WEEK, although office hours are limited to normal working hours we are available by telephone to take enquiries, valuations and viewings at any time. If you do encounter an answer phone please leave a message for a staff member to return your call.

These particulars do not constitute or form a part of any contract. Whilst Harwood Estate Agents and their employees take every care in the preparation of these particulars they hereby state both on behalf of themselves and the vendor that no intending purchaser should rely on any of the statements of representation of fact and the intending purchaser should make his/her own inspection and enquiries in order to satisfy himself/herself of their authenticity and no responsibility is accepted for any error or omission herein.

Details prepared 15 January 2025

