

Upper Holme, off Main Street

Zouch, Loughborough, LE12 5EQ

John 
German





Upper Holme, off Main Street

Zouch, Loughborough, LE12 5EQ

£230,000

A unique opportunity to acquire a beautifully presented, modernised home, in an idyllic riverside location, with extensive private mooring rights, a large garden and carport.



Zouch is a delightful hamlet situated next to the River Soar, located between Hathern and Normanton on Soar. The nearby conurbations provide plenty of amenities including shops, boutiques, a Post Office and a variety of pubs and restaurants.

Public transport well catered for by regular bus service to Loughborough, commuter access to the M1 and A6 is excellent.

Versatile accommodation comprises one double bedroom, lounge, sunroom (can be used as a second bedroom), kitchen and bathroom.

Externally, there is a decked terrace to the rear which soaks in the views down the River Soar while the property's private mooring rights are situated on both the north and south sides of the island. The garden (approx. 0.35 acres) is of excellent size and beautifully maintained. Parking is conveniently located within a double carport and the driveway provides ample visitor parking.

Agents notes:

-The property is subject to a £190pa public liability insurance related to the bridge located on Upper Holme Road.

-Due to the nature of construction, we do not believe the property is mortgageable.

Tenure: Freehold (purchasers are advised to satisfy themselves as to the tenure via their legal representative).

Property construction: Timber framed

Parking: Drive & carport

Electricity supply: Mains

Water supply: Mains

Sewerage: Mains

Heating: Electric Storage (Economy 7)

(Purchasers are advised to satisfy themselves as to their suitability).

Broadband type: Fibre - See Ofcom link for speed: <https://checker.ofcom.org.uk/>

Mobile signal/coverage: See Ofcom link <https://checker.ofcom.org.uk/>

Local Authority/Tax Band: Rushcliffe Borough Council / Tax Band A

Useful Websites: www.gov.uk/government/organisations/environment-agency

www.rushcliffe.gov.uk

Our Ref: JGA/19062024

The property information provided by John German Estate Agents Ltd is based on enquiries made of the vendor and from information available in the public domain. If there is any point on which you require further clarification, please contact the office and we will be pleased to check the information for you, particularly if contemplating travelling some distance to view the property. Please note if your enquiry is of a legal or structural nature, we advise you to seek advice from a qualified professional in their relevant field.





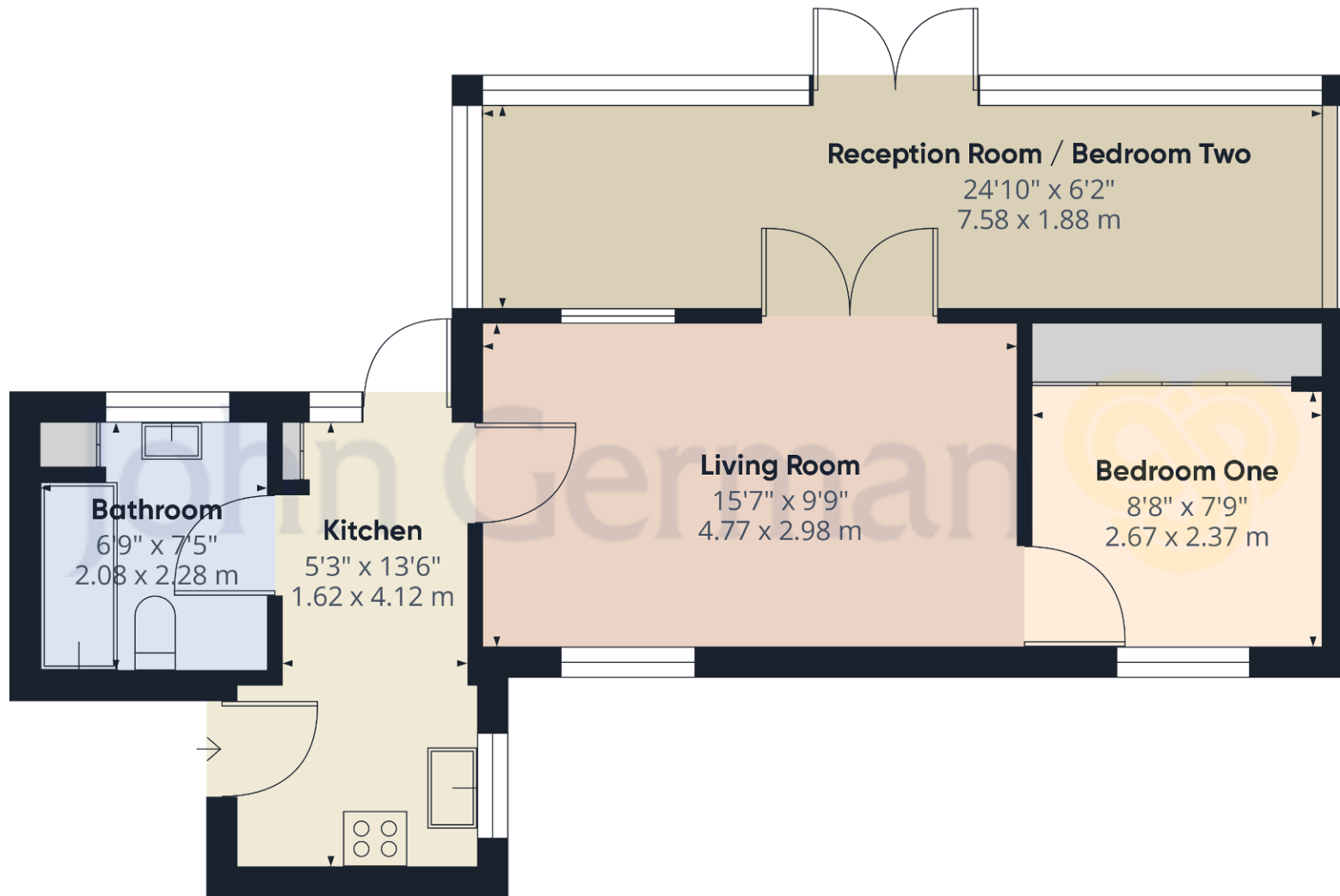

Approximate total area⁽¹⁾

532.11 ft²

49.43 m²

(1) Excluding balconies and terraces

While every attempt has been made to ensure accuracy, all measurements are approximate, not to scale. This floor plan is for illustrative purposes only.

GIRAFFE360



Agents' Notes

These particulars do not constitute an offer or a contract neither do they form part of an offer or contract. The vendor does not make or give and Messrs. John German nor any person employed has any authority to make or give any representation or warranty, written or oral, in relation to this property. Whilst we endeavour to make our sales details accurate and reliable, if there is any point which is of particular importance to you, please contact the office and we will be pleased to check the information for you, particularly if contemplating travelling some distance to view the property. None of the services or appliances to the property have been tested and any prospective purchasers should satisfy themselves as to their adequacy prior to committing themselves to purchase.

Referral Fees

Mortgage Services - We routinely refer all clients to APR Money Limited. It is your decision whether you choose to deal with APR Money Limited. In making that decision, you should know that we receive on average £60 per referral from APR Money Limited.

Conveyancing Services - If we refer clients to recommended conveyancers, it is your decision whether you choose to deal with this conveyancer. In making that decision, you should know that we receive on average £150 per referral.

Survey Services - If we refer clients to recommended surveyors, it is your decision whether you choose to deal with this surveyor. In making that decision, you should know that we receive up to £90 per referral.

Score	Energy rating	Current	Potential
92+	A		
81-91	B		
69-80	C		71 C
55-68	D		
39-54	E	52 E	
21-38	F		
1-20	G		



John German

75 Main Street, East Leake, Loughborough, Leicestershire, LE12 6PS

01509 856006

eastleake@johngerman.co.uk

Ashbourne | Ashby de la Zouch | Barton under Needwood
Burton upon Trent | Derby | East Leake | Lichfield
Loughborough | Stafford | Uttoxeter

JohnGerman.co.uk Sales and Lettings Agent



