



SUMMERPARK

DUMFRIES, DG1 3TP



***STRONG.
BEAUTIFUL.***

***AS A FAMILY-OWNED
BUSINESS, WE GO TO
GREAT LENGTHS
TO CRAFT BEAUTIFUL,
WELL-BUILT HOMES.***

Homes that are not only strong in build, but in character too.

Story homes challenge the conventions of the mass-produced, standing apart from the crowd. There's all the features that make a Story home unique. The space we leave between each home, and footpaths that little bit wider, because that's what people need. Even our front doors are different colours. And the best combinations of bricks, render and stone are used, with considered design features at every turn.

With a brand new Story home, you will find there are no compromises on quality, no corners cut – just solid, beautiful homes.

**SOLIDLY-BUILT WITH
QUALITY MATERIALS.**

Premium specification.
Added strength and character.

**BUILDING BEAUTIFUL HOMES
FOR OVER 30 YEARS.**

Pride in our homes.
Pride in our workforce.

**WE'LL GIVE YOU MORE
SPACE INSIDE & OUT.**

Well-proportioned living areas.
Set back off the road.

**DESIGNED
FOR LIFE.**

Unique modern features.
Effortlessly flowing spaces.

*WE BUILD
IN ENVIABLE
LOCATIONS
THAT DEMAND
HOMES TO
MATCH.*

*AWARD-WINNING DEVELOPMENT. COUNTRYSIDE VIEWS.
SUMMERPARK REALLY DOES HAVE IT ALL.*

Summerpark is Story Homes' first ever development in Scotland and is still the biggest in Dumfries and Galloway to date. Summerpark is close to The Solway Firth and surrounded by beautiful countryside, perfect for walking and cycling.

Nearby are two beaches, Southernness and Powmillimount, plus, you can access the A75, which connects to Stranraer, with ease. There are also a number of local restaurants, cafés and bars nearby as well as Calside Primary School and Dumfries High School.

This charming development was also recently named 'Low Rise Residential Development of the Year' at the 2019 Premier Guarantee Excellence Awards.

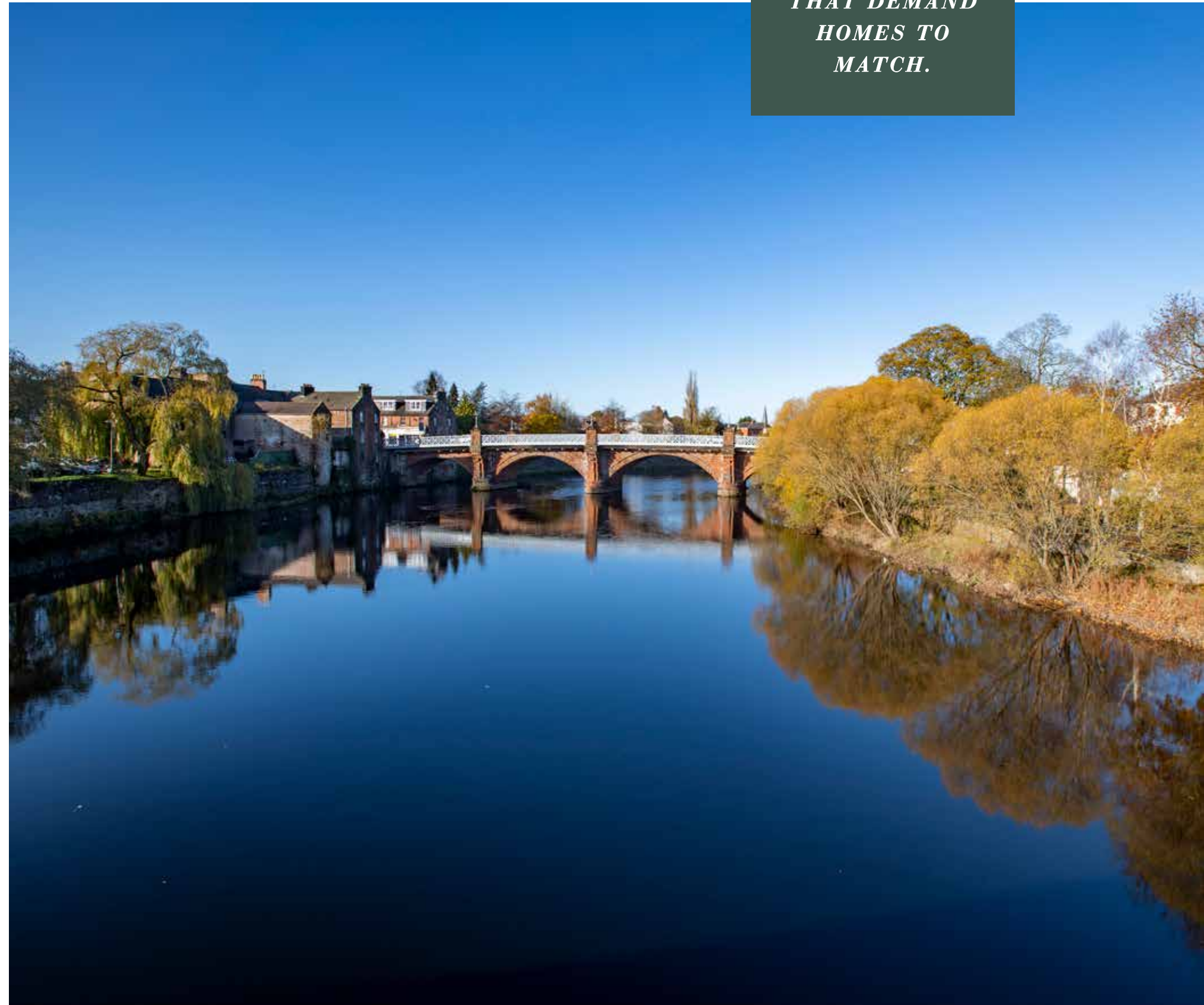

*STRONG
IN BUILD.
STRONG IN
CHARACTER.*



Image shown is for illustrative purposes only.

Of course, every home is unique. But with a new Story home, you'll discover some elements are shared. Like open-plan living areas that radiate light and space. Well-designed kitchens that deliver practicality and durability. Beautifully designed bathrooms and en-suites that take centre stage. And there's also French doors that are included as standard, helping to create a seamless link between your home and garden.

What's more, when you buy a new Story home, you have the opportunity to personalise your home even further with our choices, upgrades and optional extras which can be incorporated seamlessly into your new home.

But it's not only our premium specification that's well considered. Our homes are built with sustainability in mind, with the aim of helping the environment and saving you money.

*A 4-bed detached Victorian house with some modern improvements has average yearly energy costs of £2,460. Whereas, the equivalent new build home that has been built to 2013 Building Regulations could have average yearly energy costs of £1,050, saving £1,410 per annum. SOURCE: new-homes.co.uk.

A new build is more economical to run than an older property. It uses less energy and produces significantly lower CO2 emissions, meaning lower running costs, and a saving of up to £1,410 pa on a 4-bedroom detached new build property.* Energy saving features could include:

- High levels of thermal efficiency
- 'A' rated kitchen appliances (majority of appliances)
- Dual flush toilets
- 100% energy efficient lighting

Each home at Summerpark is built with thermally-efficient building materials, and has a smart meter installed, so you can monitor your energy consumption. This, along with water-saving appliances and an airtight design, will give you all the benefits of a new build home.

YOUR NEW HOME IS CRAFTED USING THE BEST QUALITY MATERIALS AND THE HIGHEST SPECIFICATION POSSIBLE.

		THE KENMORE	THE FENTON	THE LAURISTON	THE DUNBAR	THE NEWTON
DOORS, JOINERY AND FINISHES	French doors	White French doors	–	■	■	■
	External doors - front	Single cottage rectangle style obscure glaze coloured composite door with multi-point locking system (white finish inside)	■	■	■	■
	External doors - rear	White half glaze style PVCu door with Cotswold obscure pattern and glazing with multi-point locking system	■	–	–	–
	Internal doors	White Canterbury style 4-panel wood-grain finish doors with chrome lever door handle	■	■	■	■
	Architrave and skirting boards	White MDF 69x19mm architrave and 119x19mm skirting	■	■	■	■
	Staircase	White painted softwood spindles with square, redwood newel post and handrail finished with white gloss	■	■	■	■
	Ceilings	White matt emulsion to all ceilings	■	■	■	■
	Walls	Jasmine white matt emulsion to all walls	■	■	■	■
KITCHEN AND APPLIANCES	Kitchen	Range of kitchens in a contemporary layout with matching panels, corners and plinths	■	■	■	■
	Work surfaces and upstand	38mm laminate worktops	■	■	■	■
		100mm upstand to match worktop choice	■	■	■	■
	Hob splashback	Stainless steel splashback behind hob	■	■	■	■
	Lights to underside of kitchen wall units	Feature lighting to the underside of kitchen wall unit as per kitchen design	■	■	■	■
	Oven	Zanussi single oven	■	■	–	–
		Dual single oven	–	–	■	■
	Gas hob	Zanussi 60cm gas hob	■	■	■	■
	Cooker hood	Stainless steel traditional chimney hood	■	■	■	■
	Integrated fridge/freezer	Zanussi 50/50 fridge freezer	■	■	■	■

Markers indicate standard specification. The specification relates to the majority of plots and appliances and is dependent on housetype design. Please note that the interior design, fittings and furnishings that make up our show homes are not part of our standard specification. Story Homes reserves the right to amend the specification. Please check individual plot specification and build stage with Sales Executive, or see our specification guide.

■ Available as standard
▲ Available as an upgrade
– Not available

WE KNOW THE DIFFERENCE
IS IN THE DETAIL. ON EVERY LEVEL.

BUILD QUALITY
WITH NO
COMPARISON.

		THE KENMORE	THE FENTON	THE LAURISTON	THE DUNBAR	THE NEWTON
BATHROOM AND SANITARYWARE	Bathroom basin	Free standing white basin and pedestal to bathroom/ en-suite/cloakroom with chrome mixer tap	■	■	■	■
	WC	Free standing white WC suite with soft close toilet seat to bathroom, en-suite and cloakroom	■	■	■	■
	Bath	Bath with centrally located chrome bath mixer tap and low-level shower hose/handset	-	-	■	■
		Shower over bath with exposed bar thermostatic shower valve with high level shower handset	■	■	-	-
	Wall tiles to bathroom and en-suite	Half tiled and full height feature walls Porcelanosa tile options from mainstream range as per house layouts	■	■	■	■
HEATING	Central heating	Full gas central heating (combi boiler with mains pressure)	■	■	■	■
	Radiators	Thermostatically controlled radiator valves	■	■	■	■
	Towel rails	Chrome towel warmer to bathroom and en-suite	■	■	■	■
ELECTRICAL	Electrical sockets/switch plates	White plastic electrical sockets/switch plates throughout	■	■	■	■
	BT/phone point	BT point to lounge (NB first point will be standard BT box)	■	■	■	■
	TV point	TV point to selected locations	■	■	■	■
	Downlighters to kitchen and wet rooms	Brushed stainless steel LED downlighters to kitchen, bathroom and en-suite	■	■	■	■
EXTERNAL WORKS	Fencing and gates	1.8m high timber fence or wall with timber gate. Please refer to site layout	■	■	■	■
	Front garden	Turf to front and side garden (plot specific, speak to Sales Executives for more information)	■	■	■	■
	Outside tap	To be fitted on rear elevation of property, tap to be fitted in agreed location in accordance with working drawings and insulated accordingly	■	■	■	■
	Garages	Power and light to all integral and detached garages	-	-	-	■
	Garage door	Retractable style garage door finished in a range of colours. Please refer to site layout for details	-	-	-	■
	Paving	Buff textured concrete paving	■	■	■	■
	Driveway	Block paved driveway	■	■	■	■



Image shown is for illustrative purposes only.

Markers indicate standard specification. The specification relates to the majority of plots and appliances and is dependent on housetype design. Please note that the interior design, fittings and furnishings that make up our show homes are not part of our standard specification. Story Homes reserves the right to amend the specification. Please check individual plot specification and build stage with Sales Executive, or see our specification guide.

■ Available as standard
▲ Available as an upgrade
- Not available

**OUR HOMES AT
THE SUMMERPARK**

**FROM THEIR UNIQUE CHARACTER AND BEAUTY
TO THE SPACE WE LEAVE BETWEEN EACH ONE,
OUR HOMES OFFER INDIVIDUALITY THROUGHOUT.**

- | | | | | | |
|---|--|---|--|---|--|
|  | THE NEWTON
4-bedroom detached house
<i>Detached single garage</i> |  | THE LAURISTON
3-bedroom townhouse
<i>Driveway parking</i> |  | THE KENMORE
2-bedroom semi-detached house
<i>Driveway parking</i> |
|  | THE DUNBAR
4-bedroom detached house
<i>Integral single garage</i> |  | THE FENTON
3-bedroom semi-detached
or terraced house
<i>Driveway parking</i> | | |

Images shown are for illustrative purposes only. Although Story Homes has taken all reasonable care in the preparation of the contents of this brochure to ensure the accuracy of the information contained in it, such information can be subject to change and we do not warrant its accuracy. We continuously review our products for improvement and development so individual features may vary from time to time. We may also re-plan developments resulting in a change to the layout, house types and road layout. These particulars are therefore for general guidance only and do not constitute a contract or warranty. You should take appropriate steps to verify any information on which you intend to rely and in order to do so we would advise you to speak to a Sales Executive.





THE NEWTON

4-bedroom detached house with detached single garage
Total floor area: 1945 sq ft



GROUND FLOOR

Lounge:	4817 x 3987	[15'-8" x 12'-11"]
Kitchen/breakfast:	5993 x 3042	[19'-6" x 9'-11"]
Dining room:	4305 x 4161	[14'-0" x 13'-6"]
Family:	4201 x 3268	[13'-8" x 10'-7"]

FIRST FLOOR

Master bedroom:	4957 x 3521	[16'-1" x 11'-5"]
Bedroom 2:	5034 x 2895	[16'-4" x 9'-5"]
Bedroom 3:	3653 x 3321	[11'-10" x 10'-10"]
Bedroom 4:	4180 x 3329	[13'-7" x 10'-10"]

Please note CGIs are for illustrative purposes only; external finishes including roof tile colours, brick, stone, render and landscaping may vary between plots. Properties may also be built 'handed' (mirror image) of those illustrated. Story Homes reserves the right to alter and change certain aspects of a property – therefore it is recommended that you speak to a Sales Executive for further details. All dimensions are taken from the widest and longest points of each room; they are approximate and should not be used for carpet sizes, appliance spaces or furniture. These particulars do not form part of a contract or warranty.



THE DUNBAR

4-bedroom detached house with integral single garage
Total floor area: 1311 sq ft



GROUND FLOOR

Lounge:	3605 x 4639	[11'-9" x 15'-1"]
Kitchen/dining:	7655 x 2977	[24'-11" x 9'-8"]

FIRST FLOOR

Master bedroom:	3605 x 4701	[11'-9" x 15'-3"]
Bedroom 2:	3780 x 2719	[12'-3" x 8'-10"]
Bedroom 3:	3061 x 2736	[9'-11" x 8'-11"]
Bedroom 4:	2988 x 2184	[9'-9" x 7'-1"]

Please note CGIs are for illustrative purposes only; external finishes including roof tile colours, brick, stone, render and landscaping may vary between plots. Properties may also be built 'handed' (mirror image) of those illustrated. Story Homes reserves the right to alter and change certain aspects of a property – therefore it is recommended that you speak to a Sales Executive for further details. All dimensions are taken from the widest and longest points of each room; they are approximate and should not be used for carpet sizes, appliance spaces or furniture. These particulars do not form part of a contract or warranty.



THE LAURISTON

3-bedroom townhouse with driveway parking
Total floor area: 1163 sq ft

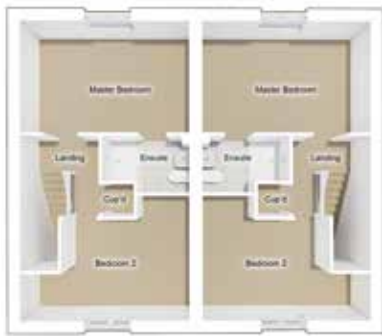

GROUND FLOOR

Dining/family room:
4490 x 2856 [14'-7" x 9'-3"]
Kitchen:
2329 x 5024 [7'-7" x 16'-4"]

FIRST FLOOR

Lounge:
4490 x 3427 [14'-9" x 11'-2"]
Bedroom 3:
2330 x 2391 [7'-7" x 7'-9"]

SECOND FLOOR

Master bedroom:
4490 x 2928 [14'-7" x 9'-6"]
Bedroom 2:
4490 x 3277 [14'-7" x 10'-8"]

Please note CGIs are for illustrative purposes only; external finishes including roof tile colours, brick, stone, render and landscaping may vary between plots. Properties may also be built 'handed' (mirror image) of those illustrated. Story Homes reserves the right to alter and change certain aspects of a property – therefore it is recommended that you speak to a Sales Executive for further details. All dimensions are taken from the widest and longest points of each room; they are approximate and should not be used for carpet sizes, appliance spaces or furniture. These particulars do not form part of a contract or warranty.



THE FENTON

3-bedroom semi-detached or terraced house with driveway parking
Total floor area: 918 sq ft



GROUND FLOOR

Lounge: 4902 x 3631 [15'-11" x 11'-10"]
Kitchen/dining: 4714 x 3903 [15'-4" x 12'-8"]

FIRST FLOOR

Master bedroom: 4714 x 3057 [15'-4" x 9'-11"]
Bedroom 2: 3773 x 2427 [12'-3" x 7'-11"]
Bedroom 3: 2672 x 2199 [8'-8" x 7'-2"]

Please note CGIs are for illustrative purposes only; external finishes including roof tile colours, brick, stone, render and landscaping may vary between plots. Properties may also be built 'handed' (mirror image) of those illustrated. Story Homes reserves the right to alter and change certain aspects of a property – therefore it is recommended that you speak to a Sales Executive for further details. All dimensions are taken from the widest and longest points of each room; they are approximate and should not be used for carpet sizes, appliance spaces or furniture. These particulars do not form part of a contract or warranty.



THE KENMORE

2-bedroom semi-detached house with driveway parking
Total floor area: 685 sq ft

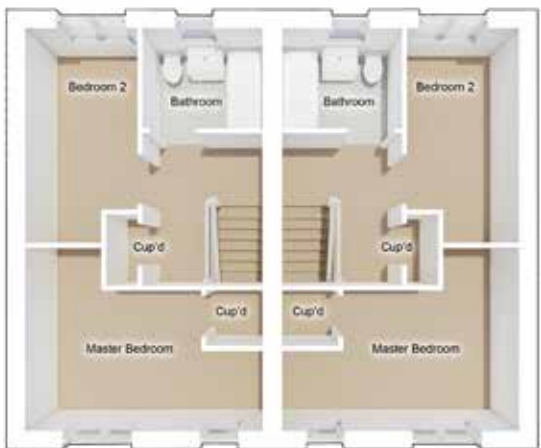

GROUND FLOOR

Lounge:	3403 x 4269	[11'-1" x 13'-10"]
Kitchen/dining:	3827 x 4269	[12'-5" x 13'-10"]

FIRST FLOOR

Master bedroom:	3296 x 4269	[10'-9" x 13'-10"]
Bedroom 2:	3883 x 2023	[12'-7" x 6'-7"]

Please note CGIs are for illustrative purposes only; external finishes including roof tile colours, brick, stone, render and landscaping may vary between plots. Properties may also be built 'handed' (mirror image) of those illustrated. Story Homes reserves the right to alter and change certain aspects of a property – therefore it is recommended that you speak to a Sales Executive for further details. All dimensions are taken from the widest and longest points of each room; they are approximate and should not be used for carpet sizes, appliance spaces or furniture. These particulars do not form part of a contract or warranty.

BUILD QUALITY
WITH NO
COMPARISON.



Image shown is for illustrative purposes only.

*STORY HOMES HAS BEEN BUILDING BEAUTIFUL HOMES
FOR OVER 30 YEARS ACROSS CUMBRIA, THE NORTH WEST,
NORTH EAST AND SOUTHERN SCOTLAND.*

*FOUNDED
IN 1987.*



As a family-owned business, our mission is to design and build quality homes that people aspire to live in. Homes designed for life, that are strong in both build and character.

We have been successfully building high quality homes that stand out from the crowd for over thirty years. We would not be where we are today without our people, our craftsmen, our suppliers, our charities and of course, our customers.

Our passion, commitment and enthusiasm drives our 'can do' attitude to be the best. We are one team, working together to 'do it right' and our exceptional quality and attention to detail runs through everything we do.

Fred Story



***WE ARE PASSIONATE ABOUT BUILDING HOMES
THAT WE ARE PROUD TO PUT OUR NAME TO.***

Customer satisfaction has always been one of our key strengths, and we regularly receive superb feedback from our customers which we use to help us make continuous improvements to our homes and our after-sales service.

TAKING CARE OF YOU

Our reputation is firmly built on the quality of our exceptional homes and our high standards of customer service. Before you move in, you'll be given a comprehensive 'Home Information File' that explains everything about your new home and what you can expect from our Customer Aftercare team.

You will also receive a home demonstration from your Site Manager, who will answer any questions you might have about your new Story home. Your Site Manager and your Sales Executive will become your main points of contact in the first few weeks of owning your brand new home.

GOING THE EXTRA MILE

We pride ourselves on providing a friendly, easily accessible, knowledgeable and efficient service for our customers. And as well as care and support from our Sales team during your purchase, our local and dedicated team of advisors and technicians will also be here to take care of you after you have moved in.

Your Site Manager will contact you in the days following completion, and then again during the first few weeks you are in your home. This is to ensure everything is as you would expect your new Story home to be.

Our Customer Aftercare team will call you directly to introduce themselves. We provide dedicated and responsive aftercare for two years after buying your Story home, in addition to your 10-year build warranty, so you can rest assured you are in safe, professional hands with us.

The Consumer Code for Home Builders was developed by the home-building industry and introduced in April 2010 to make the home buying process fairer and more transparent for purchasers. Find out more at www.consumercodeforhomebuilders.co.uk

**CONSUMER
CODE FOR
HOME BUILDERS**

www.consumercode.co.uk

***PRIDE IN
EVERYTHING
WE DO.***





*PUTTING
SUMMERPARK
ON THE MAP.*

*STAYING CLOSE BY, OR EXPLORING FURTHER.
YOU CAN EASILY EXPERIENCE EVERYTHING
THE AREA HAS TO OFFER.*

ATTRACTIONS

Gracefield Arts Centre	1.5 miles
Dumfries & County Golf Club	1.7 miles
Robert Burns House	1.6 miles
Robert Burns Centre Film Theatre	2.1 miles
Mabie Farm Park	1.9 miles

SCHOOLS

Dumfries High School	0.7 miles
Noblehill Primary School	1.0 miles
Dumfries Academy	1.4 miles
Loreburn Primary School	1.8 miles
St Michael's Primary School	1.9 miles

TRAVEL

A701	0.8 miles
A780	0.8 miles
A756	1.1 miles
A76	1.2 miles
A780	1.4 miles
Maxwelltown	1.5 miles
A711	1.6 miles
A709	2.0 miles
A75	2.5 miles

DIRECTIONS

Travelling north on the M6 (M) – follow the M6 (M) until you reach junction 22, exit at junction 22, take the A75 exit to south west Scotland/Dumfries/Stranraer/Gretna/B7076, continue onto the A75, at the roundabout, take the 2nd exit and stay on the A75 at the next roundabout, take the 1st exit onto the A709, travel along the A709 until you reach Gullane Way, turn right onto Gullane Way until you reach your destination Summerpark.

Travelling south on the A74 (M) – follow the M74 (M) until you reach junction 15, exit at junction 15 and take the A701 exit to Dumfries/Beattock/Moffat/Selkirk/A708, at the roundabout take the 3rd exit onto the A701, follow the A701 until you reach Catherinefield Road, turn right onto Catherinefield Road, follow Catherinefield Road until you reach the next roundabout at the roundabout take the 3rd exit onto the A709, travel along the A709 until you reach Gullane Way, turn right onto Gullane Way until you reach your destination Summerpark.

All distances are approximate. Images shown are for illustrative purposes only. Although Story Homes has made every effort to ensure accuracy of information contained in this brochure, we reserve the right to amend and update the specification or layout without prior notification. The information contained herein is for guidance only and its accuracy is not guaranteed. They do not constitute a contract, part of a contract or warranty. External finishes may vary from those shown and dimensions given are approximate (measured to the widest part) and we cannot be held responsible if sizes vary from those indicated. Please consult our Sales Executive with regards to the specification and specific plots. You should take appropriate advice to verify any information on which you wish to rely. SP/1219.

SUMMER PARK

DUMFRIES, DG1 3TP

01387 800813

Summer.Park@storyhomes.co.uk

STORYHOMES.CO.UK



STRONG • BEAUTIFUL