



ALASTAIR SAVILLE
ESTATE AGENTS

6 Kingsfield Road, Maghull

£195,000

🛏 2 🚿 1 🚗 1

- Semi Detached Bungalow
- Two Double Bedrooms
- Well Presented Throughout
- Kitchen With Separate Utility Room
- Shower Room
- Enclosed Lawned Rear Gardens
- Garage And Driveway
- Viewing Essential
- EPC Rating- C
- Council Tax Council- C



SEMI DETACHED BUNGALOW IN SOUGHT AFTER CUL DE SAC LOCATION, WELL PRESENTED THROUGHOUT, TWO DOUBLE BEDROOMS, KITCHEN WITH SEPARATE UTILITY ROOM, ENCLOSED GARDENS, GARAGE AND DRIVEWAY, CLOSE TO LOCAL AMENITIES. NO ONWARD CHAIN. VIEWING ESSENTIAL.

This semi detached bungalow is situated on Kingsfield Road, just off of Liverpool Road South, close to local shops and The Meadows Leisure Centre. Having been in the same ownership for a number of years, the property has been a superb home and will be for anyone looking to downsize. Being well presented throughout, the bungalow offers spacious accommodation and comprises entrance porch, hallway, lounge, two double bedrooms, shower room, kitchen and a utility room. Externally there are enclosed gardens to the rear which are mainly laid to lawn, as well as a driveway and a garage. This is an opportunity not to be missed. We would



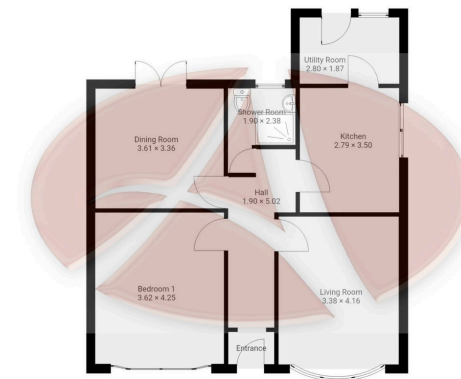

Ground floor area 68.2m²

6 Kingsfield Road, L31 7AL

Whilst every effort is made to accurately reproduce these floor plans, measurements are approximate, not to scale and for illustrative purposes only. Measurements, floor-areas, openings and orientations are approximate. They should purpose and do not form any part of an agreement. No liability is taken for any error or mis-statement. All parties must rely on their own inspections.

