



**Celestine Road, Yate Bristol BS37 5EA**



**welcome to**

## **Celestine Road, Yate Bristol**

\*\*\* NO CHAIN \*\*\* A three bedroom end of terrace home , offering the following accommodation: Entrance hall, cloakroom, lounge, kitchen / diner, three bedrooms and upstairs shower room. The property further offers front and rear gardens.

### **Entrance Hall**

Double glazed door to front. radiator, understairs storage.

### **Kitchen/Diner/Lounge**

Double glazed window to front and rear with access rear door to garden, wall and base units with worktops over, stainless steel sink and drainer, built in electric over and hob, space for washing machine , space for fridge freezer. wood effect flooring throughout. two radiators.

### **Landing**

Double glazed window to side, loft access, radiator.

### **Bedroom One**

Double glazed window to front , radiator.

### **Bedroom Two**

Double glazed window to rear, radiator.

### **Bedroom Three**

Double glazed window to front, radiator.

### **Main Bathroom**

Double glazed windows to rear, W/C, hand wash basin with storage, bath with shower over, heated towel rail. extractor fan. tiled flooring.

### **Rear Garden**

Patio area , lawn to path, shed for storage.

### **Front Garden**

gate access with lawn laid to path leading to front of property.

### **Parking**

Ample parking to the rear.

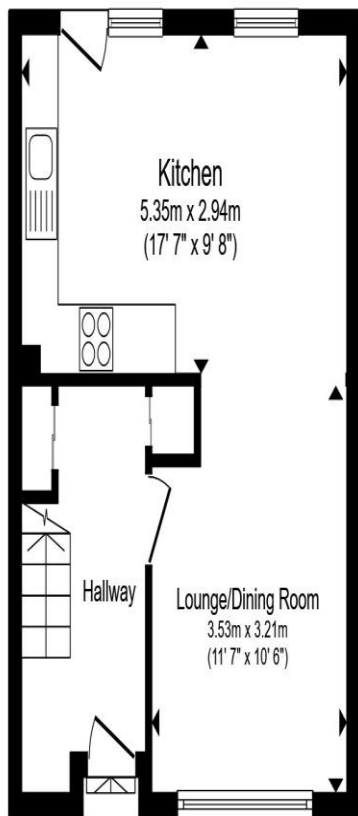

**Ground Floor**

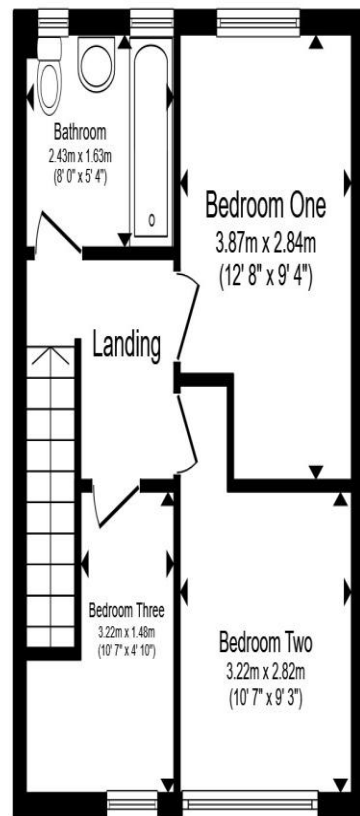

**First Floor**



**Outbuilding**

Total floor area 74.6 m<sup>2</sup> (802 sq.ft.) approx

This floor plan is for illustrative purposes only. It is not drawn to scale. Any measurements, floor areas (including any total floor area), openings and orientation are approximate. No details are guaranteed, they cannot be relied upon for any purpose and they do not form part of any agreement. No liability is taken for any error, omission or misstatement. A party must rely upon its own inspection(s). Powered by [www.propertybox.io](http://www.propertybox.io)



**welcome to**  
**Celestine Road,**  
**Yate Bristol**

- NO CHAIN
- END-TERRACED
- THREE BEDROOMS
- OPEN PLAN KITCHEN/DINER/LOUNGE
- AMPLE PARKING

Tenure: Freehold EPC Rating: C  
Council Tax Band: B

offers in the region of  
**£280,000**



**view this property online** [allenandharris.co.uk/Property/CPS105366](https://allenandharris.co.uk/Property/CPS105366)



Property Ref:  
CPS105366 - 0002

1. MONEY LAUNDERING REGULATIONS Intending purchasers will be asked to produce identification documentation at a later stage and we would ask for your co-operation in order that there is no delay in agreeing the sale. 2. These particulars do not constitute part or all of an offer or contract. 3. The measurements indicated are supplied for guidance only and as such must be considered incorrect. Potential buyers are advised to recheck measurements before committing to any expense. 4. We have not tested any apparatus, equipment, fixtures or services and it is in the buyers interest to check the working condition of any appliances. 5. Where an EPC, or a Home Report (Scotland only) is held for this property, it is available for inspection at the branch by appointment. If you require a printed version of a Home Report, you will need to pay a reasonable production charge reflecting printing and other costs. 6. We are not able to offer an opinion either written or verbal on the content of these reports and this must be obtained from your legal representative. 7. Whilst we take care in preparing these reports, a buyer should ensure that his/her legal representative confirms as soon as possible all matters relating to title including the extent and boundaries of the property and other important matters before exchange of contracts.

Allen & Harris is a trading name of Sequence (UK) Limited which is registered in England and Wales under company number 4268443, Registered Office is Cumbria House, 16-20 Hockliffe Street, Leighton Buzzard, Bedfordshire, LU7 1GN. VAT Registration Number is 500 2481 05.

  
**allen & harris**



**01454 318387**



[ChippingSodbury@allenandharris.co.uk](mailto:ChippingSodbury@allenandharris.co.uk)



7 High Street, Chipping Sodbury, BRISTOL,  
Avon, BS37 6BA



**[allenandharris.co.uk](https://allenandharris.co.uk)**