



Symonds
& Sampson

East Street

West Coker, Yeovil

PARKING
HERE
WILL CAUSE
DISTURBANCE

East Street

West Coker
Yeovil
BA22 9BE



- Charming Stone Period Cottage
 - Recently Modernised
- Sitting/dining Room with Woodburner
 - Kitchen
 - Bathroom
- Bedroom One with En Suite WC
 - Second Floor Bedroom Two
 - Front & Rear Gardens
 - No Onward Chain



Guide Price £275,000

Freehold

Yeovil Sales
01935 423526
yeovil@symondsandsampson.co.uk



ACCOMMODATION

The property is approached through a gateway to the front garden with a pathway leading to the front entrance door which leads directly into a pretty and spacious living room with a stone mullion window to the front, oak beams and an exposed stone fireplace with oak lintel and inset woodburning stone. There is partial Flagstone flooring and a large Flagstone hearth to the fireplace, stairs rising to the first-floor accommodation and a door at the back of the living room leading into the kitchen. The kitchen has been refaced with a range of wall floor and drawer units in a cream finish under a woodblock worktop with an inset sink and drainer, an electric oven with a halogen hob above and a stainless steel extractor hood. There is plumbing and space for a washing machine and white "subway" tiling in all splash-prone areas. A door at the back of the kitchen leads to a rear porch where there is a further door accessing the garden and the door into the ground floor bathroom which is fitted with a white suite of low-level WC, wash hand basin and panel enclosed bath with a shower above.

On the first floor, a small landing gives access to the stairs to the second-floor bedroom and doorway into the master bedroom which has a stone mullion window to the front and a further casement window, and a door leading into an ensuite toilet with a low-level WC and a vanity unit wash hand basin. Taking the stairs up to the second floor a small

landing gives access via a door to bedroom two which has a skylight window and a hatch giving access to eaves storage space.

SITUATION

West Coker is one of the area's prettiest and most sought-after villages predominantly built of period properties from the local hamstone intermingled with more modern properties and small businesses. The range of amenities includes a school, doctor's surgery, primary school, public houses, restaurant/hotel and bar, butchers, village hall, garage, shops along with many clubs including tennis, cricket, gardening, cinema, youth, cubs, scouts, beavers, brownies and many more.

SERVICES

Electric Central Heating.

Broadband - Superfast broadband is available. Mobile signal/coverage - Available both indoors and outside - For an indication of specific speeds and supply or coverage in the area we recommend Ofcom checker.
<https://www.ofcom.org.uk>

OUTSIDE

To the rear of the property, the garden provides a paved patio area directly abutting the rear of the property, water

tap, stonewalling and steps leading up past a lovely raised lawn with a path to the rear of the garden and space for a storage shed with hardstanding. Pedestrian access leads out to Orchard Close and around to the front of the property.

The front garden has been laid mainly to gravel adjacent to the paved access path to the front entrance. There is a central raised flower bed with stonewalling.

DIRECTIONS

What3words:
///dollars.hotspots.newsreel

MATERIAL INFORMATION

The property is Grade II Listed and lies within a Conservation Area.

Council Tax Band: B

There is no flood risk for this property. This home is not at risk of flooding from rivers and seas.



Denotes restricted head height

West Coker, Yeovil

Approximate Area = 692 sq ft / 64.3 sq m

Limited Use Area(s) = 48 sq ft / 4.4 sq m

Total = 740 sq ft / 68.7 sq m

For identification only - Not to scale



GROUND FLOOR



FIRST FLOOR

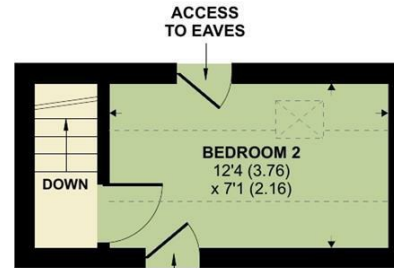

SECOND FLOOR

ACCESS TO EAVES



Floor plan produced in accordance with RICS Property Measurement Standards incorporating International Property Measurement Standards (IPMS2 Residential). © richecom 2024. Produced for Symonds & Sampson. REF: 1164739

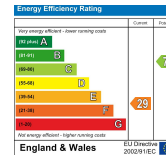

YEO/SH/16.09.2024

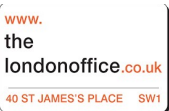

01935 423526

yeovil@symondsandsampson.co.uk
Symonds & Sampson, 2 Court Ash,
Yeovil, Somerset BA20 1HG



Important Notice: Symonds & Sampson LLP and their Clients give notice that: 1. They have no authority to make or give any representations or warranties in relation to the property. These particulars do not form part of any offer or contract and must not be relied upon as statements or representations of fact. 2. Any areas, measurements or distances are approximate. The text, photographs and plans are for guidance only and are not necessarily comprehensive. It should not be assumed that the properties have all necessary planning, building regulation or other consents and Symonds and Sampson LLP have not tested any services, equipment of facilities. 3. We have not made any investigation into the existence or otherwise of any issues concerning pollution of the land, air or water contamination and the purchaser is responsible for making his/her own enquiries in this regard. 4. The property is sold subject to and with the benefit of all existing wayleaves, easements and rights of way whether public or private, specifically mentioned or not. The vendors shall not be required to define any such rights, privileges or advantages.

SALES | LETTINGS | AUCTIONS | FARMS & LAND | COMMERCIAL | NEW HOMES | PLANNING & DEVELOPMENT