

Symonds
& Sampson



Grangefield

Sackmore Lane, Marnhull, Sturminster Newton, Dorset

Grangefield

Sackmore Lane
Marnhull
Sturminster Newton
Dorset DT10 1PN

Grangefield is a detached bungalow with plenty of parking, garage and workshop, level wrap around garden all in a highly convenient position within the village.



- Bungalow with spacious living space
- Fully updated in 2018 throughout including a new Conservatory.
- Short walk to local shops
- Parking for 4 cars and garage / workshop
- Possible loft extension creating a 3rd bedroom
 - No forward chain

Guide Price **£425,000**

Freehold

Sturminster Sales
01258 473766
sturminster@symondsandsampson.co.uk



THE DWELLING

A wonderful detached bungalow with a conservatory and sun room, new flooring throughout including oak flooring in the dining and sitting rooms and a wood burner installed in 2018 as well as many other upgrades at that time. The house is therefore presented beautifully with good flowing reception space and a well tended wrap around garden and parking. Conveniently, this spacious house is in a central village location, not adjacent to any planned housing development and a short walk to the shops on Burton Street.

ACCOMMODATION

See Floor Plan - possible loft conversion with lapsed planning permission (2018/0364/HOUSE).

OUTSIDE

The house is approached from the top end of Sackmore Lane and gives plenty of parking on the front and side drive. The garage has an up and over door and links into the good sized workshop which in turn has access back to the rear garden.

The house sits centrally in the plot and therefore the gardens wrap around giving different aspects throughout the day.

SITUATION

Marnhull is one of the largest villages in England with a thriving community life and is celebrated in Thomas Hardy's *Tess of the D'Urbervilles*. It has two public houses, two primary schools, three churches, doctors' surgery, pharmacy, carpet and soft furnishing shop, two grocery shops (one with a post office), hairdresser and beauty salon. There are many clubs and societies, and it is surrounded by beautiful countryside.

DIRECTIONS

What3words:///blanks.butternut.loves

SERVICES

Mains water and drainage, mains electricity. Leased solar panels were installed in 2011 for a lease of 25 years and 3 months. Our client has calculated an approximate £7,040 cost to buy out this lease. Heating is modernised night storage heaters (Economy 10) and programmable individual electric radiators.

MATERIAL INFORMATION

Standard, superfast & ultrafast broadband is available. Mobile phone network coverage is limited inside and likely outside

(Information from Ofcom <https://www.ofcom.org.uk>)

Council Tax Band: E



Sackmore Lane, Marnhull, Sturminster Newton

Approximate Area = 1424 sq ft / 132.2 sq m

Garage = 156 sq ft / 14.4 sq m

Outbuilding = 158 sq ft / 14.6 sq m

Total = 1891 sq ft / 175.6 sq m

For identification only - Not to scale

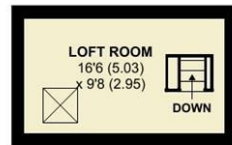

FIRST FLOOR



GROUND FLOOR

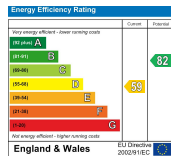
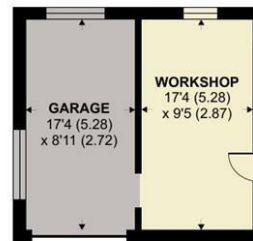

Floor plan produced in accordance with RICS Property Measurement Standards incorporating International Property Measurement Standards (IPMS2 Residential). © nidecom 2023. Produced for Symonds & Sampson. REF: 988577



September 2025



01258 473766

sturminster@symondsandsampson.co.uk
Symonds & Sampson LLP
Agriculture House, Market Place,
Sturminster Newton, Dorset DT10 1AR



Important Notice: Symonds & Sampson LLP and their Clients give notice that: 1. They have no authority to make or give any representations or warranties in relation to the property. These particulars do not form part of any offer or contract and must not be relied upon as statements or representations of fact. 2. Any areas, measurements or distances are approximate. The text, photographs and plans are for guidance only and are not necessarily comprehensive. It should not be assumed that the properties have all necessary planning, building regulation or other consents and Symonds and Sampson LLP have not tested any services, equipment or facilities. 3. We have not made any investigation into the existence or otherwise of any issues concerning pollution of the land, air or water contamination and the purchaser is responsible for making his/her own enquiries in this regard. 4. The property is sold subject to and with the benefit of all existing wayleaves, easements and rights of way whether public or private, specifically mentioned or not. The vendors shall not be required to define any such rights, privileges or advantages.

SALES | LETTINGS | AUCTIONS | FARMS & LAND | COMMERCIAL | NEW HOMES | PLANNING & DEVELOPMENT