



Building Plot at Bibberne Row, Lower Road, Stalbridge, Sturminster Newton, Dorset DT10 2QA

A building plot with approved outline planning permission for two semi-detached houses.

- Building plot with Outline PP for 2 dwellings
 - Sought after North Dorset town
 - Good road and rail connections nearby
- Edge of the town
- Easy access to High Street
- Lovely surrounding countryside

Guide Price **£200,000**

Freehold

Stalbridge is Dorset's smallest town boasting a busy traditional High Street with many shops and businesses including post office, butcher, hairdresser, dentist, cycle shop and busy local supermarket. Many businesses are second or third generation family run and help to provide an excellent community which also has a church and primary school. The market town of Sturminster Newton is approximately 6 miles to the south and the larger towns of Shaftesbury, Sherborne and Wincanton are within a 20 minute drive. Road links are excellent with the A30 at Henstridge and A303 at Wincanton and Templecombe (3.5 miles) has a mainline railway to London Waterloo. The surrounding area has an abundance of good quality schools and some of the finest countryside with excellent walking, cycling and riding. The coast at Bournemouth/Poole is within an hour's drive.

what 3 words///forklift.coveted.adjusting

Mains water and electricity are nearby and will need to be connected to the site.

During daylight hours with particulars to hand.

Outline Planning Permission was granted by Dorset Council on 18th March 2025 - P/OUT/2025/00063 - for the erection of two dwellings (outline application with all matters reserved).

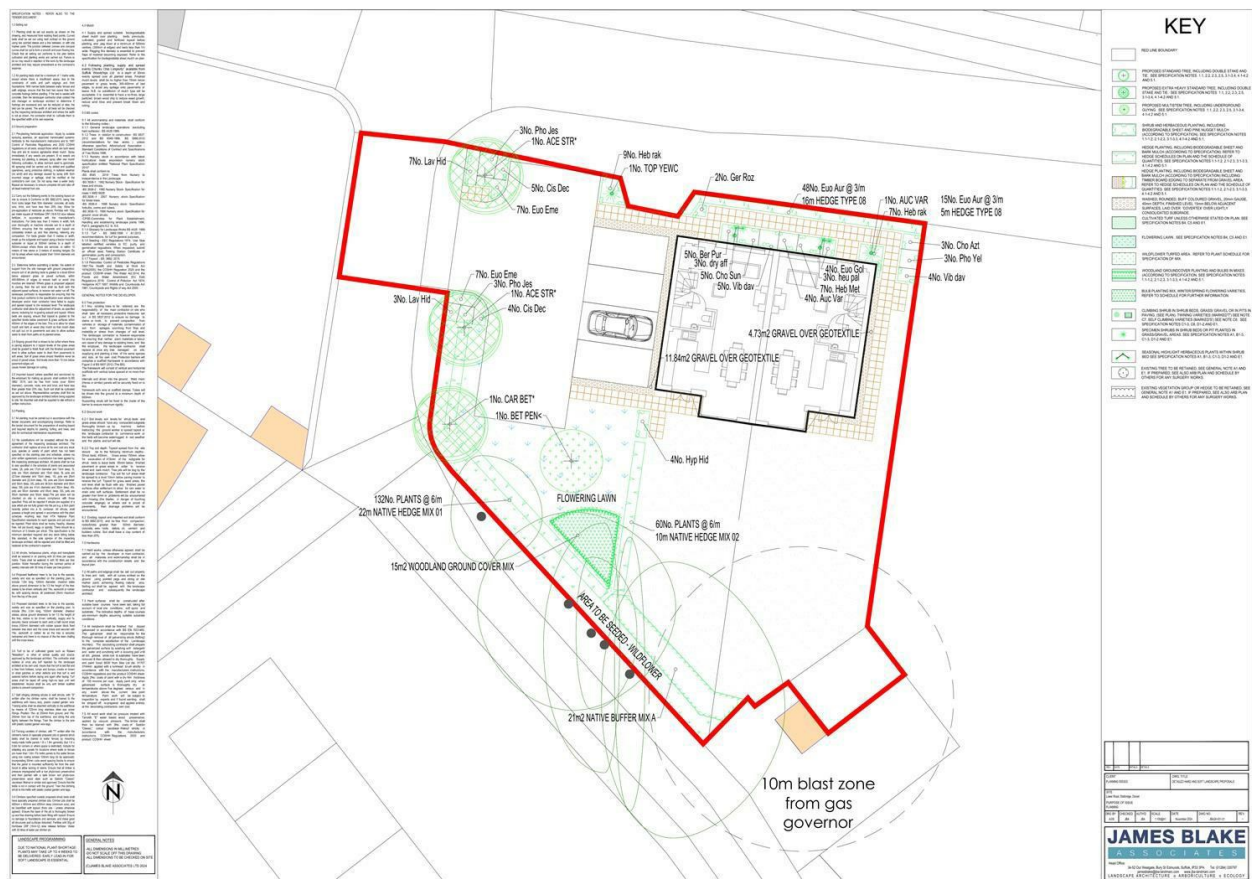

GWB June 2025



01258 473766

sturminster@symondsandsampson.co.uk
Symonds & Sampson LLP
Agriculture House, Market Place,
Sturminster Newton, Dorset DT10 1AR



Important Notice: Symonds & Sampson LLP and their Clients give notice that: 1. They have no authority to make or give any representations or warranties in relation to the property. These particulars do not form part of any offer or contract and must not be relied upon as statements or representations of fact. 2. Any areas, measurements or distances are approximate. The text, photographs and plans are for guidance only and are not necessarily comprehensive. It should not be assumed that the properties have all necessary planning, building regulation or other consents and Symonds and Sampson LLP have not tested any services, equipment or facilities. 3. We have not made any investigation into the existence or otherwise of any issues concerning pollution of the land, air or water contamination and the purchaser is responsible for making his/her own enquiries in this regard. 4. The property is sold subject to and with the benefit of all existing wayleaves, easements and rights of way whether public or private, specifically mentioned or not. The vendors shall not be required to define any such rights, privileges or advantages.

SALES | LETTINGS | AUCTIONS | FARMS & LAND | COMMERCIAL | NEW HOMES | PLANNING & DEVELOPMENT