



## Sandhills Farm, Fifehead Neville, Sturminster Newton, Dorset

Type: House - Detached    Bedrooms: 7    Bathrooms: 4  
Council Tax Band: E    EPC: D

A detached house of over 4000 sq ft with fine far-reaching views and southerly aspect along with adjoining field. In all 5.54 acres.

Guide Price  
**£950,000**  
Freehold





# Sandhills Farm, Fifehead Neville, Sturminster Newton, Dorset, DT10 2AJ

- Detached family house of over 4000 sq ft
- Semi rural location with wonderful views
  - 7 bedrooms, 4 bathrooms (2 ensuite)
  - 29' dual aspect sitting room
  - 23' kitchen / breakfast room
- Master bedroom with balcony
  - South facing garden
- Adjoining field. In all 5.54 acres
- Scope to update and put own stamp on

Viewing strictly by appointment through Symonds & Sampson Sturminster Sales Office on 01258 473766

Sandhills Farm is believed to have been built in the 1950s of brick elevations under a pitched tiled roof. Internally the house has extremely spacious family accommodation with a 29' sitting room and 24' kitchen being of particular note.

On the first floor there are seven bedrooms, two with ensuite bath / shower rooms, and two further bathrooms. The master bedroom has a balcony which takes full advantage of the fantastic views out to Bulbarrow and the surrounding countryside.

## Situation

Fifehead Neville is a hamlet close to the village of Hazelbury Bryan, situated in mid Dorset and surrounded by rolling, lightly wooded countryside. Hazelbury Bryan has a pub and village shop, the situation is unspoilt and peaceful. It is about 4 miles from Sturminster Newton which offers an excellent range of facilities; the old market square retains its appeal with an array of individual shops which include an excellent butcher/delicatessen, greengrocer, electrical retailer and the renowned Harts emporium. The larger centres of Sherborne, Bournemouth, Poole and Bath are all within easy commuting distance. The surrounding countryside is some of the finest in the country and designated as an Area of Outstanding Natural Beauty; the Blackmore Vale retains its rural character and provides an abundance of excellent walking and riding.

## Directions

From Sturminster Newton follow the road to Hazelbury Bryan and Sandhills Farm will be found behind double wooden gates on the left hand side after about 3 miles.

What 3 words ///snow.anchorman.hillside

## Outside

The property is approached from the road via double wooden gates on to a drive where there is ample parking and turning for a number of cars. The main garden is to the rear of the house and south facing. The land lies to the south and east of the house and is about 5 acres of gently sloping pasture which is a haven for wildlife. In all 5.54 acres.

## Services

Mains water and electricity are connected to the property. Private drainage. Oil fired central heating system.

## Local Authority

Dorset Council Tel: 01305 221000  
Council Tax Band: E

## Property Information

Broadband - Standard & Ultrafast broadband is available.  
Mobile phone coverage - Mobile phone coverage is available inside and outside – (coverage is best provided by Three Network) (Information from Ofcom <https://www.ofcom.org.uk>)

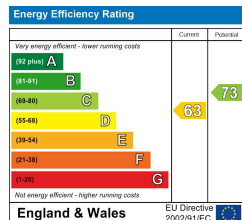
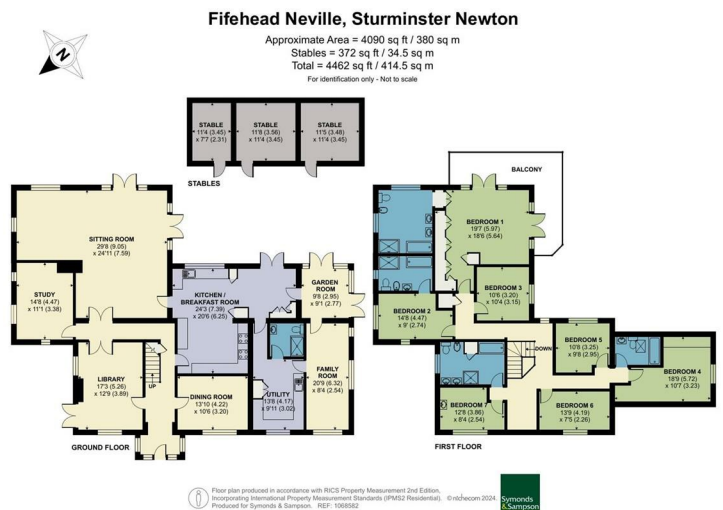

**GWB September 2024**



01258 473766

Symonds & Sampson LLP  
Agriculture House Market Place, Sturminster Newton,  
Dorset, DT10 1AR  
sturminster@symondsandsampson.co.uk  
www.symondsandsampson.co.uk

IMPORTANT NOTICE: Symonds & Sampson LLP and their Clients give notice that:

1. They have no authority to make or give any representations or warranties in relation to the property. These particulars do not form part of any offer or contract and must not be relied upon as statements or representations of fact. 2. Any areas, measurements or distances are approximate. The text, photographs and plans are for guidance only and are not necessarily comprehensive. It should not be assumed that the property has all necessary Planning, Building Regulation or other consents, and Symonds & Sampson have not tested any services, equipment, or facilities.

