



Steaming, Shillingstone, Blandford Forum, Dorset

Guide Price
£750,000

**Symonds
& Sampson**
ESTABLISHED 1858

An unspoilt smallholding with scope to improve situated in a quiet lane on the edge of the village.

Steaming
Lanchards Lane, Shillingstone,
Blandford Forum, Dorset, DT11 0QU

Village centre 0.3 miles
Blandford 6 miles, Bournemouth 24 miles

- Peaceful edge of village location
- Detached bungalow with scope to improve
 - Agricultural Occupancy Condition
- Double aspect sitting room and 3 bedrooms
 - Integral garage and brick outbuilding
 - Two steel frame barns
- Class Q development potential (subject to consent)
 - Level and gently sloping permanent pasture
 - In all 13.63 acres (5.51 hectares)
 - Freehold with vacant possession

Viewing strictly by appointment with our
Sturminster Newton office 01258 472244





Situation

Steaming is located on Lanchards Lane, a charming and quiet lane within a short drive or walk along lanes or across fields to the village centre.

Shillingstone village boasts a Co-op store, primary school, garage and fuel station and The Old Ox Inn.

The market town of Sturminster Newton (4 miles) and Georgian town of Blandford Forum (6 miles) offer a good range of retail, education, recreational and commercial facilities.

There is an abundance of leisure and recreational facilities in the area including the North Dorset Trailway in the village for walking and cycling. Golf courses at Ashley Wood, Rushmore and Bulbury Woods. Water sports on the Jurassic coast and excellent horse riding direct into Blandford Forest. The area is well known for many excellent schools in both the state and private sectors.

Directions

what3words /// adopt.fruitcake.makeup



The Dwelling

A detached bungalow of brick elevations under a tiled roof, constructed for the vendor's grandfather in 1985 who was a farmer and steam engine enthusiast, hence the name. Retaining many of the original features, the bungalow lends itself to improvement, incorporation of the garage and extending, subject to consent.

The present accommodation includes a double aspect sitting room with bay window and stone surround fireplace, an open plan kitchen/diner, 3 bedrooms (2 double) and a very practical hall, wc and conservatory. The integral garage lends itself to incorporation.

Outside

The bungalow has a large tarmac surface drive to a useful brick outbuilding. To the front and rear are lawned gardens with an ornamental pond and smattering of conifer and garden trees.

The Farm Buildings

Enjoying a separate access off Lanchards Lane are two farm buildings, constructed in the mid 1980's. Measuring 60' x 30' (18.1m x 9.2m) and 45' x 24' (13.7m x 7.3m) both buildings are of steel frame construction under asbestos roofs and fully enclosed with concrete block, timber yorkshire boarding and steel box profile walls. Both barns have a stone floor and full height metal sheeted door making them very secure. There is also a 16' (4.8m) timber lean-to and stoned yard area.

Eminently suited to agricultural and equestrian use, the buildings also offer scope for Class Q residential conversion, subject to consent.

The Land

Divided into 2 fields with another lane entrance, the land is level and gently sloping and down to permanent pasture. The soil is fertile greensand, making it suitable for a range of agricultural, equestrian and horticultural uses. The land is

bounded by mature hedgerows and a small stream along the western boundary of the small field.

There are lovely views from the land to Okeford Hill and Hambleton Hill.

Planning

The dwelling was granted consent in 1984 subject to conditional stating "the occupation of the dwelling shall be limited to a person solely or mainly employed or last employed in the locality in agriculture or in forestry". It is understood there is also a Section 52 agreement tying the bungalow to the holding, meaning the property cannot be divided, without consent.

Services

Separately metered mains electricity and water to the bungalow and farm buildings. Septic tank and soakaway drainage.

Local Authority

Dorset Council. Tax Band: D



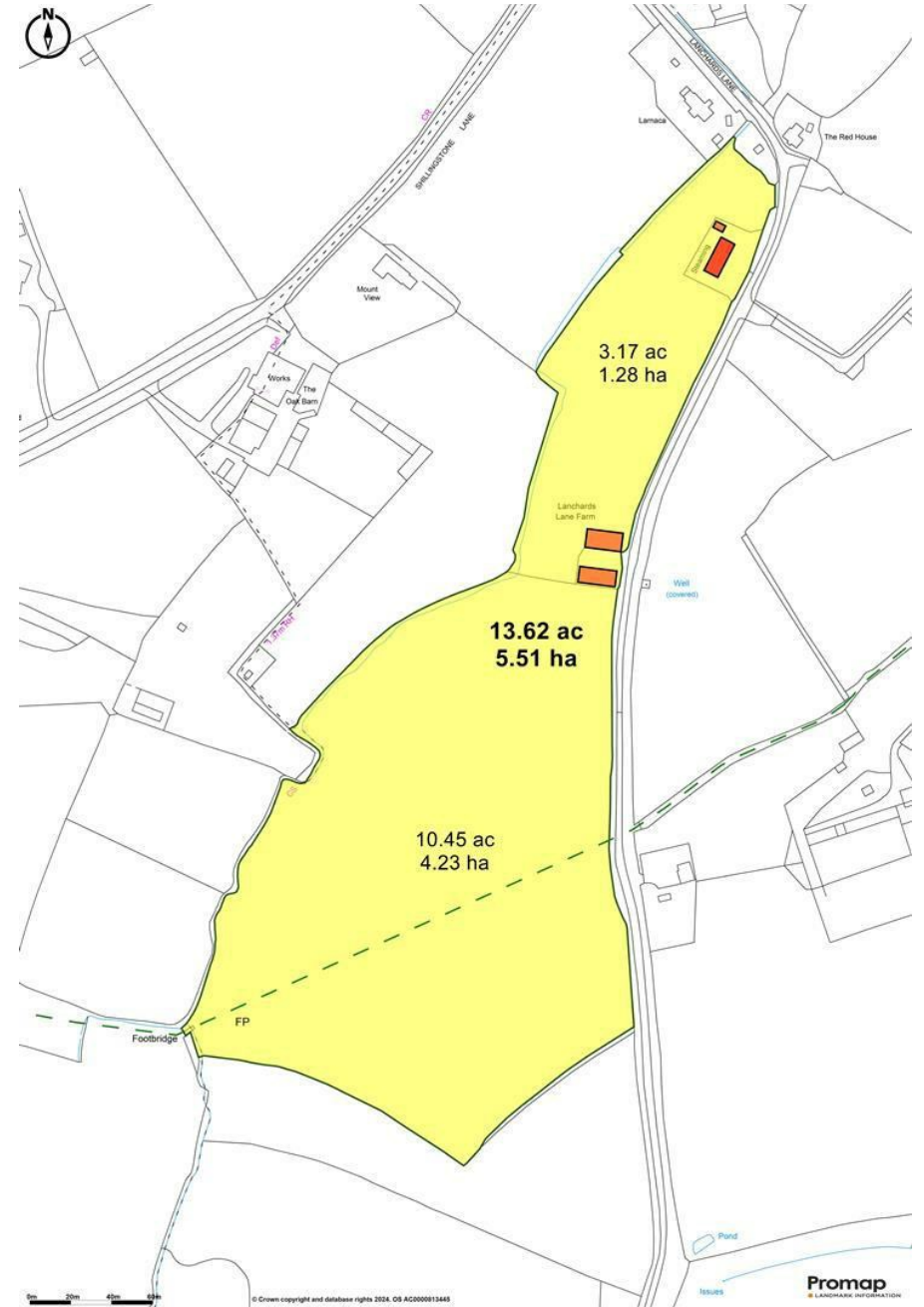

Steaming, Lanchards Lane, Shillingstone, Blandford Forum

Approximate Area = 1481 sq ft / 137.6 sq m

Outbuilding = 150 sq ft / 13.9 sq m

Total = 1631 sq ft / 151.5 sq m

For identification only - Not to scale

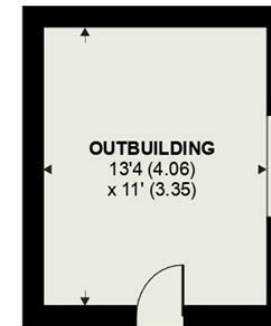

GROUND FLOOR



Floor plan produced in accordance with RICS Property Measurement Standards incorporating International Property Measurement Standards (IPMS2 Residential). © nlschem 2024. Produced for Symonds & Sampson. REF: 1115662



Energy Efficiency Rating		Current	Potential
Very energy efficient - lower running costs	A		81
102-110	B		
89-101	C	66	
69-88	D		
50-68	E		
35-49	F		
1-34	G		
Not energy efficient - higher running costs			

England & Wales EU Directive 2002/91/EC

Symonds & Sampson

ESTABLISHED 1858

01258 472244

Symonds & Sampson LLP

Agriculture House Market Place, Sturminster Newton, Dorset, DT10 1AR

sturminster@symondsandsampson.co.uk

IMPORTANT NOTICE: Symonds & Sampson LLP and their Clients give notice that:

1. They have no authority to make or give any representations or warranties in relation to the property. These particulars do not form part of any offer or contract and must not be relied upon as statements or representations of fact. 2. Any areas, measurements or distances are approximate. The text, photographs and plans are for guidance only and are not necessarily comprehensive. It should not be assumed that the property has all necessary Planning, Building Regulation or other consents, and Symonds & Sampson have not tested any services, equipment, or facilities.

