



20 Grange Avenue, Dronfield Woodhouse, Dronfield, S18 8PH

Saxton Mee

20 Grange Avenue

Dronfield Woodhouse

£225,000

Perfectly suited for a first time buyer, young family or divorcee is this well maintained and nicely presented two bedroomed semi detached house which stands towards the head of a small cul-de-sac, being ideally located for a host of local amenities including shops, park, infants and junior schools and easy access into Dronfield town centre.

Benefitting from uPVC double glazing and an Ideal gas fired combination boiler which was fitted around 2020, the accommodation briefly comprises of an entrance porch, good size living room, excellent dining kitchen, first floor landing off which opens two bedrooms and a stunning bathroom which has been refurbished during recent years.

Outside: Driveway, single brick built garage, enclosed low maintenance rear garden with Indian stone patio, paving and excellent store behind the garage.



- Ideal for first time buyer/young family/divorcee
- Favourably located on a quiet cul-de-sac
- Recently fitted boiler and stunning bathroom
- Drive and detached garage
- Low maintenance garden with Indian stone patio
- Two bedrooms
- Good size dining kitchen
- Viewing recommended
- EPC:
- Council Tax Band: Tenure:





20 GRANGE AVENUE

APPROXIMATE GROSS INTERNAL AREA = 59 SQ M / 635 SQ FT

GARAGE (EXCLUDING STORAGE) = 8.4 SQ M / 90 SQ FT

TOTAL = 67.4 SQ M / 725 SQ FT

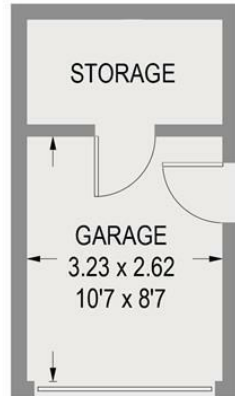

(NOT SHOWN IN ACTUAL
LOCATION / ORIENTATION)

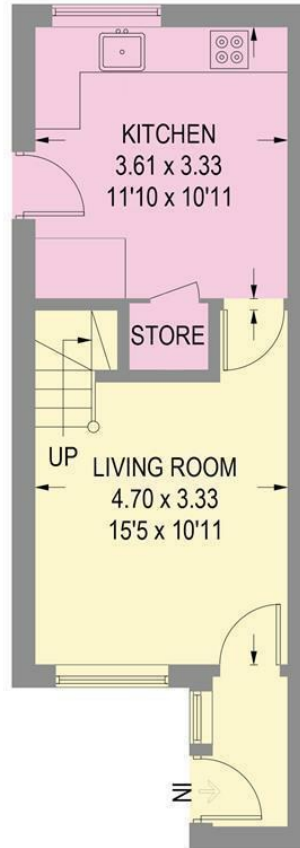

GROUND FLOOR
30.7 SQ M / 330 SQ FT

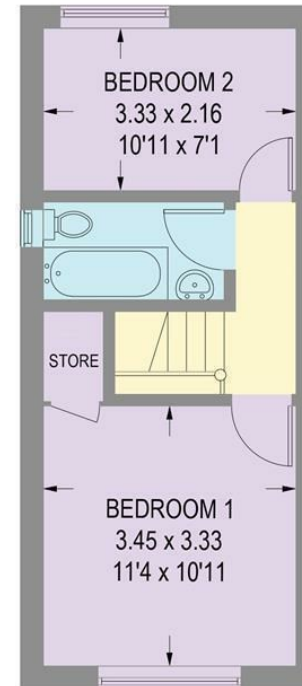

FIRST FLOOR
28.3 SQ M / 305 SQ FT

Illustration for identification purposes only, measurements are approximate, not to scale.

While we endeavour to make our sales particulars fair, accurate and reliable, they are only a general guide to the property and, accordingly, if there is any point, which is of particular importance to you, please contact the relevant office. The Agents have not tested any apparatus, equipment, fittings or services and so cannot verify they are in working order. The buyer is advised to obtain verification. Please note all the measurement details are approximate and should not be relied upon as exact. All plans, floor plans and maps are for guidance purposes only and are not to scale. Under no circumstances should they be relied upon as exact or for use in planning carpets and other such fixtures, fittings or furnishings. YOUR HOME IS AT RISK IF YOU DO NOT KEEP UP REPAYMENTS ON A MORTGAGE OR OTHER LOAN SECURED ON IT. 'A Life Assurance policy may be requested.' 'Written Quotations of credit terms available on request.'

Banner Cross
T: 0114 268 3241
E: bannercross@saxtonmee.co.uk
www.saxtonmee.co.uk

Dronfield
T: 01246 290992
E: dronfield@saxtonmee.co.uk

Hathersage
T: 01433 650009
E: hathersage@saxtonmee.co.uk

Bakewell
T: 01629 815307
E: bakewell@saxtonmee.co.uk

Matlock
T: 01629 828250
E: matlock@saxtonmee.co.uk

Saxton Mee