



27 Holmley Bank, Dronfield, S18 2HP

Saxton Mee

27 Holmley Bank

Offers Around

£265,000

An excellent opportunity to acquire a TWO DOUBLE BEDROOMED detached bungalow having the benefit of a good sized private rear garden and larger than average garage.

Favourably located on a small cul de sac, the property offers gas central heating and double glazing - having been recently re-decorated with new carpets in the lounge, sun room, bedrooms and hall. The garage has had a new roof with a new boiler and re-wire during recent years.

The accommodation briefly comprises: Side entrance porch/utility, kitchen/breakfast room, inner hall, spacious lounge with doors into the large sun room extending along the rear of the property. Two double bedrooms and shower room with separate WC.

Outside sees a drive, garage, and good size lawned rear garden with patio and store.

- Cul de sac location
- Recently decorated and carpeted
- Two double bedrooms
- Pleasant gardens and open aspect
- Large sun room/.conservatory
- Close to local amenities
- Parking and garage
- EPC: D
- Tenure: Freehold
- Council Tax Band: C





27 HOLMLEY BANK

APPROXIMATE GROSS INTERNAL AREA = 80.7 Q M / 869 SQ FT
 GARAGE = 31.2 Q M / 336 SQ FT
 TOTAL = 111.9 Q M / 1205 SQ FT

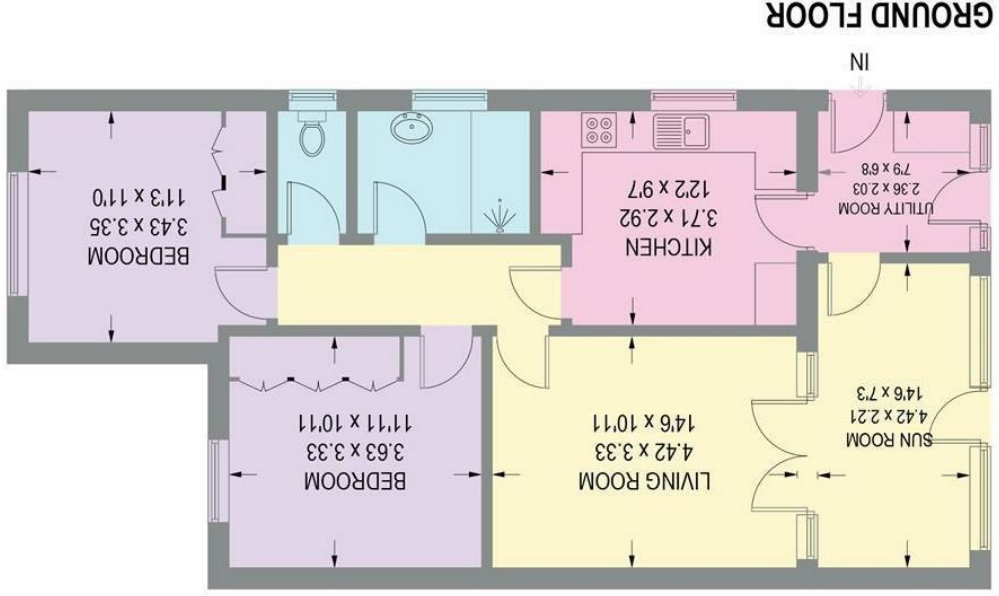
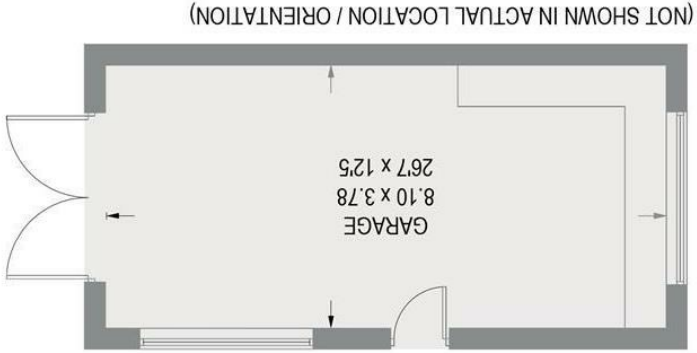

Illustration for identification purposes only, measurements are approximate, not to scale.

While we endeavour to make our sales particulars fair, accurate and reliable, they are only a general guide to the property and, accordingly, if there is any point, which is of particular importance to you, please contact the relevant office. The Agents have not tested any apparatus, equipment, fittings or services and so cannot verify they are in working order. The Buyer is advised to obtain verification. Please note all the measurement details are approximate and should not be relied upon as exact. All plans, floor plans and maps are for guidance purposes only and are not to scale. Under no circumstances should they be relied upon as exact or for use in planning carpets and other such fixtures, fittings or furnishings. YOUR HOME IS AT RISK IF YOU DO NOT KEEP UP REPAYMENTS ON A MORTGAGE OR OTHER LOAN SECURED ON IT. A Life Assurance policy may be requested. Written Quotations of credit terms available on request.

Banner Cross
 T: 0114 268 3241
 E: bannercross@saxtonmee.co.uk
 www.saxtonmee.co.uk

Dronfield
 T: 01246 290992
 E: dronfield@saxtonmee.co.uk

Hathersage
 T: 01433 650009
 E: hathersage@saxtonmee.co.uk

Bakewell
 T: 01629 815307
 E: bakewell@saxtonmee.co.uk

Matlock
 T: 01629 828250
 E: matlock@saxtonmee.co.uk

