

Winterfold Cottage

Farley Green, Albury, Surrey





An exquisite property set in the heart of Winterfold Heath in an extremely quiet and peaceful position in the Surrey Hills Area of Outstanding Natural Beauty.

Cranleigh 3 miles, Guildford 9 miles (London Waterloo 32 minutes), Clandon 7 miles (London Waterloo from 53 minutes), London 37 miles
Roads: A3 11 miles, M25 (Wisley Junction 10) 14 miles
Airports: London Heathrow 25 miles, London Gatwick 22 miles
(All distances and times are approximate)

5	4	5

Summary of accommodation

- Entrance hall | Drawing room | Study | Library | Family room | Dining room | Morning room | Kitchen/breakfast room | Porch | Pantry | Utility | Boot room | Cloakroom | WC
- Principal bedroom with balcony, en suite and two dressing rooms | Four further bedrooms and three bathrooms
- Gymnasium with shower room | Office | Music room
- Double garage | Bike store | Gardeners WC | Single garage | Carport | Pool plant room | Shed
- Swimming pool | Tennis court | Woodland garden | Large pond
- In all about 3.66 acres and 7009 sq ft
- There is a further 286.91 acres of surrounding woodland available by separate negotiation

Situation

Winterfold Cottage is positioned in a quiet, rural location in the heart of Winterfold Heath near Albury. Cranleigh a flourishing village is about 3 miles away and offers a wide range of traditional shops, supermarkets and a variety of boutique stores, restaurants, and public houses. Local recreation amenities include the leisure centre with a swimming pool, Cranleigh cricket and rugby clubs and Cranleigh Arts Centre. The very popular village of Shere is about 4 miles away with the smaller village of Farley Green under 2 miles away. Shere is a picturesque village which has two public houses, shops, restaurants, teashop, gallery and church as well as a wide range of other local businesses, village hall, a museum and surgery. In addition there is a village Lido as well as cricket and tennis clubs.

 Godalming, Haslemere and Cranleigh are all close by and offer good shopping and recreational facilities whilst the county town of Guildford is about 9 miles to the north. Communications in the area are extremely good with excellent road and rail connections all within easy reach.

 The A3 provides easy access to London to the north and the south coast and J10 of the M25 is approximately 14 miles away giving access to the national motorway network providing good access to London's international airports of Gatwick and Heathrow. The local mainline station is at Guildford, offering a fast service to London Waterloo taking approximately 32 minutes.

 The area has an excellent selection of schools including Cranleigh, St Catherine's Bramley, Charterhouse and Prior's Field at Godalming, Aldro at Shackleford and a number of other good private and state schools plus Guildford High School, Tormead and The Royal Grammar School in Guildford.

 Sporting facilities include racing at Sandown, Epsom and Ascot. Polo at Epsom and Cowdray Park as well as mixture of horseracing, golf and motorsports at Goodwood. Golf at numerous well-known courses throughout the area including the West Surrey at Godalming, Cranleigh Golf and Leisure, The Wisley near Ripley, Bramley and Liphook. There is local fishing at Willinghurst Estate. The surrounding area is renowned for its excellent network of bridleways and footpaths and offers many other opportunities for country pursuits.

Winterfold Cottage

Winterfold Cottage is an exquisite and highly sought-after property located in the heart of Winterfold Heath, Surrey. Nestled amidst the rolling hills of the Surrey Hills Area of Outstanding Natural Beauty (AONB), this charming property offers a rare combination of peaceful seclusion and convenient access to local amenities and transport links. The property is ideal for those looking to embrace a rural lifestyle without compromising on modern comforts.









FLOOR PLAN

Approximate Gross Internal Floor Area
Main House 4960 sq. ft / 460.81 sq. m
Garage 1118 sq. ft / 103.90 sq. m
Outbuildings 931 sq. ft / 86.46 sq. m
Total 7009 sq. ft / 651.17 sq. m

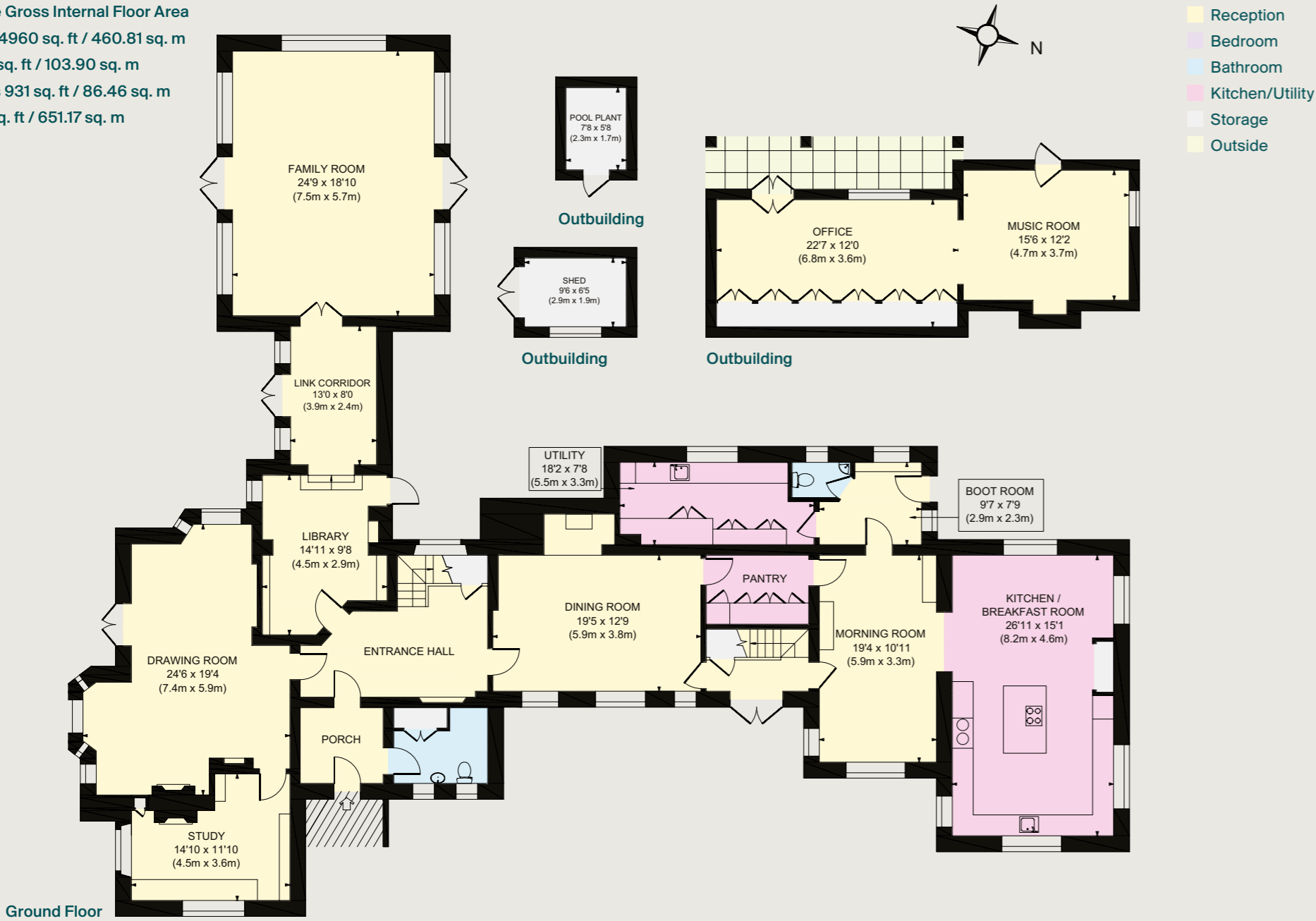

This plan is for guidance only and must not be relied upon as a statement of fact. Attention is drawn to the Important Notice on the last page of the text of the Particulars.

FLOOR PLAN

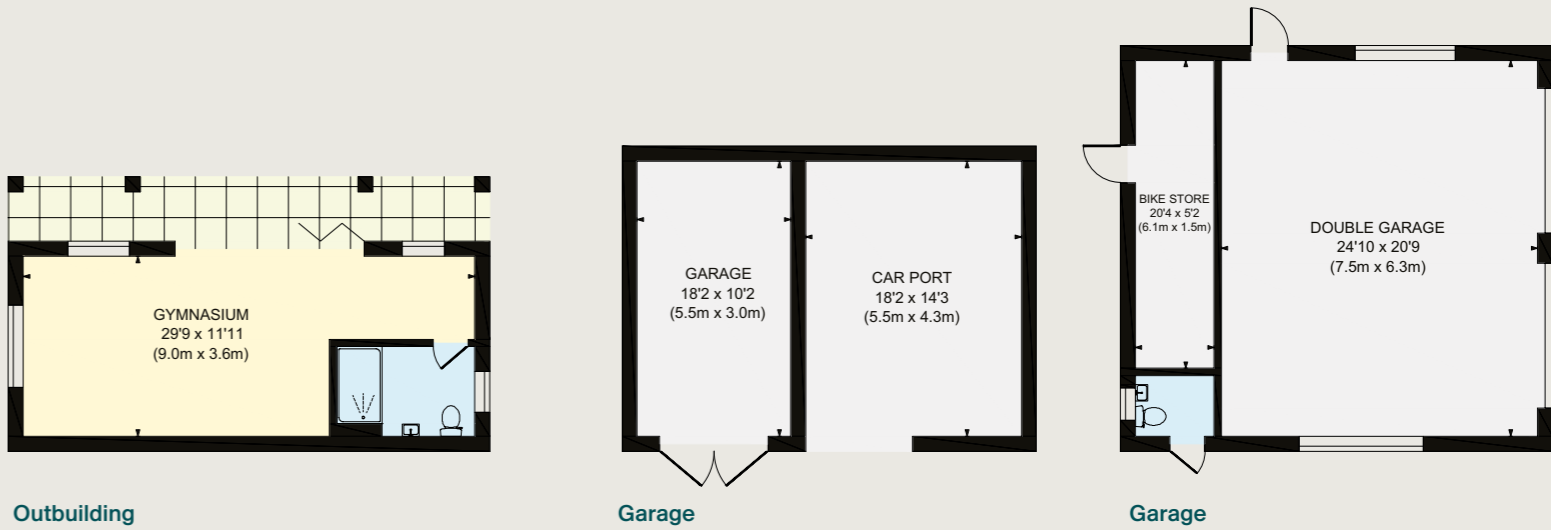







Property Information

Services: The client informs us that the property has mains electricity and water, oil fired central heating and private drainage.

Local Authority: Waverley Borough Council 01483 523333

Council Tax: Band H

EPC Rating: E

Directions

Postcode: GU5 9EL

What3words: ///trades.emails.nerd

Viewing

Viewing by prior appointment only with the agents Knight Frank.

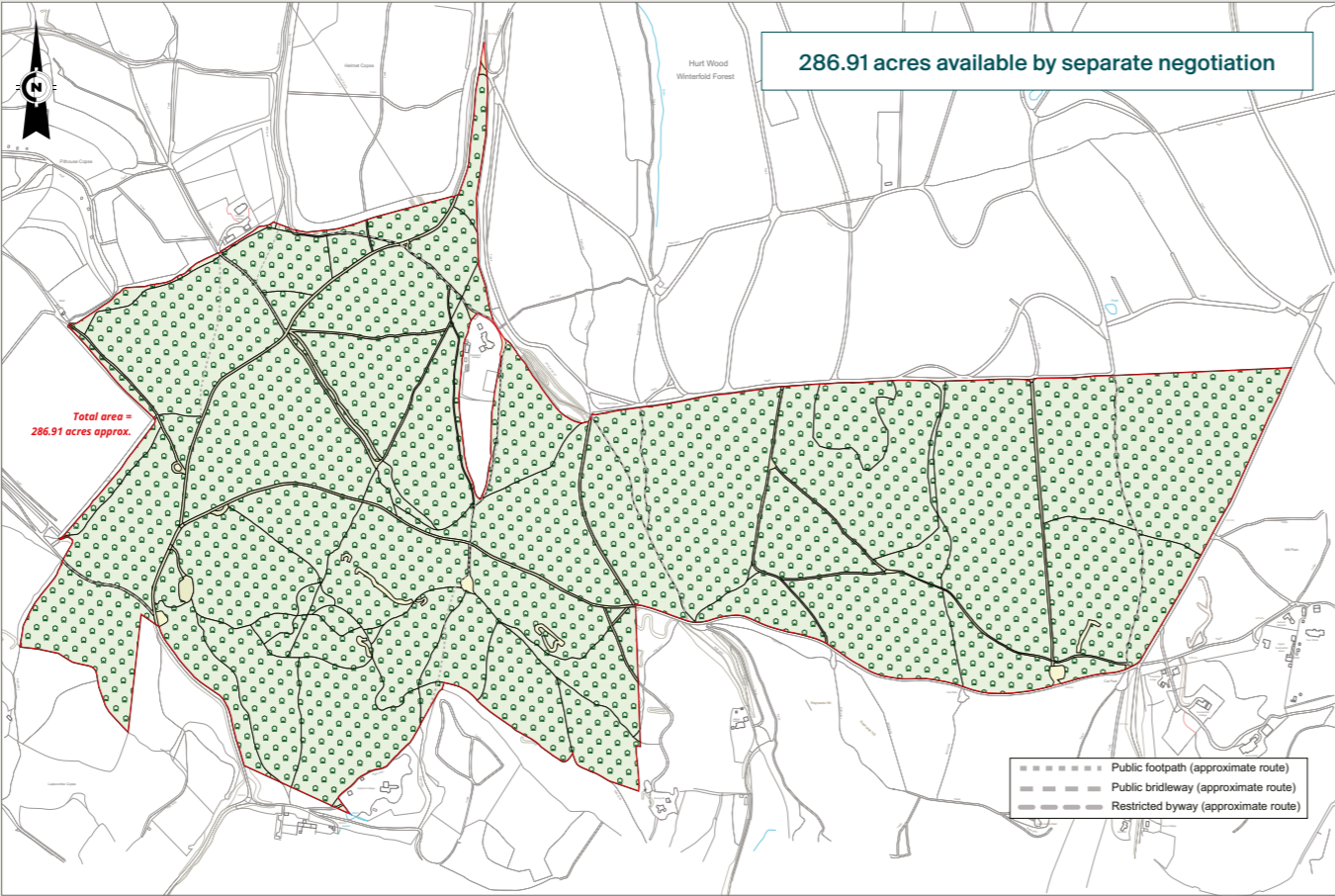
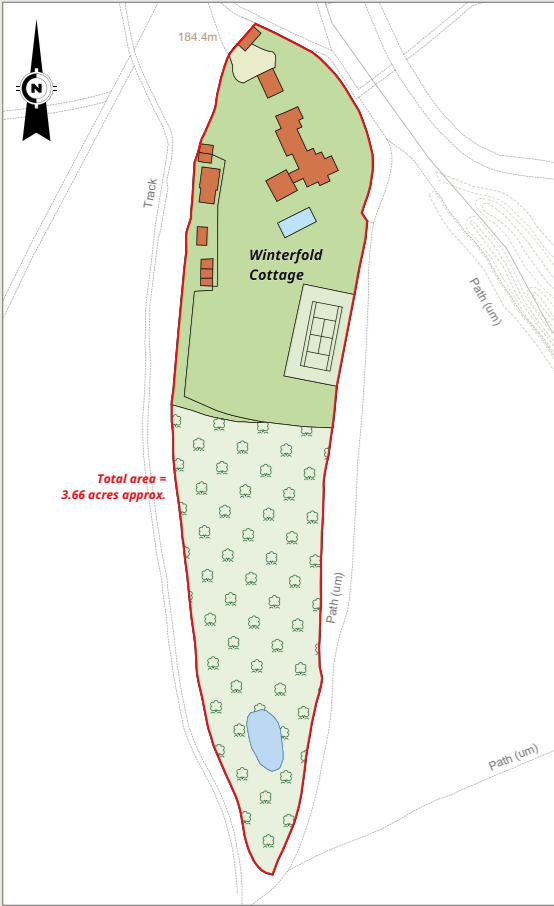

**Knight Frank Guildford**

2-3 Eastgate Court

High Street, Guildford

GU1 3DE

Knight Frank Country Department

55 Baker Street

London

W1U 8AN

Knight Frank Farms & Estates

55 Baker Street

London

W1U 8AN

Morten Boardman

01483 617930

morten.boardman@knightfrank.com

Julia Meadowcroft

020 7861 5390

julia.meadowcroft@knightfrank.com

Will Oakes

020 3750 3267

will.oakes@knightfrank.com

Will Matthews

020 7861 1440

will.matthews@knightfrank.com

knightfrank.co.uk

Important Notice: 1. Particulars: These particulars are not an offer or contract, nor part of one. You should not rely on statements given by Knight Frank in the particulars, by word of mouth or in writing ("information") as being factually accurate about the property, its condition or its value. Neither Knight Frank nor any joint agent has any authority to make any representations about the property, and accordingly any information given is entirely without responsibility on the part of Knight Frank. 2. Material Information: Please note that the material information is provided to Knight Frank by third parties and is provided here as a guide only. While Knight Frank has taken steps to verify this information, we advise you to confirm the details of any such material information prior to any offer being submitted. If we are informed of changes to this information by the seller or another third party, we will use reasonable endeavours to update this as soon as practical. 3. Photos, Videos etc: The photographs, property videos and virtual viewings etc. show only certain parts of the property as they appeared at the time they were taken. Areas, measurements and distances given are approximate only. 4. Regulations etc: Any reference to alterations to, or use of, any part of the property does not mean that any necessary planning, building regulations or other consent has been obtained. A buyer must find out by inspection or in other ways that these matters have been properly dealt with and that all information is correct. 5. Fixtures and fittings: A list of the fitted carpets, curtains, light fittings and other items fixed to the property which are included in the sale (or may be available by separate negotiation) will be provided by the Seller's Solicitors. 6. VAT: The VAT position relating to the property may change without notice. 7. To find out how we process Personal Data, please refer to our Group Privacy Statement and other notices at <https://www.knightfrank.com/legals/privacy-statement>.

Particulars dated May 2025. Photographs and videos dated April 2025. All information is correct at the time of going to print. Knight Frank is the trading name of Knight Frank LLP. Knight Frank LLP is a limited liability partnership registered in England and Wales with registered number OC305934. Our registered office is at 55 Baker Street, London W1U 8AN. We use the term 'partner' to refer to a member of Knight Frank LLP, or an employee or consultant. A list of members names of Knight Frank LLP may be inspected at our registered office. If you do not want us to contact you further about our services then please contact us by either calling 020 3544 0692, email to marketing.help@knightfrank.com or post to our UK Residential Marketing Manager at our registered office (above) providing your name and address. Brochure by wordperfectprint.com