



## THE OLD FARM HOUSE, HAZELEY BOTTOM

Hampshire RG27 8LU





# AN ELEGANT FAMILY HOME WITH A RURAL OUTLOOK & POSITION

This elegant family home enjoys a peaceful rural setting with beautiful countryside views. Grade II listed, it blends character and charm with spacious accommodation and wonderful gardens.



Local Authority: Hart District Council

Council Tax band: G

Tenure: Freehold

Services: Mains water and electricity. Private drainage. Oil fired central heating.





This elegant Grade II listed home enjoys a peaceful rural setting with countryside views, offering character, comfort, and beautifully maintained gardens. The welcoming entrance hall leads to a sitting room with a stone fireplace and log burner, a bright dining room, and a south-facing garden room with double doors to the garden. At the heart of the home is a family kitchen with island, AGA, garden access and adjoining utility, pantry and boot room. Between these rooms and the double garage is a cosy snug and study. Upstairs, all bedrooms overlook the gardens and are served by two bathrooms. Planning permission is in place for a new entrance hall and first-floor extension (Planning Ref:12/01324/HOU) should a purchaser wish for more space. The home includes eaves storage, an attached double garage, garden store, and wood storage. A gravel driveway, mature trees, and hedgerows provide privacy. The south-facing garden features a terrace, lawn, arbour, paddock, field shelter, chicken run, and vegetable garden.













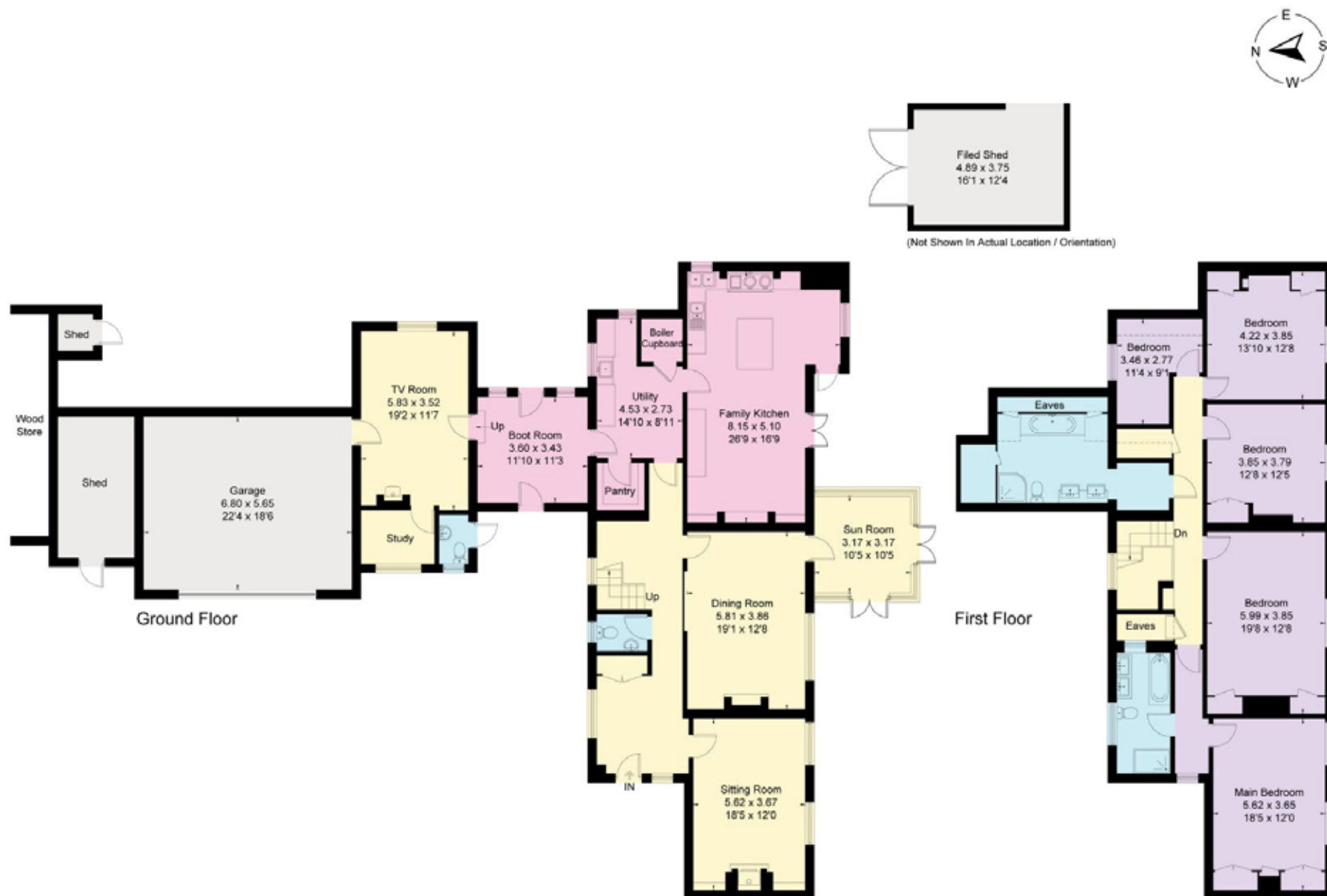

House Approximate Gross Internal Area = 313.3 sq m / 3,372 sq ft  
 Outbuildings Approximate Gross Internal Area = 51.4 sq m / 553 sq ft  
 Total Approximate Gross Internal Area = 364.7 sq m / 3,925 sq ft

This plan is for layout guidance only. Not drawn to scale unless stated. Windows and door openings are approximate. Whilst every care is taken in the preparation of this plan, please check all dimensions, shapes and compass bearings before making any decisions reliant upon them. (ID767266)

We would be delighted  
to tell you more.

**Clive Moon**

+44 125 663 0976

clive.moon@knightfrank.com

**Knight Frank North Hampshire**

Matrix House, Basing View, Basingstoke, RG21 4FF

**Laura Read**

+44 1256 630978

laura.read@knightfrank.com

**knightfrank.co.uk**

Your partners in property

1. Particulars: These particulars are not an offer or contract, nor part of one. You should not rely on statements given by Knight Frank in the particulars, by word of mouth or in writing ("information") as being factually accurate about the property, its condition or its value. Neither Knight Frank nor any joint agent has any authority to make any representations about the property, and accordingly any information given is entirely without responsibility on the part of Knight Frank. 2. Material Information: Please note that the material information is provided to Knight Frank by third parties and is provided here as a guide only. While Knight Frank has taken steps to verify this information, we advise you to confirm the details of any such material information prior to any offer being submitted. If we are informed of changes to this information by the seller or another third party, we will use reasonable endeavours to update this as soon as practical. 3. Photos, Videos etc: The photographs, property videos and virtual viewings etc. show only certain parts of the property as they appeared at the time they were taken. Areas, measurements and distances given are approximate only. 4. Regulations etc: Any reference to alterations to, or use of, any part of the property does not mean that any necessary planning, building regulations or other consent has been obtained. A buyer must find out by inspection or in other ways that these matters have been properly dealt with and that all information is correct. 5. Fixtures and fittings: A list of the fitted carpets, curtains, light fittings and other items fixed to the property which are included in the sale (or may be available by separate negotiation) will be provided by the Seller's Solicitors. 6. VAT: The VAT position relating to the property may change without notice. 7. To find out how we process Personal Data, please refer to our Group Privacy Statement and other notices at <https://www.knightfrank.com/legals/privacy-statement>.

Particulars dated April 2025. Photographs and videos dated April 2025. All information is correct at the time of going to print. Knight Frank is the trading name of Knight Frank LLP. Knight Frank LLP is a limited liability partnership registered in England and Wales with registered number OC305934. Our registered office is at 55 Baker Street, London W1U 8AN. We use the term 'partner' to refer to a member of Knight Frank LLP, or an employee or consultant. A list of members names of Knight Frank LLP may be inspected at our registered office. If you do not want us to contact you further about our services then please contact us by either calling 020 3544 0692, email to [marketing.help@knightfrank.com](mailto:marketing.help@knightfrank.com) or post to our UK Residential Marketing Manager at our registered office (above) providing your name and address.