



CONON HOUSE

Curdridge, Hampshire



CONON HOUSE CURDRIDGE

An impressive, detached period home set within a large garden. With spacious and light accommodation, the house is a wonderful opportunity to create a comfortable family home.

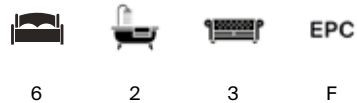

Local Authority: Winchester

Council Tax band: G

Tenure: Freehold

Guide Price: £1,500,000



CONON HOUSE, CHURCH LANE, CURDRIDGE

Consisting of over 4,300 sq ft, this elegant home sits within the delightful village of Curdridge, just 0.6 miles from Botley station and close to Curdridge Primary School. With generous gardens extending south and west, and with plenty of parking, the house is approached via a shared gravel drive. The property has been in the same family since 1973 and although it would benefit from some updating, the beautiful proportions of the house are an attractive prospect. Plenty of original features remain including fire surrounds, stained glass and sash windows. The principal reception rooms enjoy the west-facing aspect with views over the garden and raised terrace which runs alongside the house. Four double bedrooms and family bathroom are on the first floor, with a further two double bedrooms and bathroom on the second. (Times and distances are approximate).







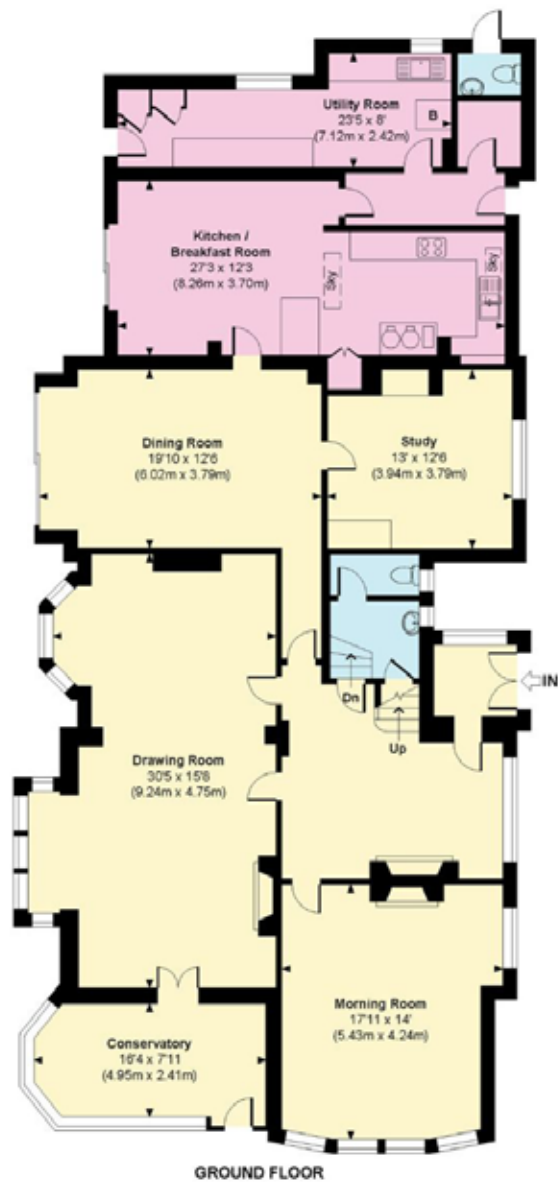

Conon House

Approximate Gross Internal Area

Main House = 4387 Sq Ft / 407.52 Sq M

Garage / Store = 523 Sq Ft / 48.63 Sq M

Total = 4910 Sq Ft / 456.15 Sq M

Outbuildings are not shown in correct orientation or location.
Includes areas with restricted room height but excludes void.

This plan is for layout guidance only. Not drawn to scale unless stated. Windows and door openings are approximate. Whilst every care is taken in the preparation of this plan, please check all dimensions, shapes and compass bearings before making any decisions reliant upon them. (ID767266)

We would be delighted
to tell you more.

Ed Hunt
01962 677236
edward.hunt@knightfrank.com

Knight Frank Winchester
14 Jewry Street, Winchester
SO23 8RZ

Lottie Lambert
01962 677246
lottie.lambert@knightfrank.com

knightfrank.co.uk

Your partners in property

1. Particulars: These particulars are not an offer or contract, nor part of one. You should not rely on statements given by Knight Frank in the particulars, by word of mouth or in writing ("information") as being factually accurate about the property, its condition or its value. Neither Knight Frank nor any joint agent has any authority to make any representations about the property, and accordingly any information given is entirely without responsibility on the part of Knight Frank. 2. Material Information: Please note that the material information is provided to Knight Frank by third parties and is provided here as a guide only. While Knight Frank has taken steps to verify this information, we advise you to confirm the details of any such material information prior to any offer being submitted. If we are informed of changes to this information by the seller or another third party, we will use reasonable endeavours to update this as soon as practical. 3. Photos, Videos etc: The photographs, property videos and virtual viewings etc. show only certain parts of the property as they appeared at the time they were taken. Areas, measurements and distances given are approximate only. 4. Regulations etc: Any reference to alterations to, or use of, any part of the property does not mean that any necessary planning, building regulations or other consent has been obtained. A buyer must find out by inspection or in other ways that these matters have been properly dealt with and that all information is correct. 5. Fixtures and fittings: A list of the fitted carpets, curtains, light fittings and other items fixed to the property which are included in the sale (or may be available by separate negotiation) will be provided by the Seller's Solicitors. 6. VAT: The VAT position relating to the property may change without notice. 7. To find out how we process Personal Data, please refer to our Group Privacy Statement and other notices at <https://www.knightfrank.com/legals/privacy-statement>.

Particulars dated March 2025. Photographs dated March 2025. All information is correct at the time of going to print. Knight Frank is the trading name of Knight Frank LLP. Knight Frank LLP is a limited liability partnership registered in England and Wales with registered number OC305934. Our registered office is at 55 Baker Street, London W1U 8AN. We use the term 'partner' to refer to a member of Knight Frank LLP or an employee or consultant. A list of members names of Knight Frank LLP may be inspected at our registered office. If you do not want us to contact you further about our services then please contact us by either calling 020 3544 0692, email to marketing.help@knightfrank.com or post to our UK Residential Marketing Manager at our registered office (above) providing your name and address.