







CRUSOE COURT HOUSE

Lower Largo, East Neuk of Fife

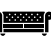

A STRIKING MODERN DETACHED HOME

With breathtaking views over the Firth of Forth

		
4	3	2
		EPC
		A

Local Authority: Fife Council
Council Tax band: G
Tenure: Freehold

Offers Over: £670,000





LOCATION

Nestled in the heart of the highly desirable East Neuk of Fife, the charming coastal village of Lower Largo offers a tranquil yet vibrant setting. Famed for its sandy beach, historic charm, and thriving arts scene, the village is a sought-after destination for those seeking a peaceful lifestyle with easy access to local amenities. Within walking distance, residents enjoy a hotel, pub, café, convenience store, and a host of cultural events, including the celebrated annual Arts Week. Primary schooling is available in nearby Lundin Links, which also features boutique shops and premier golf courses. The towns of Leven and Elie are just a few miles along the coast, offering a wider range of services, with St Andrews a 15 minute drive away. Ideally located just 3 miles from the new Leven Train Station, offering direct rail links into the heart of Edinburgh in an hour





FEATURES AND HIGHLIGHTS

- Exceptional detached home with uninterrupted views over the Firth of Forth
- Prime corner plot in exclusive private cul-de-sac development
- Contemporary open-plan layout with high-spec finishes throughout
- Four spacious double bedrooms & three luxurious bathrooms
- South-facing, fully enclosed garden with elevated glass-fronted deck
- Integral garage with electric door and mono-block driveway
- 11 solar panels and underfloor heating throughout the ground floor
- Completed in 2022 with remainder of 10-year new-build warranty

THE PROPERTY

Positioned to take full advantage of its breathtaking coastal outlook, 1 Crusoe Court is a striking modern detached home, completed in 2022 and presented in immaculate, show home condition. Set over two generous levels, the property offers thoughtfully designed contemporary living with high-spec finishes throughout.

A dramatic double-height entrance hall welcomes you into the home, leading to a stunning open-plan lounge and designer kitchen with floor-to-ceiling bi-fold doors opening onto an expansive, sea-facing deck. West-facing windows further enhance the natural light, creating a bright, airy living space throughout the day.

The sleek kitchen features a full range of integrated appliances, including an eye-level oven, Quooker tap, downdraft induction hob, and discreet storage solutions. A central island with breakfast bar provides the ideal social hub, while a well-equipped utility room offers access to the garden, deck, garage, and Jack & Jill shower room.





A second reception room offers versatility as a formal dining space or family lounge, also opening to the rear garden via bi-fold doors. A spacious double bedroom with fitted wardrobes and access to the Jack & Jill shower room completes the ground floor—perfect for guests or flexible living arrangements.

Upstairs, the principal suite boasts stunning views through a bay dormer window, a dressing room, and a stylish en-suite with rainfall shower. Two further double bedrooms offer ample storage and coastal vistas, while the luxurious family bathroom features a free-standing bath and walk-in shower. There are two generous storage and airing cupboards off the landing.





The home is fitted with energy-efficient features, including 11 solar panels, EPC A-rating, and zoned underfloor heating across the ground floor. Bathrooms are fitted with motion-activated lighting, vanity storage units with heated illuminated mirrors and the property benefits from the remainder of a 10-year new-build warranty.

Set on a generous corner plot, the property boasts manicured outdoor living as well as a wraparound composite deck with glass balustrade, that perfectly complement the home's interior elegance. A mono-block driveway for two vehicles leads to the integral garage, which is accessed via a remote electric door and benefits from internal lighting, power, water tap and a switch-operated street lamp unique to each home in the development.



- Reception
- Bedroom
- Bathroom
- Kitchen/Utility
- Storage
- Outside

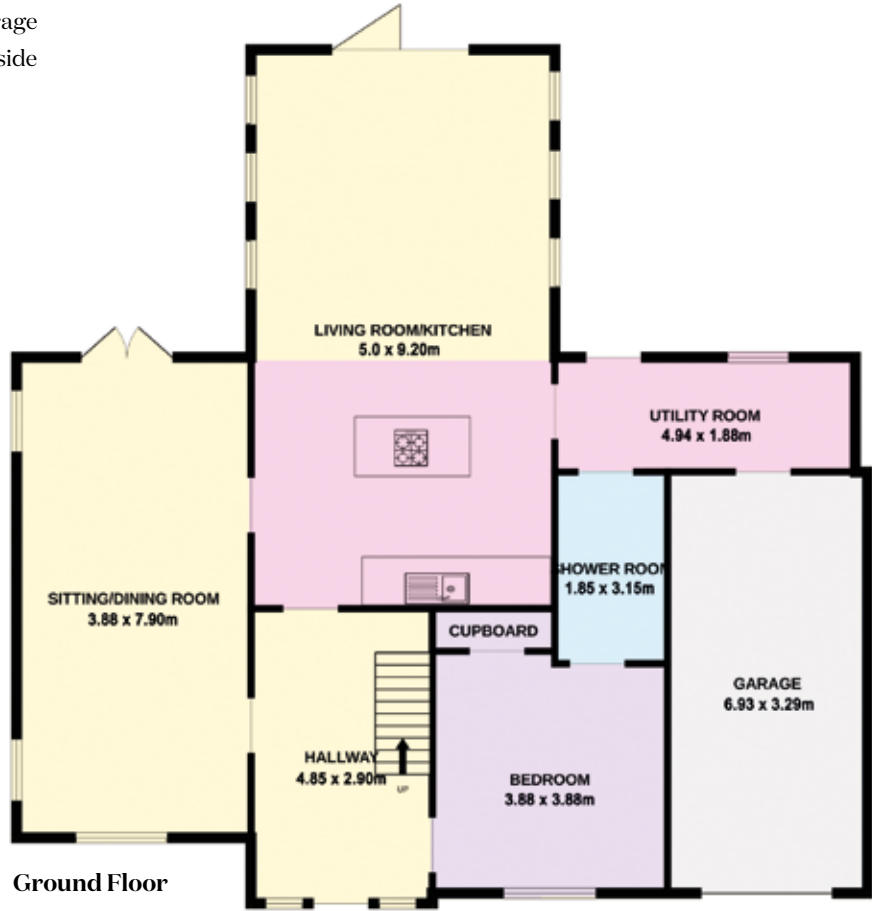

Approximate Gross Internal Area = 248sq m / 2,669 sqft
(Including Garage - 271 sqm / 2,917 sqft)

This plan is for layout guidance only. Not drawn to scale unless stated. Windows and door openings are approximate. Whilst every care is taken in the preparation of this plan, please check all dimensions, shapes and compass bearings before making any decisions reliant upon them.



Financial Guarantee/Anti Money Laundering: All offers to purchase the property (regardless of whether the offer is on a cash basis or subject to loan funding) must be accompanied with evidence of Source of Funds. This can be in the form of a bank statement showing the purchase price, a financial reference from a bank/funding source, or confirmation from a solicitor that the purchaser has sufficient funds to complete the purchase. In addition, the purchaser must supply certified copies of his/her passport and confirmation of residence in terms acceptable under anti money laundering (AML) legislation. These documents will be required for all individuals who will appear on the title once the transaction is complete.

We would be delighted
to tell you more.

Rosi Dow

0131 222 9600

rosi.dow@knightfrank.com

Knight Frank Edinburgh

80 Queen Street, Edinburgh

EH2 4NF

Neil Scott

0131 222 9600

neil.scott@knightfrank.com

Malcolm Pickard

0131 322 3464

malcolm.pickard@knightfrank.com

[knightfrank.co.uk](https://www.knightfrank.co.uk)

Your partners in property

Important Notice: 1. Particulars: These particulars are not an offer or contract, nor part of one. You should not rely on statements given by KF Scotland Ltd., in the particulars, by word of mouth or in writing ("information") as being factually accurate about the property, its condition or its value. Neither KF Scotland Ltd, nor any joint agent has any authority to make any representations about the property, and accordingly any information given is entirely without responsibility on the part of KF Scotland Ltd. 2. Material Information: Please note that the material information is provided to KF Scotland Ltd, by third parties and is provided here as a guide only. While KF Scotland Ltd, has taken steps to verify this information, we advise you to confirm the details of any such material information prior to any offer being submitted. If we are informed of changes to this information by the seller or another third party, we will use reasonable endeavours to update this as soon as practical. 3. Photos, Videos etc: The photographs, property videos and virtual viewings etc. show only certain parts of the property as they appeared at the time they were taken. Areas, measurements and distances given are approximate only. 4. Regulations etc: Any reference to alterations to, or use of, any part of the property does not mean that any necessary planning, building regulations or other consent has been obtained. A buyer must find out by inspection or in other ways that these matters have been properly dealt with and that all information is correct. 5. Fixtures and fittings: A list of the fitted carpets, curtains, light fittings and other items fixed to the property which are included in the sale (or may be available by separate negotiation) will be provided by the Seller's Solicitors. 6. VAT: The VAT position relating to the property may change without notice. 7. To find out how we process Personal Data, please refer to our Group Privacy Statement and other notices at <https://www.knightfrank.com/legals/privacy-statement>.

Particulars dated April 2025. Photographs and videos dated April 2025. All information is correct at the time of going to print. KF Scotland Ltd is a limited company registered in Scotland with registered number 120/NE78008. Our registered office is 41 Charlotte Square, Edinburgh, EH2 4HQ. KF Scotland Limited is an independently owned member of the Knight Frank Network operating under licence from Knight Frank LLP.