



## HORNBEAM PADDOCKS

Wolverton Fields, Norton Lindsey, Warwick





# A WONDERFUL EQUESTRIAN OPPORTUNITY IN A DESIRABLE VILLAGE CLOSE TO WARWICK, IN 7.60 ACRES

Hornbeam Paddocks is situated in Wolverton Fields,  
on the edge of Norton Lindsey.

**Distances:** M40 (J15) 3 miles, Warwick Parkway Station 3 miles (London Marylebone from 75 mins), Warwick 4 miles  
Stratford-upon-Avon 5 miles, Birmingham 20 miles, Birmingham International Airport 24 miles  
(All distances and times approximate).

Local Authority: Stratford on Avon District Council 01789 292522

Tenure: Freehold





## SITUATION

The village features a primary school, New Inn public house, village hall and church. The neighbouring village of Snitterfield is approximately 2 miles away and has a local village shop for everyday requirements and public house. There are more extensive shopping and recreational facilities in the nearby towns of Warwick, Leamington Spa and Stratfordupon- Avon.

The area has an excellent range of state, private and grammar schools, including Stratford Prep School and The Croft Prep School in Stratford-upon-Avon. Warwick Prep School and Public School and King's High School for Girls in Warwick and in Leamington Spa, Kingsley School for Girls and Arnold Lodge.

## DESCRIPTION

Hornbeam Paddocks is an excellent equestrian smallholding in a popular village, accessed via a stoned road which leads to the entrance of the yard. This peaceful and private site has all the facilities you would require with the benefit of the village amenities within walking distance.





This private site is located within close proximity to major motorway networks and equestrian facilities such as Solihull Riding Club, Swallowfield Equestrian and Moreton Morrell College.

There are four stables, including one foaling box and three further stables all with internal and external lighting and external electrical sockets. There is a securely fenced yard which consists of a tack room, stables, barn storage and feed room. There is an outside water tap on the yard, in the tack room and a further water tap in the front paddock. The land totals 7.6 acres with six field shelters, with all paddocks having access to self-filling water troughs.

There is a 40x20m all-weather manège topped with Flexiride® surface with surround lighting and drainage. Please note that the day cabin is not included in the sale and will be removed before completion. The touring and static caravans are no longer on site and do not form part of the sale.

There are two wooden field shelters; one is fitted with a utility containing cold water supply, WC shower, and and double level cold waterpond. There is solar PIR lighting throughout and a hardcore parking area for vehicles.

There is a public footpath to the far right-hand side of the land, which is identified on the boundary plan and included within the boundary.

## PROPERTY INFORMATION

**Postcode:** CV35 9JN

**What3words:** // /ivory.insect.settle

**Services:** Mains water, electricity and telephone landline/internet.Drainage is septic tank.

**Viewings:** By prior appointment only with the agents.

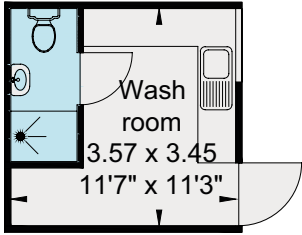
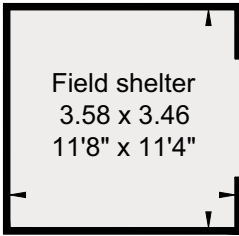
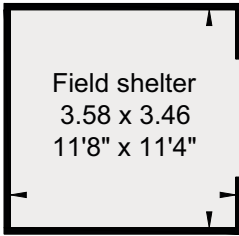
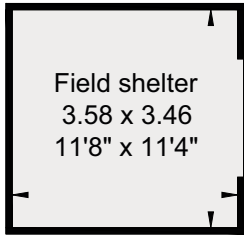
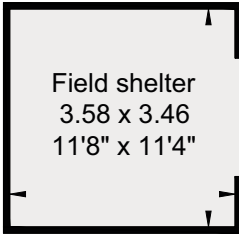
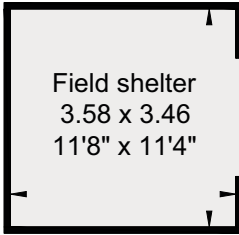
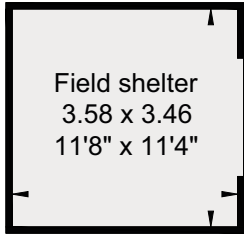
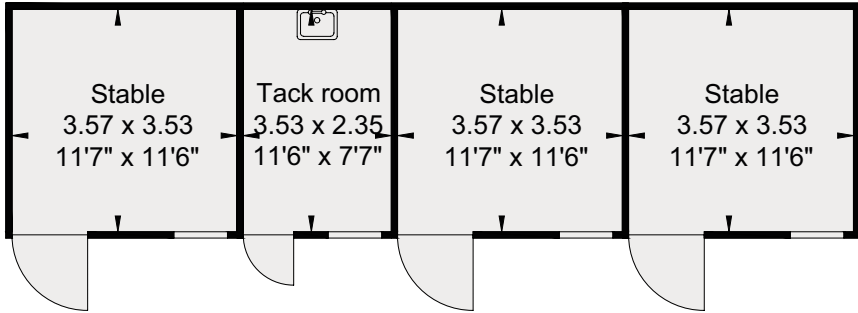
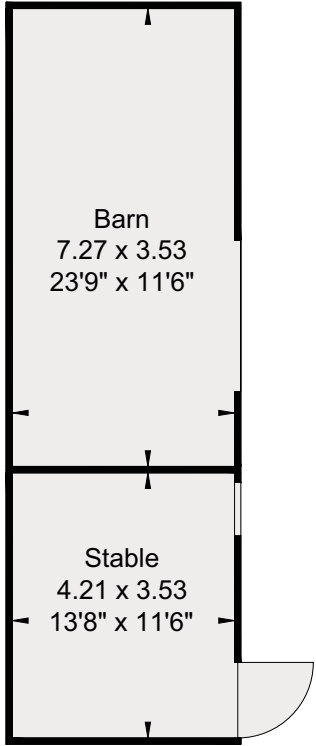

Outbuildings

Not shown in  
actual location /  
orientation



- Reception
- Bedroom
- Bathroom
- Kitchen/Utility
- Storage
- Outside

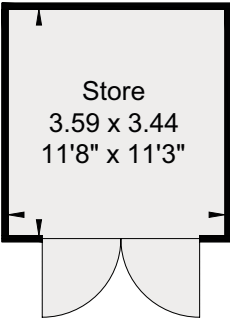

Approximate Gross Internal Area = 188 sq m / 2,024 sq ft

This plan is for layout guidance only. Not drawn to scale unless stated. Windows and door openings are approximate. Whilst every care is taken in the preparation of this plan, please check all dimensions, shapes and compass bearings before making any decisions reliant upon them.

I would be delighted  
to tell you more.

**Samantha Bysouth**

01789 297735

samantha.bysouth@knightfrank.com

**Knight Frank Stratford-upon-Avon**

Bridgeway House, Bridgeway, Stratford-upon-Avon

Warwickshire, CV37 6YX

knightfrank.co.uk

Your partners in property

1. Particulars: These particulars are not an offer or contract, nor part of one. You should not rely on statements given by Knight Frank in the particulars, by word of mouth or in writing ("information") as being factually accurate about the property, its condition or its value. Neither Knight Frank nor any joint agent has any authority to make any representations about the property, and accordingly any information given is entirely without responsibility on the part of Knight Frank. 2. Material Information: Please note that the material information is provided to Knight Frank by third parties and is provided here as a guide only. While Knight Frank has taken steps to verify this information, we advise you to confirm the details of any such material information prior to any offer being submitted. If we are informed of changes to this information by the seller or another third party, we will use reasonable endeavours to update this as soon as practical. 3. Photos, Videos etc: The photographs, property videos and virtual viewings etc. show only certain parts of the property as they appeared at the time they were taken. Areas, measurements and distances given are approximate only. 4. Regulations etc: Any reference to alterations to, or use of, any part of the property does not mean that any necessary planning, building regulations or other consent has been obtained. A buyer must find out by inspection or in other ways that these matters have been properly dealt with and that all information is correct. 5. Fixtures and fittings: A list of the fitted carpets, curtains, light fittings and other items fixed to the property which are included in the sale (or may be available by separate negotiation) will be provided by the Seller's Solicitors. 6. VAT: The VAT position relating to the property may change without notice. 7. To find out how we process Personal Data, please refer to our Group Privacy Statement and other notices at <https://www.knightfrank.com/legals/privacy-statement>.

Particulars dated May 2025. Photographs and videos dated June 2024. All information is correct at the time of going to print. Knight Frank is the trading name of Knight Frank LLP. Knight Frank LLP is a limited liability partnership registered in England and Wales with registered number OC305934. Our registered office is at 55 Baker Street, London W1U 8AN. We use the term 'partner' to refer to a member of Knight Frank LLP, or an employee or consultant. A list of members names of Knight Frank LLP may be inspected at our registered office. If you do not want us to contact you further about our services then please contact us by either calling 020 3544 0692, email to [marketing.help@knightfrank.com](mailto:marketing.help@knightfrank.com) or post to our UK Residential Marketing Manager at our registered office (above) providing your name and address.

Date: 09 May 2025  
Our reference: STR012385172

## Hornbeam Paddocks, Wolverton Fields, Norton Lindsey, Warwick, CV35 8JN

We have pleasure in enclosing details of the above property for which we are quoting offers in excess of £500,000.

Please let us know if you need any further information about the property or surrounding area and we will be delighted to provide it.

Full details of all our properties and a wide range of services can be viewed online at [knightfrank.co.uk](https://knightfrank.co.uk). You can also receive early information on new properties coming on to the market by signing up to [My Knight Frank](#).

For additional information or to make arrangements to view the property, please get in touch.



### KNIGHT FRANK LLP

**Samantha Bysouth**  
Associate  
+44 1789 206 953  
[samantha.bysouth@knightfrank.com](mailto:samantha.bysouth@knightfrank.com)

**Knight Frank, Stratford**  
Bridgeway House, Bridgeway, Stratford upon Avon, CV37 6YX  
+44 1789 297 735

**[knightfrank.co.uk](https://knightfrank.co.uk)**

Your partners in property

Knight Frank LLP is a limited liability partnership registered in England and Wales with registered number OC305934. Our registered office is at 55 Baker Street, London W1U 8AN. We use the term 'partner' to refer to a member of Knight Frank LLP, or an employee or consultant. A list of members' names of Knight Frank LLP may be inspected at our registered office.

Regulated by RICS

V4.3 Sep 24