



The Coach House
Frankton Manor, Frankton, Rugby, Warwickshire





A **unique opportunity** to purchase a beautifully presented, detached property on the Frankton Manor Estate, with a private garden and stunning views to the church and open countryside beyond.

Summary of accommodation

Entrance hall | Kitchen/breakfast room | Playroom/study | Sitting room | WC

Principal bedroom with en suite bathroom | Two further double bedrooms | Family bathroom

Garage | Garden store | Garden | Driveway with private parking

Distances

Rugby 6 miles, Leamington Spa 7 miles, Banbury 22 miles, Birmingham 22 miles, London 88 miles

(All distances and times are approximate)



Knight Frank Stratford-upon-Avon
Bridgeway
Stratford-upon-Avon
CV37 6YX
[knightfrank.co.uk](https://www.knightfrank.co.uk)

James Way
01789 297735
james.way@knightfrank.com

Situation

The Coach House is situated on the Frankton Manor Estate and is accessed by a right of way over a private driveway with ample parking. The property is well located for access to the motorway network bringing Birmingham, Coventry, Leicester, Northampton, Milton Keynes and Oxford all within easy daily reach. Rugby offers a direct rail service to London Euston, taking approximately 58 minutes, and Leamington Spa offers a direct rail service to London Marylebone, London Euston and London Paddington, all taking approximately 1 hour 25 minutes.

There is an excellent range of state, private and grammar schools in the area including Rugby High School for Girls, Lawrence Sheriff Grammar School, Bilton Grange Prep School, Rugby Public School in Rugby, Princethorpe College Public School, Arnold Lodge School, Kingsley School for Girls in Leamington Spa and Warwick Prep and Public School and Kings High School for Girls in Warwick. Southam College was rated outstanding in its most recent Ofsted Report (September 2021).

There are several local golf courses in the area including Whitefields at Thurlaston and Leamington. Sailing and fishing can be found at Draycote Water, and the surrounding area is excellent for riding and walking. The property is well positioned for access to a wide range of equestrian activities. There is racing at Warwick (12 miles) and Stratford (18 miles) and polo at Southam and Rugby.





The property

Situated in the beautiful village of Frankton, The Coach House offers the perfect home for those looking for a countryside lifestyle. It is a detached property constructed of red brick that offers a blend of character and modern comfort.

The front door enters to a light and airy entrance hall that opens up into the spacious, dual-aspect kitchen/breakfast room, which is complete with an AGA, fitted units, integral dishwasher, central island, and stunning easterly and westerly views of the garden and the driveway that bathe the room with natural light. From the entrance hall you can also enter the generous dining room/playroom/study, with a door leading to a cloakroom and a large window providing a beautiful outlook of the garden. The ground floor further extends to an elegant, dual-aspect sitting room, with a working open fireplace, exposed timber beams and French doors leading to a patio area and the garden beyond.

Stairs in the entrance hall rise to a spacious first-floor landing leading to the principal suite, comprising an expansive principal bedroom with three windows providing westerly views to the driveway and easterly views to the garden, an en suite bathroom with fitted bath and separate shower unit and extensive built-in wardrobes.





The first floor offers two further generous bedrooms and while both have views of the Coach House garden, the very large one has a second aspect looking out across the manor house's lawns towards pretty, wooded countryside beyond.

In addition to the living accommodation, the property benefits from a gravel driveway that provides ample parking for multiple cars, a large garage and a double storey garden room with the potential to be converted into further living space. The grounds comprise a secluded and peaceful lawned garden with a scattering of mature trees, a patio area and a stone-paved path that follows the perimeter of the property to provide access to the side and rear. There is also a further path and gate leading out at the back of the garden onto a path to the medieval church of St Nicholas.

Services

Mains gas, electricity, water and drainage are connected to the property.

Directions (CV23 9PJ)

From junction 17 of the M1, take the M45 to the end. Continue in a westward direction on the A45 for about a third of a mile and fork left onto the B4453.



After about 1 mile proceed past the sign to Bourton and Frankton and take the next left, signposted to Frankton. On the edge of the village at a small crossroads, turn right down a 'no through' road and then take the first driveway on the left to The Coach House.

Alternatively, from the M40 leave at junction 11 and travel northwards on the A423 signed Southam and Coventry. Just under 6 miles after leaving Southam, turn right onto the B4453 and take the first right signed Frankton. On the edge of the village at the crossroads, turn right down a 'no through' road and then take the first driveway on the left to The Coach House.

Wayleaves, Easements and Rights of Way

The property will be sold subject to and with the benefit of all wayleaves, easements and rights of way whether mentioned in these particulars or not.

Viewing

By prior appointment only with the agents.

Property information

Tenure: Freehold

Local Authority: Rugby Borough Council: 01788 533533

Council Tax: Band D

EPC Rating: D



Approximate Gross Internal Floor Area
231 sq m (2,495 sq ft)
inc. Garage/Garden store

This plan is for guidance only and must not be relied upon as a statement of fact. Attention is drawn to the Important Notice on the last page of the text of the Particulars.

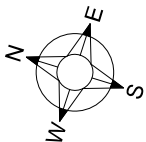

- Reception
- Bedroom
- Bathroom
- Kitchen/Utility
- Storage
- Outside

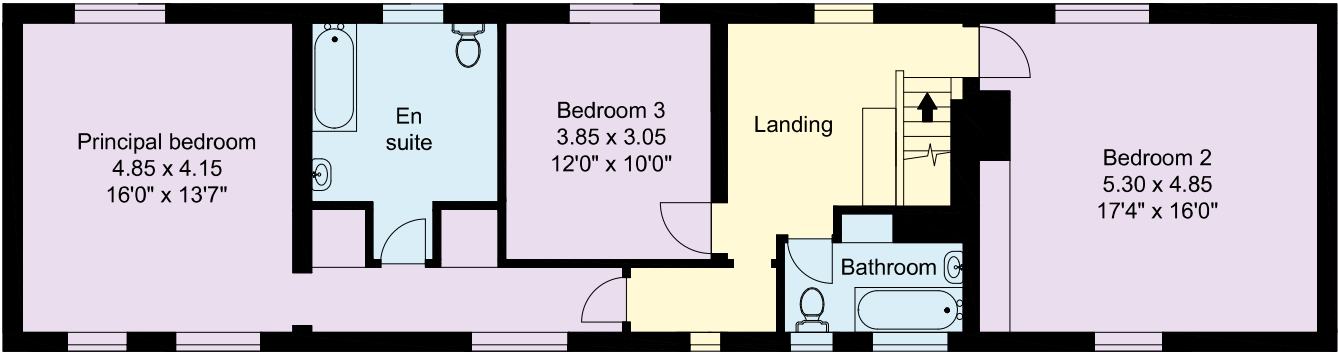

First Floor

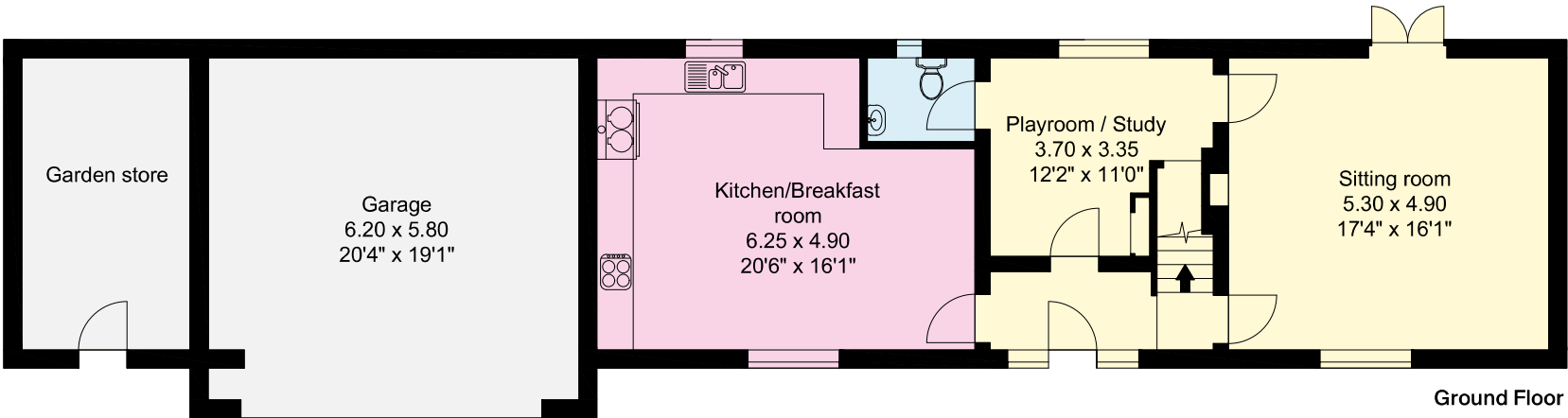

Ground Floor



Fixtures and fittings: A list of the fitted carpets, curtains, light fittings and other items fixed to the property which are included in the sale (or may be available by separate negotiation) will be provided by the Seller's Solicitors.

Important Notice: 1. Particulars: These particulars are not an offer or contract, nor part of one. You should not rely on statements by Knight Frank LLP in the particulars or by word of mouth or in writing ("information") as being factually accurate about the property, its condition or its value. Neither Knight Frank LLP nor any joint agent has any authority to make any representations about the property, and accordingly any information given is entirely without responsibility on the part of the agents, seller(s) or lessor(s). 2. Photos, Videos etc: The photographs, property videos and virtual viewings etc. show only certain parts of the property as they appeared at the time they were taken. Areas, measurements and distances given are approximate only. 3. Regulations etc: Any reference to alterations to, or use of, any part of the property does not mean that any necessary planning, building regulations or other consent has been obtained. A buyer or lessee must find out by inspection or in other ways that these matters have been properly dealt with and that all information is correct. 4. VAT: The VAT position relating to the property may change without notice. 5. To find out how we process Personal Data, please refer to our Group Privacy Statement and other notices at <https://www.knightfrank.com/legal/privacy-statement>.

Particulars dated February 2025. Photographs and videos dated December 2024.

All information is correct at the time of going to print. Knight Frank is the trading name of Knight Frank LLP. Knight Frank LLP is a limited liability partnership registered in England and Wales with registered number OC305934. Our registered office is at 55 Baker Street, London W1U 8AN. We use the term 'partner' to refer to a member of Knight Frank LLP, or an employee or consultant. A list of members names of Knight Frank LLP may be inspected at our registered office. If you do not want us to contact you further about our services then please contact us by either calling 020 3544 0692, email to marketing.help@knightfrank.com or post to our UK Residential Marketing Manager at our registered office (above) providing your name and address. Brochure by wordperfectprint.com

Date: 23 April 2025
Our reference: STR012492592

The Coach House, Frankton Manor, Frankton, Rugby, CV23 9PJ

We have pleasure in enclosing details of the above property for which we are quoting a guide price of offers in excess of **£650,000**.

Please let us know if you need any further information about the property or surrounding area and we will be delighted to provide it.

Full details of all our properties and a wide range of services can be viewed online at knightfrank.co.uk. You can also receive early information on new properties coming on to the market by signing up to [My Knight Frank](#).

For additional information or to make arrangements to view the property, please get in touch.

We'd love to help you.

Yours faithfully



KNIGHT FRANK LLP

Enc:

James Way
Partner, Head of Midlands Sales
+44 1789 206 950
james.way@knightfrank.com

Evey Hadley
Negotiator
+44 1789 206964
evey.hadley@knightfrank.com

Knight Frank, Stratford
Bridgeway House, Bridgeway, Stratford upon Avon, CV37 6YX
+44 1789 297 735

knightfrank.co.uk

Knight Frank LLP is a limited liability partnership registered in England and Wales with registered number OC305934. Our registered office is at 55 Baker Street, London W1U 8AN. We use the term 'partner' to refer to a member of Knight Frank LLP, or an employee or consultant. A list of members' names of Knight Frank LLP may be inspected at our registered office.

Regulated by RICS

Your partners in property

V4.3 Sep 24