



Agatha Christie Way, Cholsey, Oxfordshire
Share of Leasehold £210,000

JAMESGESNER
- ESTATE AGENTS -

Offered for sale as a shared ownership is this rare opportunity to buy a beautifully presented semi-detached home with larger than average rear garden and driveway parking for two cars. Set on this small development close to both the train station and local shops.

Accommodation comprises three bedrooms and two bathrooms on the first floor. The ground floor has a welcoming entrance hall, kitchen/breakfast room, living room/dining room with French doors to the garden and a cloakroom. The garden has been attractively landscaped with a patio area and an established lawn with planted borders and a garden shed. There is driveway parking to the front for two cars and gated access to the rear. The monthly payment payable to the housing association is £614.05 which is made up of up of £572.43 rent, £26.23 lease fee and £15.40 insurance.



36 Agatha Christie Way, Cholsey, Oxfordshire, OX11 9RS

GROUND FLOOR
469 sq.ft. (43.6 sq.m.) approx.

1ST FLOOR
469 sq.ft. (43.6 sq.m.) approx.

Energy Efficiency Rating	
Very energy efficient - lower running costs	
A	96
B	84
C	
D	
E	
F	
G	
Not energy efficient - higher running costs	
England & Wales	EU Directive 2002/91/EC

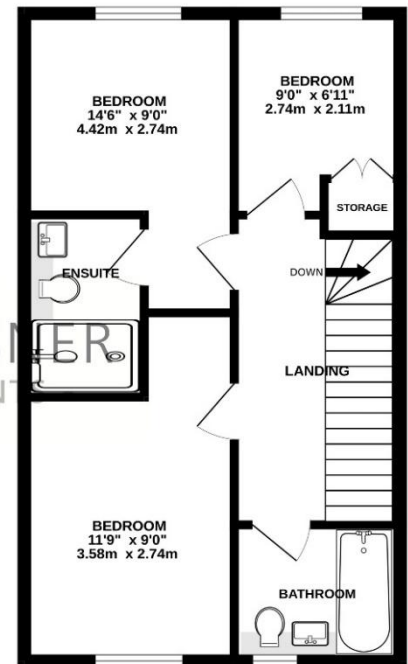
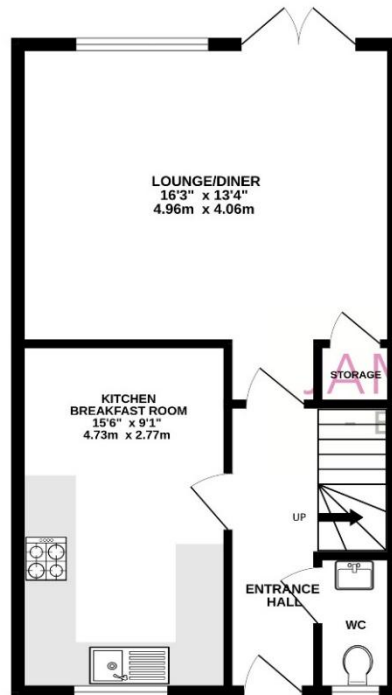

TOTAL FLOOR AREA : 938 sq.ft. (87.2 sq.m.) approx.

Whilst every attempt has been made to ensure the accuracy of the floorplan contained here, measurements of doors, windows, rooms and any other items are approximate and no responsibility is taken for any error, omission or mis-statement. This plan is for illustrative purposes only and should be used as such by any prospective purchaser. The services, systems and appliances shown have not been tested and no guarantee as to their operability or efficiency can be given.
Made with Metropix ©2025



James Gesner Estate Agents
72 Broadway Didcot, Oxon OX11 8AE
info@jamesgesner.co.uk

t: 01235 519888
t: 01491 522222

Important Notice: These particulars have been prepared for prospective purchasers only. They are not part of an offer or contract. Whilst some descriptions are obviously subjective and information is given in good faith, they should not be relied upon as statements or representations of fact. We have not tested any appliances which may be included in the sale, therefore any purchaser should seek clarification prior to exchange of contracts.